

FLYTE

FLTH21

Flyte Integrated Thermostatic and Volume Control Trim with Cross Handle



SHOWN IN FLYTE INTEGRATED THERMOSTATIC AND VOLUME CONTROL TRIM WITH CROSS HANDLE | FLTH21

TECHNICAL DETAILS

ADA Compliance: Yes
Number Of Holes: One Hole
Primary Material: Brass

INSPIRATION

Pure modernism expressed through masterful proportions and light, fluid forms. Like minimalist works of art, these designs bring sculptural reference to any space with graceful proportions and versatile finish options.

CODES & STANDARDS

ASME A112.18.1/CSA B125.1, State of MA

PRODUCT FEATURES

Features Cross Handle

Smooth handle operation controls water volume

A solid brass trim plate features engraved H and C markings

Stocked in Chrome, Nickel, Brass and Matte Black

Requires rough valve, sold separately: GUTH61 (USA) or GU61TH (UK/International)

CERTIFICATIONS



PRODUCT (NOTES)

FLYTE

FLTH21

Flyte Integrated Thermostatic and Volume Control Trim with Cross Handle

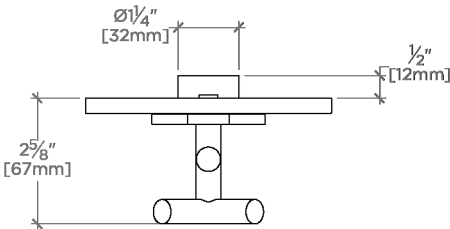

TOP VIEW SCALE: 3"=1'-0"

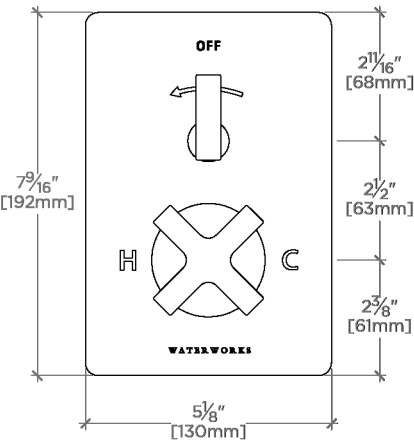

FRONT VIEW SCALE: 3"=1'-0"

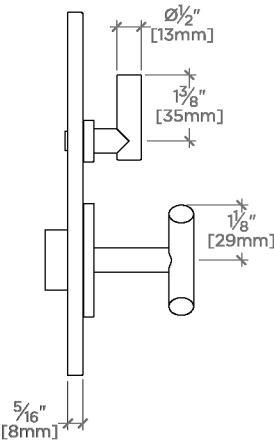

SIDE VIEW SCALE: 3"=1'-0"