

CENTURIA

CNCS08

Centuria Wall Mounted Marble Lavatory Sink 36" x 19 1/2" x 6"



SHOWN IN CENTURIA WALL MOUNTED MARBLE LAVATORY SINK 36" X 19 1/2" X 6" | CNCS08

TECHNICAL DETAILS

Depth To Overflow: 2.9"
 Drain Hole Depth: 1 7/8"
 Drain Hole Diameter: 1 3/4"
 Drain Style: Center Drain
 Fittings Hole Diameter: 1 3/8"
 Overflow Opening: Yes

INSPIRATION

Centuria presents a softer, more feminine interpretation of the classic stone sink. Inspired by our iconic Empire bathtub, the design features an elegant, rolled edge and forgoes a backsplash in favor of pure, sculptural form.

CODES & STANDARDS

PRODUCT FEATURES

Designed by and exclusive to Waterworks

Sourced and made in Italy

Carved from a solid block of stone. Packaged item weight: 240 lbs

Backsplash designed for wall mounted faucet and handles

Features an integrated overflow

CERTIFICATIONS

PRODUCT (NOTES)

CENTURIA

CNCS08

Centuria Wall Mounted Marble Lavatory Sink 36" x 19 1/2" x 6"

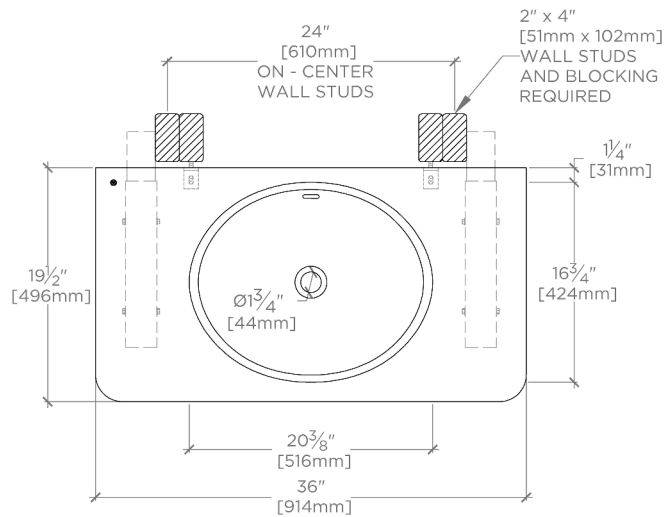

TOP VIEW

SCALE: 3/4"=1'-0"

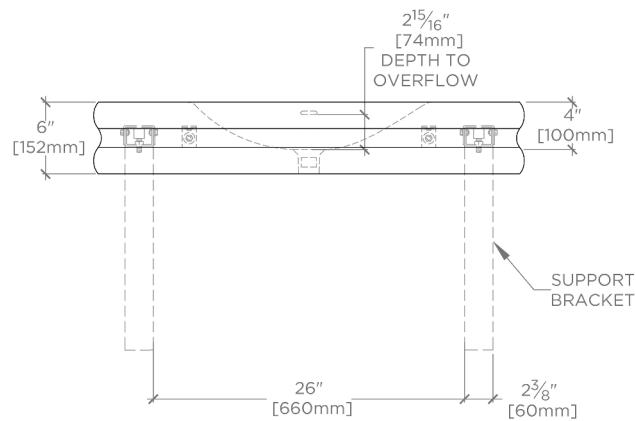

FRONT VIEW

SCALE: 3/4"=1'-0"

REQUIRED MOUNTING HARDWARE (SOLD SEPARATELY)

STYLE: 106801

DESCRIPTION: UNIVERSAL PAIR (L/R) 18" STAINLESS STEEL ADJUSTABLE CONCEALED SUPPORT BRACKETS, WALL SUPPORT BRACKETS AND HARDWARE FOR WALL MOUNTED STONE SINK.

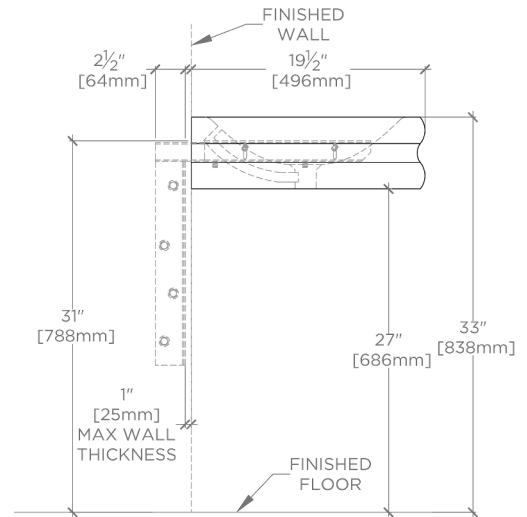

SIDE VIEW

SCALE: 3/4"=1'-0"