

HENRY CHRONOS

CN2P11

Henry Chronos Two Way Diverter Valve Trim for Pressure Balance with Roman Numerals and Lever Handle

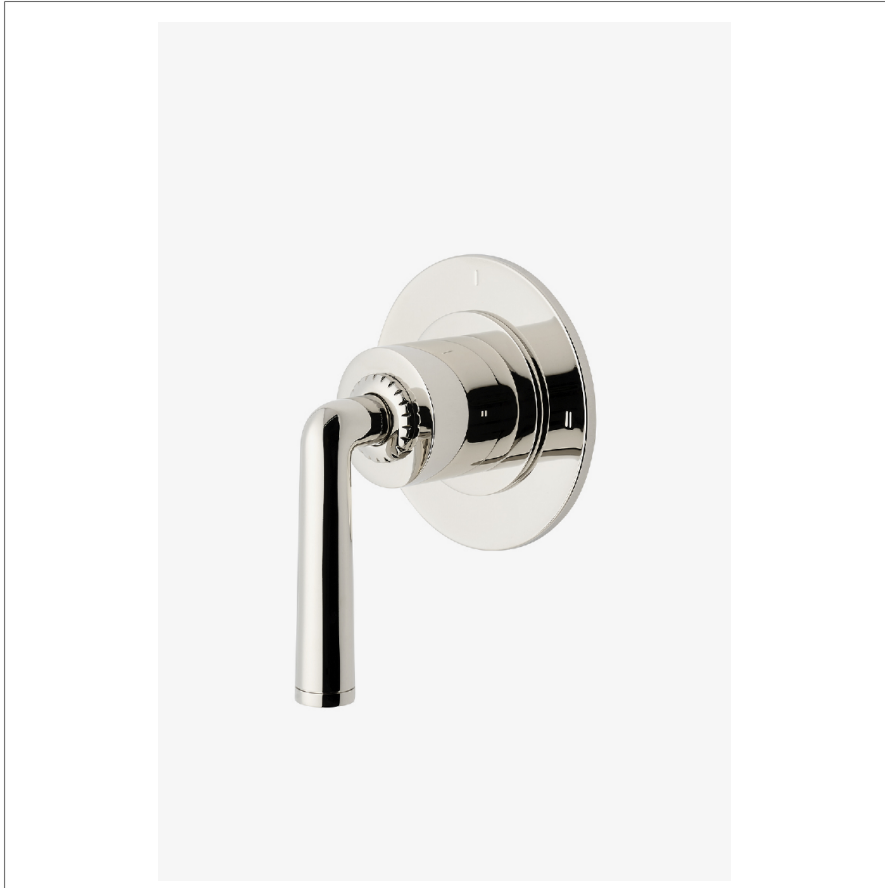

SHOWN IN HENRY CHRONOS TWO WAY DIVERTER VALVE TRIM FOR PRESSURE BALANCE WITH ROMAN NUMERALS AND LEVER HANDLE | CN2P11

TECHNICAL DETAILS

ADA Compliance: Yes
Fittings Hole Diameter: 2"
Handle Turn Angle: Quarter Turn
Number Of Holes: One Hole
Primary Material: Brass

INSPIRATION

Inspired by dive watches, Henry Chronos radiates design prowess and technical precision. Chronos retains the design integrity of our original, iconic Henry collection, while imbuing it with modern details and exquisite materials.

CODES & STANDARDS

ASME A112.18.1/CSA B125.1, State of MA

PRODUCT FEATURES

- Features All Metal Lever Handle
- For Use With a Pressure Balance Shower System and Two Waterway Outlets
- Features Roman Numerals Representing Outlet Position
- Stocked in Brass, Chrome and Nickel
- Requires valve rough sold separately

CERTIFICATIONS



PRODUCT (NOTES)

HENRY CHRONOS

CN2P11

Henry Chronos Two Way Diverter Valve Trim for Pressure
Balance with Roman Numerals and Lever Handle

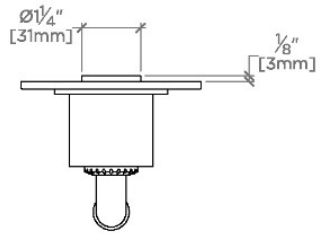

TOP VIEW SCALE: 3"=1'-0"

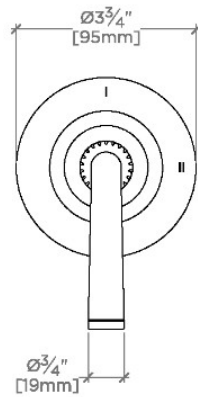

FRONT VIEW SCALE: 3"=1'-0"

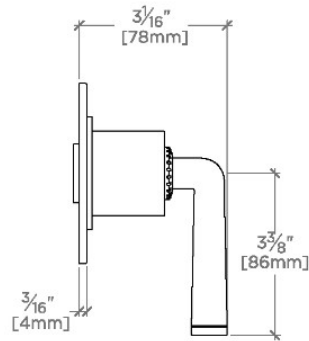

SIDE VIEW SCALE: 3"=1'-0"