

HENRY

HN03TW

230v Multi Rail Towel Warmer



SHOWN IN 230V MULTI RAIL TOWEL WARMER | HN03TW

TECHNICAL DETAILS

Depth/Width: 22.32"
Diameter Of Legs Tubes: 1 1/4"
Electric Requirements: 0.27A
Height: 22.32"
Length: 28.39"
Primary Material: Brass
Wet/Dry: Wet or Dry

INSPIRATION

Celebrating the connection of industry and art, Henry transitions effortlessly between modern, traditional, and classic settings. These iconic fittings blend 19th-century industrial and artistic references for a look that's forever of the moment—familiar yet wholly original.

CODES & STANDARDS

PRODUCT FEATURES

A standard in European hotels, an electric towel warmer is the ultimate in luxury

Made of brass

To best suit personal comfort level, we recommend installation with a dimmer switch.

Designed to warm and dry towels.

Stocked in Brass, Chrome, Nickel and Dark Nickel

CERTIFICATIONS

PRODUCT (NOTES)

230v Multi Rail Towel Warmer

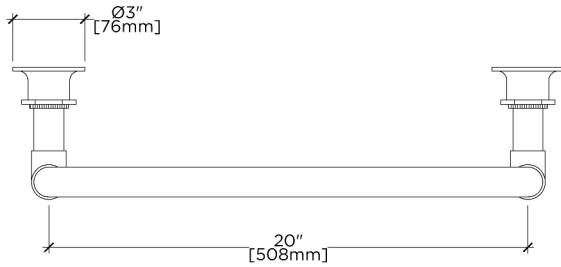

TOP VIEW

SCALE: $1\frac{1}{2}"=1'-0"$

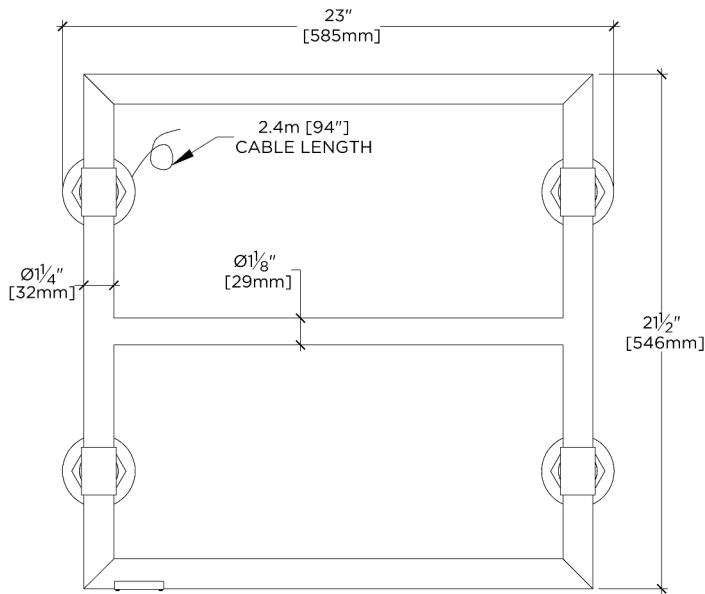

FRONT VIEW

SCALE: $1\frac{1}{2}"=1'-0"$

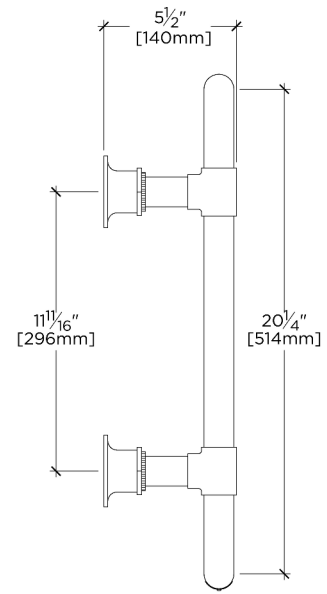

SIDE VIEW

SCALE: $1\frac{1}{2}"=1'-0"$