

Regulator

RGHW20

Regulator 1 1/4" Faceted Knob



SHOWN IN REGULATOR 1 1/4" FACETED KNOB | RGHW20

TECHNICAL DETAILS

Primary Material: Brass

INSPIRATION

With striking scale and unique design, Regulator commands attention through its tribute to early 20th-century boiler room controls, when pride was lavished on hard-built parts. Each handcrafted fitting brings dramatic beauty through powerful proportions and honest details.

CODES & STANDARDS

PRODUCT FEATURES

Solid Brass

Machined and hand-polished

Made in Portugal

Includes 1 x M4 Pan Head Slot 1" Machine Screw and 1 x M4 Pan Head Slot 1 1/2" Machine Screw

CERTIFICATIONS

Replacement Screws available
PRODUCT (NOTES)

Regulator

RGHW20

Regulator 1 1/4" Faceted Knob

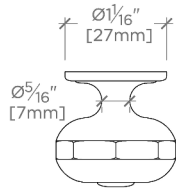

TOP VIEW SCALE: 6"=1'-0"

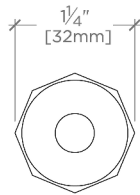

FRONT VIEW SCALE: 6"=1'-0"

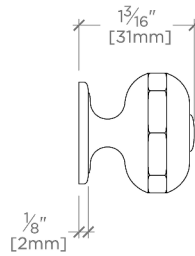

SIDE VIEW SCALE: 6"=1'-0"