

EASTON

Easton 4" Pull

EAHW04



SHOWN IN EASTON 4" PULL | EAHW04

TECHNICAL DETAILS

Depth/Width: 3/4"
Hardware Primary Material: Solid Brass
Hardware Shape: Pull
Length: 5 3/4"
Primary Material: Brass

INSPIRATION

Rooted in classical Edwardian design, Easton is our most expansive collection—offering a comprehensive family of pieces that bring polished detail and timeless tradition to any setting. Revered for its exquisite proportions and impeccable scale, Easton is a trusted choice among designers.

CODES & STANDARDS

PRODUCT FEATURES

Solid Brass

Made in Portugal

Includes 2 x M4 Pan Head Slot 1" Machine Screw and 2 x M4 Pan Head Slot 1 1/2" Machine Screw

CERTIFICATIONS

PRODUCT (NOTES)

Easton 4" Pull

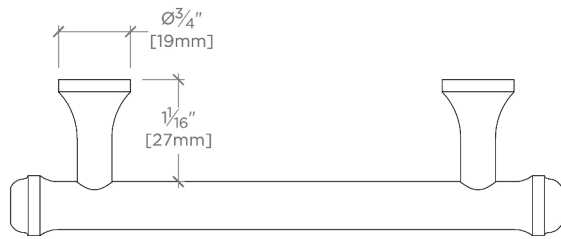

TOP VIEW

SCALE: 6"=1'-0"

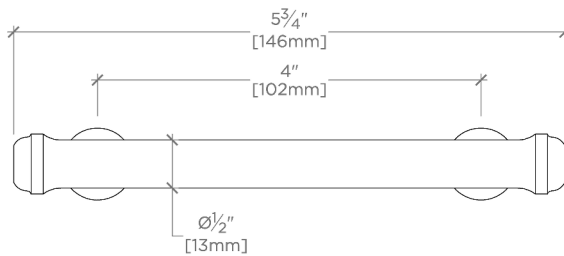

FRONT VIEW

SCALE: 6"=1'-0"

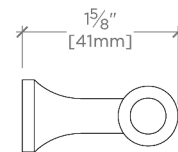

SIDE VIEW

SCALE: 6"=1'-0"