

## HENRY

HNTW03

Henry 110v Multi-Rail Towel Warmer



SHOWN IN HENRY 110V MULTI-RAIL TOWEL WARMER | HNTW03

### TECHNICAL DETAILS

Diameter Of Legs Tubes: 1 1/4"  
Electric Requirements: 0.56A  
Primary Material: Brass  
Voltage: 110V  
Wet/Dry: Wet or Dry

### INSPIRATION

Influenced by the connection of industry and art Henry easily transitions between modern, traditional, utilitarian and classic settings.

### CODES & STANDARDS

CSA Model Number - HENR323W; CSA C22.2, UL 499

### PRODUCT FEATURES

A standard in European hotels, an electric towel warmer is the ultimate in luxury

Made of brass

To best suit personal comfort level, we recommend installation with a dimmer switch.

Stocked in Brass, Chrome, Nickel and Dark Nickel

### CERTIFICATIONS



### PRODUCT (NOTES)

Henry 110v Multi-Rail Towel Warmer

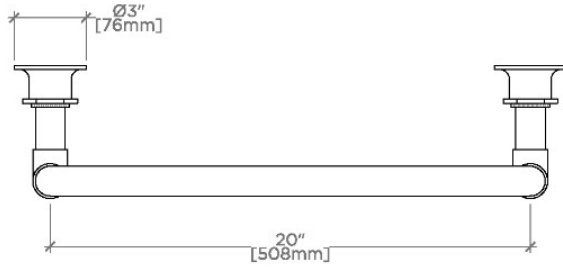

TOP VIEW

SCALE:  $1\frac{1}{2}''=1'-0''$

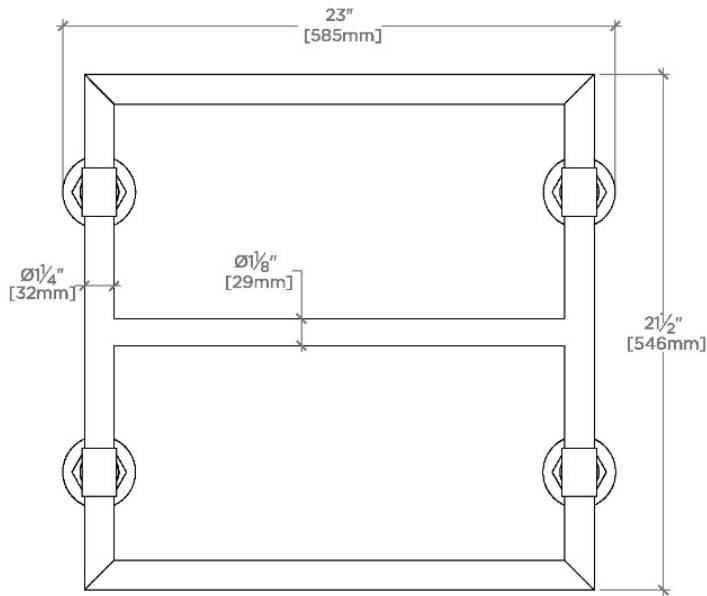

FRONT VIEW

SCALE:  $1\frac{1}{2}''=1'-0''$

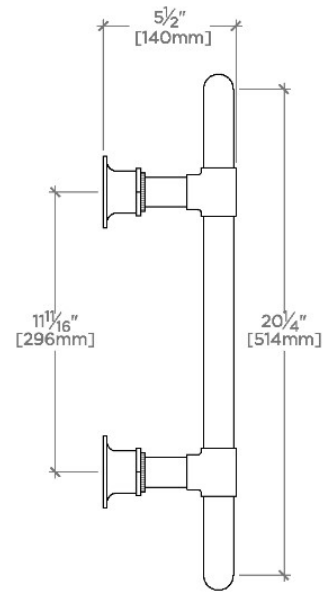

SIDE VIEW

SCALE:  $1\frac{1}{2}''=1'-0''$