

INSTALLATION GUIDELINES

AIR SWITCH

UNIVERSAL AIR SWITCH

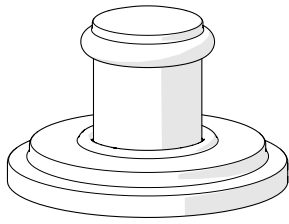

STYLES

UAS01C [SHOWN]	UAS02C	UAS03C
----------------	--------	--------

IMPORTANT:

- To ensure this product is installed properly, you must read and follow these guidelines.
- The owner/user of this AIR switch must keep this information for future reference.
- This AIR switch must be installed by a professional licensed contractor.
- This AIR switch is **sold partially** assembled but shown fully disassembled for illustrative and service purposes only. Inspect the AIR switch to ensure you have all the parts required for proper installation.
- Be sure your installation conforms to all federal, state, and local codes. In the State of Massachusetts, all installations must comply with the rules and regulations set forth within 248 CMR.
- Use only a strap wrench or protected/smooth-jaw wrench on any finished surface.
- **CAUTION:**
 - To avoid damage to this equipment or to the equipment being controlled, do **not** turn on and off rapidly.
 - Do **not** exceed specified electrical ratings.
 - Do **not** crimp, or damage the tubing.
- The use of certain plumber's putty may stain stone or tile surfaces.
- If further assistance is required, please contact Product Support at 1-800-927-2120 Monday through Friday, 8am - 6pm EST.

TECHNICAL DETAILS:

ELECTRICAL RATING	15 Amps @ 120 V AC
FITTING HOLE DIAMETER	Ø1-1/4" [32mm]
DECK THICKNESS	2" [52mm] MAX

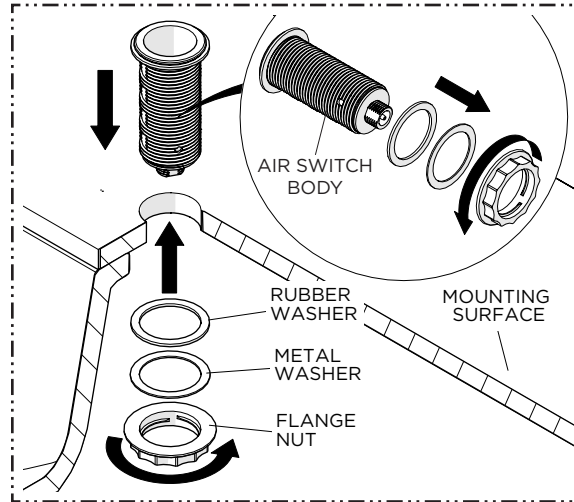

1. Remove the FLANGED NUT and WASHERS from the AIR SWITCH BODY, insert the BODY through the hole on the MOUNTING SURFACE, then reinstall the WASHERS and secure with the FLANGED NUT from underneath until snug.

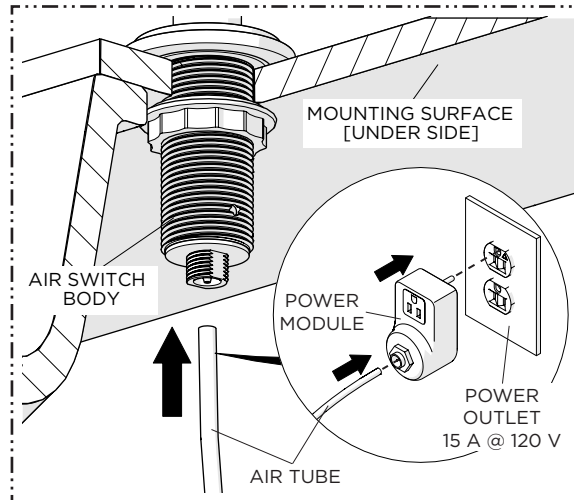

3. Connect one end of the AIR TUBE to the AIR SWITCH BODY and route it to the POWER MODULE without any kinks. Make sure the tube sags below the POWER MODULE, then insert the other end into the POWER MODULE and plug POWER MODULE to POWER OUTLET.

WATERWORKS

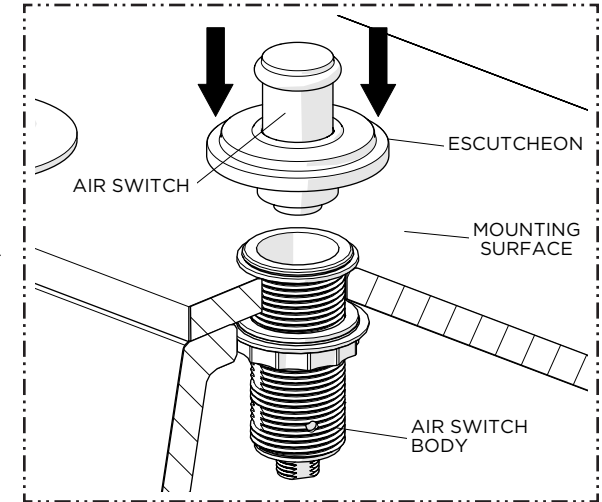

2. Hold the AIR SWITCH by the ESCUTCHEON, align it with the AIR SWITCH BODY, and push-fit it in place, making sure ESCUTCHEON seats properly on the MOUNTING SURFACE.

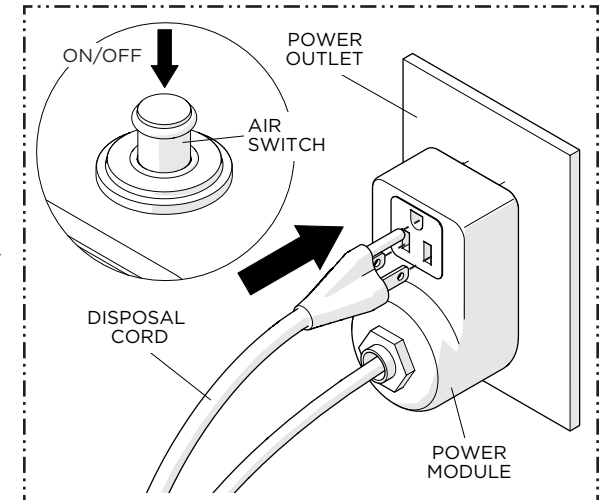

4. Plug the DISPOSAL CORD into the POWER MODULE and check that the system functions correctly. To operate the DISPOSER, press and release the push button to turn it ON.

CAUTION: The disposer may begin to operate. If it does, simply press and release the push button to turn the disposer OFF.