

WATERWORKS STUDIO

SERVICE PARTS

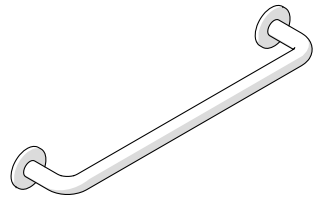

STYLE FLT B18
Flyte Single 18" Towel Bar

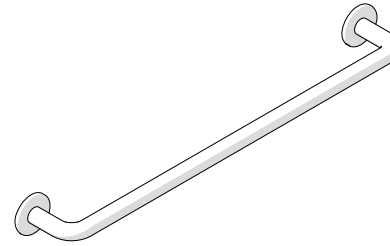

STYLE FLT B24
Flyte Single 24" Towel Bar

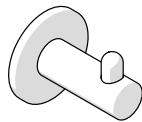

STYLE FLRH01
Flyte Single Hook

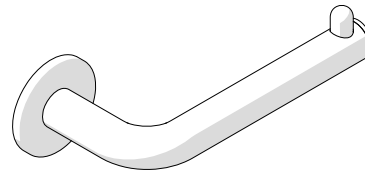

STYLE FLPH01
Flyte Wall Mounted One Arm Paper Holder

WELCOME TO

WATERWORKS STUDIO

Over thirty years of experience distilled into signature fittings, surfaces, textiles, and accessories. Waterworks Studio is an edited collection of design solutions curated to be concise, engineered to be complete, and crafted for quality.

Everything you need, nothing more.

**TO ORDER PARTS CALL
1 (800) 927-2120 (EXT 2)**

Order by part number and specify color, finish, or other options if required.

PRODUCT SUPPORT

Our Product Support team provides troubleshooting and technical problem resolution, including replacement parts and installation recommendations throughout the life of your product.

Product Support is available Monday through Friday, 9am-6pm.

**LIMITED LIFETIME
WARRANTY**

Our warranty covers repair and replacement of Waterworks products if within the applicable coverage period and deemed defective by Waterworks. Waterworks will, at its option, repair or replace such products; this does not include installation costs, labor charges, or other incidental or consequential costs.

To obtain your complete warranty or inquire about warranty service, please visit us at www.waterworks.com or contact our Product Support Team.

MAIN KITS

435784
MOUNTING HARDWARE KIT

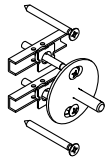
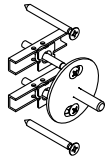

922103
FASTENING
SET SCREW

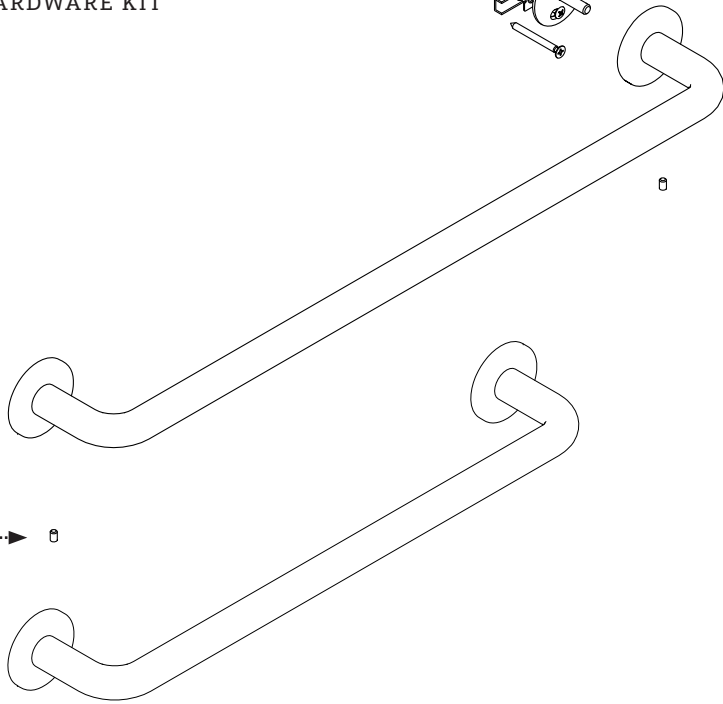

070146
MOUNTING
HARDWARE
KIT

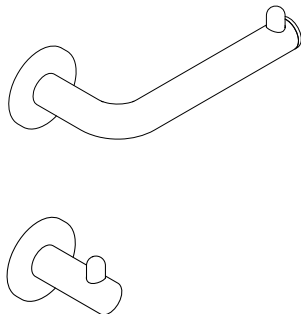
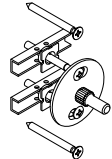

KIT COMPONENTS

435784

MOUNTING
HARDWARE KIT

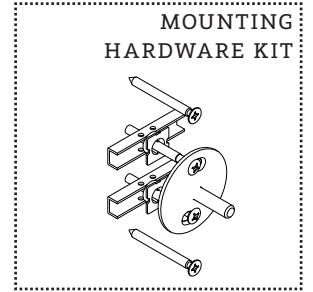

ANCHOR

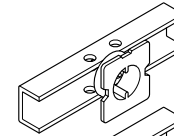

ANCHOR

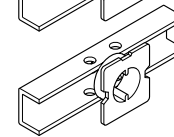

MOUNTING
PLATE

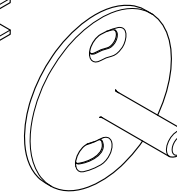

SCREW

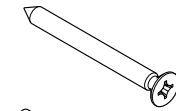

SCREW

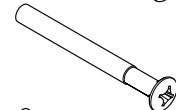

SCREW

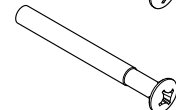

SCREW

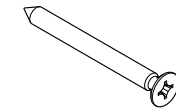

KIT COMPONENTS

070146

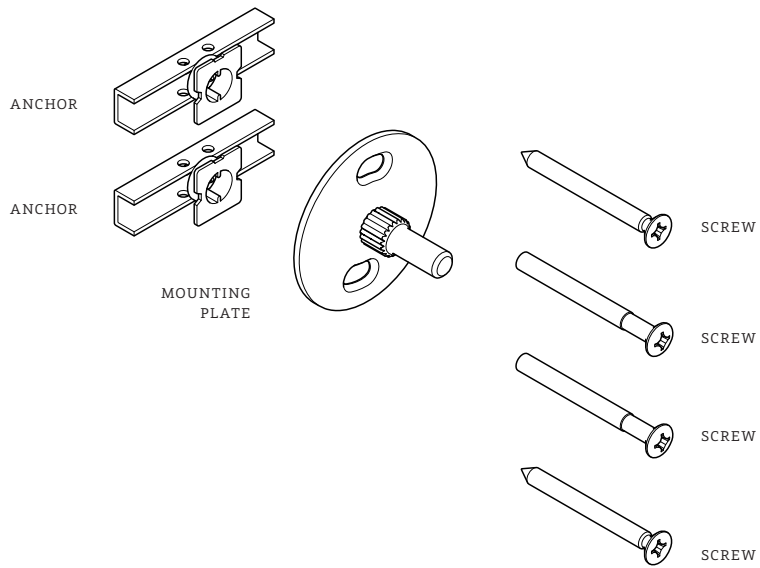
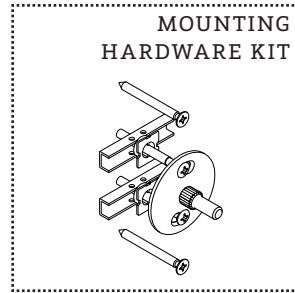

*FINISH/COLOR MUST BE SPECIFIED WHEN ORDERING
++SUPPLIED AS A PAIR

SERVICE PARTS INDEX

<u>STYLE</u>	<u>DESCRIPTION</u>	<u>PG</u>
922103	FASTENING SET SCREW	2
435784	MOUNTING HARDWARE KIT	3
070146	MOUNTING HARDWARE KIT	4

WATERWORKS
STUDIO

PRODUCT SUPPORT

60 BACKUS AVENUE
DANBURY, CT 06810

1 (800) 927-2120 (EXT 2)

WWW.WATERWORKS.COM/STUDIO