

STYLE No. LDTH01
with Metal Cross Handle

STYLE No. LDTH10
with Metal Lever Handle

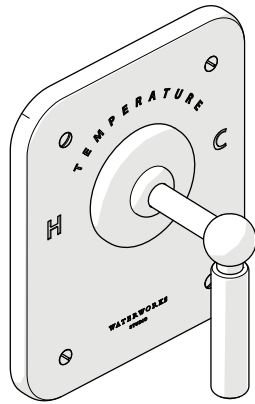
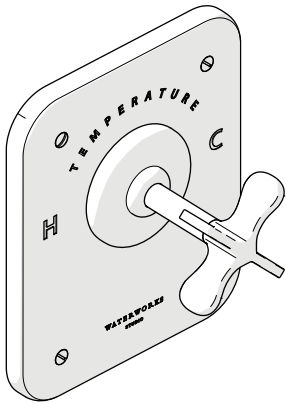

SPECIFICATIONS:

Control Valve Rough-in Depth Maximum: 4-1/4" [108mm]
Control Valve Rough-in Depth Minimum: 3-1/4" [83mm]
Fittings Hole Diameter: 4-1/2" [114mm]*
Hot Limit Safety Stop: Located On Thermostatic Valve

* Ø4-1/2" [114mm] hole is required for servicing.

REQUIRED PLUMBING DETAILS:

Universal 1/2" Thermostatic Valve
STYLE No. GUTH56

IMPORTANT:

- **The SCREWS on the front of the TRIM PLATE are aesthetic only and do not serve any mechanical purpose and should not be removed.**
- To ensure this product is installed properly, you must read and follow these guidelines.
- The owner/user of this product must keep this information for future reference.
- This product is intended to work with the Universal 1/2" Thermostatic Valve (Style No. GUTH56 - SOLD SEPARATELY) which features anti-scald protection.
- The risk of scalding exists until the installer has properly calibrated/adjusted the temperature setting and set the integrated high limit stop on the valve during final trim installation.
- The Universal 1/2" Thermostatic Valve (Style No. GUTH56) only mixes hot and cold water. It does not have volume or shut-off capabilities. A diverter or wall valve (SOLD SEPARATELY) control on/off/volume and must be installed for each fitting that will have water flowing to it.

- This product cannot be used directly with a diverting tub spout.
- This product must be on-site prior to rough-in. This allows the installer to visualize the installation.
- This product must be installed by a professional licensed contractor.
- Be sure your installation conforms to all federal, state, and local codes. In the State of Massachusetts, all installations must comply with the rules and regulations set forth within 248 CMR.
- Inspect the product to ensure you have all the parts required for proper installation.
- Refer to the specification and assembly drawings attached. Product is sold partially assembled but shown fully disassembled for illustrative and service purposes only.
- Use only a strap wrench or protected/smooth-jaw wrench on any finished surface.
- The use of certain plumber's putty may stain stone or tile surfaces.

TEMPERATURE CALIBRATION:

- The risk of scalding exists until the installer has properly calibrated/adjusted the temperature setting and set the integrated high limit stop on the VALVE during final trim installation.
1. Unthread the SCREWS and remove the TILE GUARD then unthread and remove the THREADED TUBE. You can discard the O-RING on the TUBE. See Figure - 01.

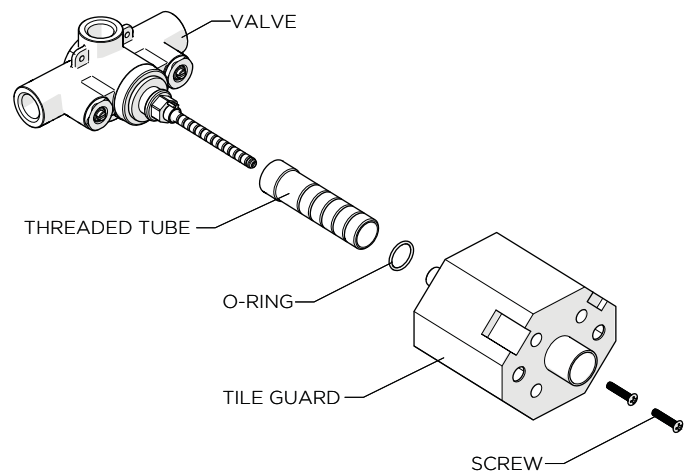

FIGURE - 01

- See Figure - 02 for Steps 2 - 7.
2. Slide the O-RING on the CARTRIDGE STEM and the LIMIT STOP up the STEM. Do NOT remove or damage the O-RING.

These guidelines have been prepared for the professional contractor to aid in the installation of:
LUDLOW THERMOSTATIC CONTROL VALVE TRIM WITH METAL CROSS HANDLE (STYLE No. LDTH01) &
LUDLOW THERMOSTATIC CONTROL VALVE TRIM WITH METAL LEVER HANDLE (STYLE No. LDTH10)
All dimensions are based on original specification and are subject to change and variation.
Please consult your Design Associate for current specifications.

3. Turn on the water supply and open a diverter or wall valve to run water through the THERMOSTATIC VALVE and check for leaks.
 - Make sure both SERVICE STOPS on the THERMOSTATIC VALVE are open.
4. Slowly rotate the CARTRIDGE STEM clockwise to attain full cold then rotate it counter-clockwise to attain full hot. Verify that a full range of temperatures exists.
 - NOTE: It is approximately 3/4 of a rotation from full cold to full hot.
5. With water running, rotate the CARTRIDGE STEM to adjust the temperature to the maximum desired bathing temperature, verified with a thermometer.
6. Slide the LIMIT STOP back onto the STEM making sure to properly align it with the PIN on the CARTRIDGE BONNET.
7. Slide the O-RING back to its original position and turn off the water.
 - The O-RING will prevent the LIMIT STOP from sliding off the STEM.

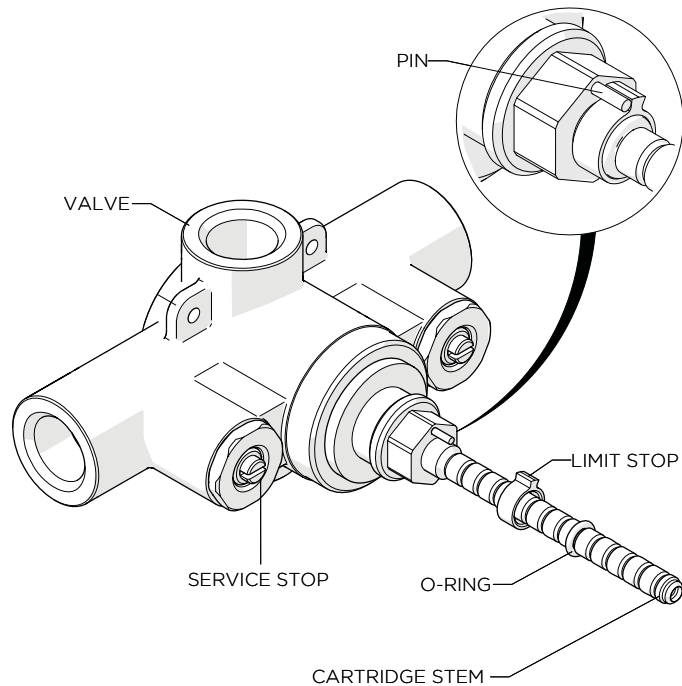

FIGURE - 02

INSPECT THE CALIBRATION:

8. Turn the CARTRIDGE STEM clockwise then turn the water on and confirm the LIMIT STOP is functioning properly by turning the STEM counter-clockwise at which point it should stop.

9. Verify the temperature to be the maximum temperature set in Step 5. If it is not the correct temperature, repeat the calibration procedures.
10. Turn the water off.

TRIM INSTALLATION:

- See Figure - 03 for Steps 11 - 14.

DIMENSION	VALUE (INCHES)
A	3/16"
B	1"

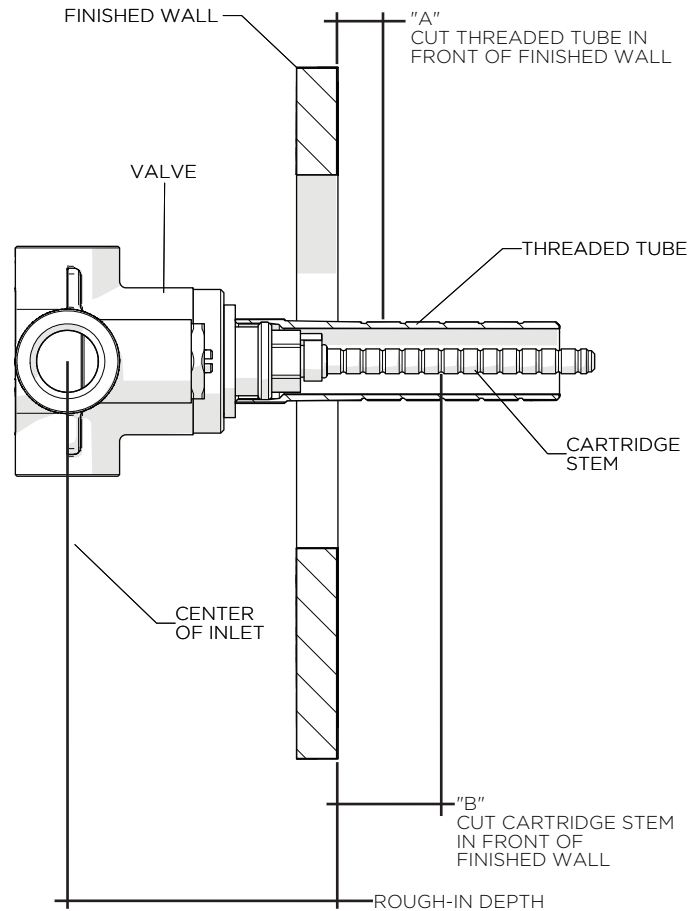

FIGURE - 03

11. Thread the THREADED TUBE back onto the VALVE then mark the TUBE as shown.
12. Remove and cut the TUBE. Do NOT cut the end of the TUBE with the internal threads.
13. Mark the CARTRIDGE STEM as shown then cut the STEM.
14. Thread the THREADED TUBE back onto the VALVE.

These guidelines have been prepared for the professional contractor to aid in the installation of:
 LUDLOW THERMOSTATIC CONTROL VALVE TRIM WITH METAL CROSS HANDLE (STYLE No. LDTH01) &
 LUDLOW THERMOSTATIC CONTROL VALVE TRIM WITH METAL LEVER HANDLE (STYLE No. LDTH10)
 All dimensions are based on original specification and are subject to change and variation.
 Please consult your Design Associate for current specifications.

- See Figure - 04 for Steps 15 - 16.

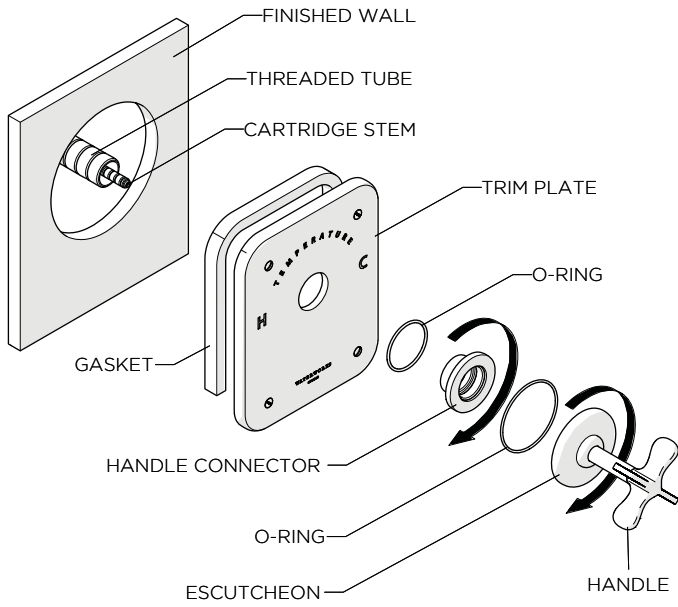

FIGURE - 04

15. While holding the TRIM PLATE against the finished wall, thread the HANDLE CONNECTOR onto the THREADED TUBE and securely tighten. Make sure to use the GASKET and O-RING provided.
 16. With the HANDLE in the desired orientation, thread the ESCUTCHEON into the HANDLE CONNECTOR and securely tighten the ESCUTCHEON. Make sure to use the O-RING provided.
- **The SCREWS on the front of the TRIM PLATE are aesthetic only and do not serve any mechanical purpose and should not be removed.**

FINISH THE INSTALLATION:

17. Turn and operate the HANDLE to ensure the LIMIT STOP is working properly.
 18. Turn on the water and verify all the VALVES are functioning properly.
- If further assistance is required, please contact Product Support at 1-800-927-2120 Monday through Friday, 8am - 6pm EST.
 - Refer to the separate Service Parts Documents for available replacement parts.

These guidelines have been prepared for the professional contractor to aid in the installation of:
LUDLOW THERMOSTATIC CONTROL VALVE TRIM WITH METAL CROSS HANDLE (STYLE No. LDTH01) &
LUDLOW THERMOSTATIC CONTROL VALVE TRIM WITH METAL LEVER HANDLE (STYLE No. LDTH10)
All dimensions are based on original specification and are subject to change and variation.
Please consult your Design Associate for current specifications.

W A T E R W O R K S