

## CLASSIC

CLWP2R

Classic 66" x 34" x 21" Right Hand Whirlpool Rectangular Bathtub with End Drain



SHOWN IN CLASSIC 66" X 34" X 21" RIGHT HAND WHIRLPOOL RECTANGULAR BATHTUB WITH END DRAIN | CLWP2R

### TECHNICAL DETAILS

ADA Compliance: No  
 Assembly Configuration: One Piece  
 Bathing Type: Bathing, Soaking and Showering  
 Depth/Width: 34"  
 Drilling Option: None  
 Electric Requirements: 16" high x 30" wide Access Panel  
 Height: 21"  
 Installation Type: Drop In or Undermount  
 Item Weight Filled: 725.0 pounds  
 Length: 66"  
 Material Wall Thickness: 7/16"  
 Number Of Holes: Two Hole  
 Overflow Opening: Yes  
 Primary Material: Acrylic  
 Single Or Double Ended: Single Ended  
 Suggested Application: Bath

### INSPIRATION

Our Classic collection encompasses core elements for every bath. This collection is perfect for all design aesthetics.

### CODES & STANDARDS

cUL Model Number: 6634; ASME A112.19.7/CSA B45.10/UL 1795

### PRODUCT FEATURES

Constructed of high density acrylic which is the highest industry standard

The high density acrylic acts as a reinforcement and provided an overall thicker bathtub construction

### CERTIFICATIONS



### PRODUCT (NOTES)

Dimensions of fixtures are nominal. Measure your actual product for rough-in details.

## CLASSIC

## CLWP2R

Classic 66" x 34" x 21" Right Hand Whirlpool Rectangular  
Bathtub with End Drain

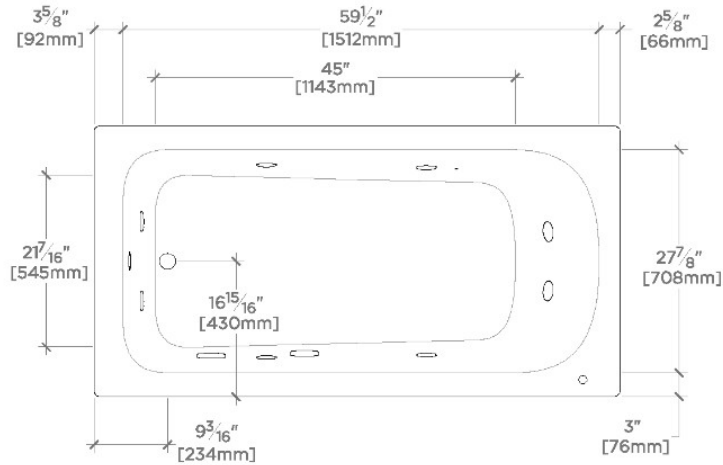

TOP VIEW

SCALE: 1/2"=1'-0"

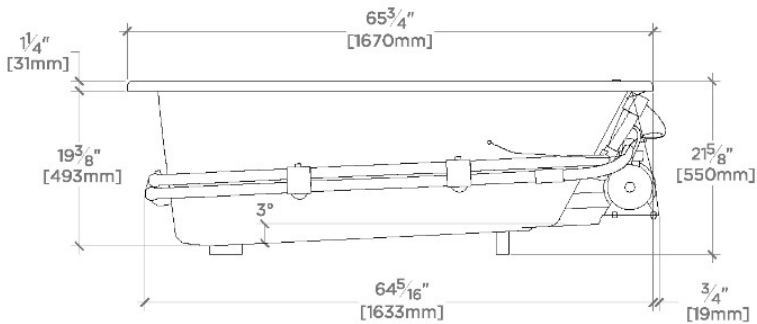

SIDE VIEW

SCALE: 1/2"=1'-0"

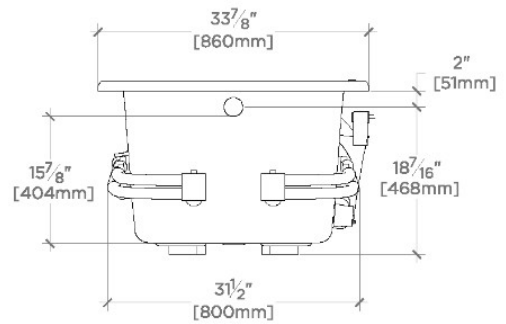

END VIEW

SCALE: 1/2"=1'-0"