

FINOT

Finot Handshower on Hook

NOHS01



SHOWN IN FINOT HANDSHOWER ON HOOK | NOHS01

TECHNICAL DETAILS

ADA Compliance: When installed per ADA guidelines
 Adjustable Versus Fixed Spray: Fixed Spray
 Fittings Hole Diameter: 1 3/8"
 Handshower Spray Hose Length: 60"
 Inlet Connection Size: 1/2"
 Inlet Connection Type: Female NPT
 Integrated Diverter: N
 Pivot: N
 Primary Material: Brass
 Restricted Maximum Flow Rate: 1.75 gpm
 Water Pressure Maximum: 85.0 psi
 Water Pressure Minimum: 20.0 psi
 Water Pressure Recommended: 45.0 psi

INSPIRATION

Finot seamlessly blends meticulous details with contemporary sensibility. A true integration of design and engineering expertise, this collection is comprised of parts that are decisively cast and forged to achieve painstaking precision and refinement.

CODES & STANDARDS

NOHS01-F.RX, ASME A112.18.1/CSA B125.1, Waterworks Handshowers use check valves compliant to ASME A112.18.3 for backflow protection. CEC(1.5GPM & 1.75GPM Only), DOE, State of MA

PRODUCT FEATURES

Features a Fixed Spray Pattern

Available in 1.75gpm (6.6L/min) Flow Rate

Stocked In Chrome, Nickel, Brass and Dark Nickel

CERTIFICATIONS



PRODUCT (NOTES)

FINOT

NOHS01

Finot Handshower on Hook

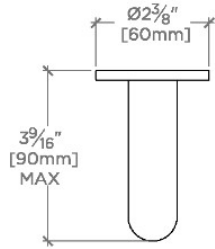

TOP VIEW

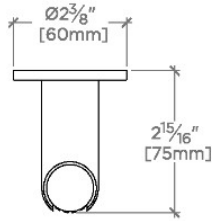

SCALE: 3"=1'-0"

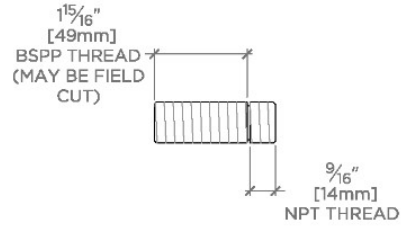

ADAPTER INCLUDED-
INTERNATIONAL USE ONLY

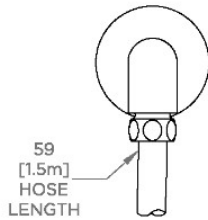
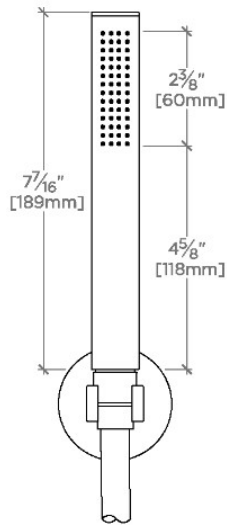

FRONT VIEW

SCALE: 3"=1'-0"

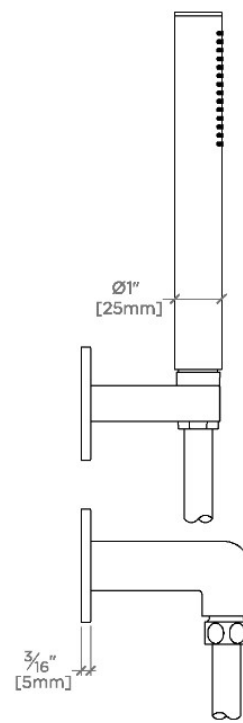

SIDE VIEW

SCALE: 3"=1'-0"