

HENRY

Henry 4" Pull

HNHW04



SHOWN IN HENRY 4" PULL| HNHW04

TECHNICAL DETAILS

Height: 41 mm
Length: 149 mm
Primary Material: Brass

INSPIRATION

Influenced by the connection of industry and art Henry easily transitions between modern, traditional, utilitarian and classic settings.

PRODUCT FEATURES

Match to Henry fittings and accessories

Hexagon shapes in knobs and pulls with exposed screws

Solid brass

Made in the USA

Includes per fixing: 8-32 Truss Head Machine Screw-Combo-Slotted

WATERWORKS

HENRY

Henry 4" Pull

HNHW04

MOUNTING HARDWARE INCLUDED		
STYLE #	DESCRIPTION	QTY
998945	Service Parts 8-32 1" Truss Head Machine Screw, Combo, Slotted	2
998946	Service Parts 8-32 1½" Truss Head Machine Screw, Combo, Slotted	2

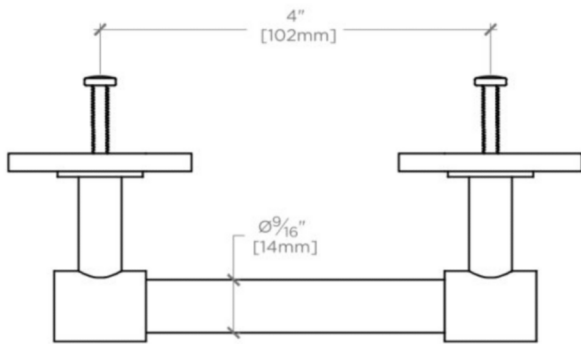

TOP VIEW

SCALE: 6"=1'-0"

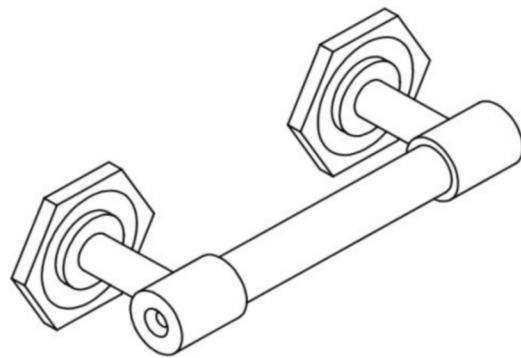

ISO VIEW

SCALE: 6"=1'-0"

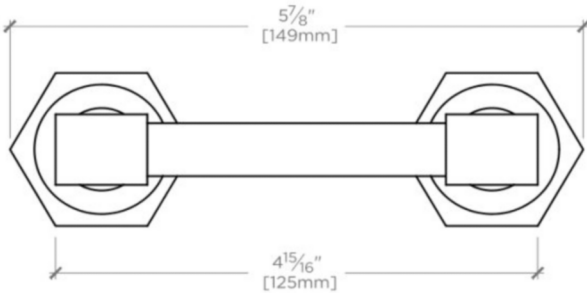

FRONT VIEW

SCALE: 6"=1'-0"

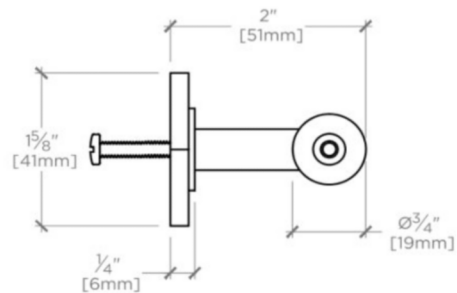

SIDE VIEW

SCALE: 6"=1'-0"