

R.W. ATLAS

RWWL18

R.W. Atlas 18" Wall Mounted 90 Degree Shower Arm with Flange



SHOWN IN R.W. ATLAS 18" WALL MOUNTED 90 DEGREE SHOWER ARM WITH FLANGE | RWWL18

TECHNICAL DETAILS

Fittings Hole Diameter: 1 1/4"
Inlet Connection Size: 1/2"
Inlet Connection Type: Male NPT
Outlet Connection Size: 1/2"
Outlet Connection Type: Male NPT
Water Pressure Recommended: 45.0 psi

INSPIRATION

Powerful shapes, genuine materials and unique aesthetic details. The original, impeccable vision of R.W. Atlas pairs American ingenuity with European craftsmanship.

CODES & STANDARDS

PRODUCT FEATURES

Compatible with an assortment of Waterworks showerheads, sold separately

Brass Construction

Includes 18" wall mounted 90 degree shower arm

Stocked in Chrome, Nickel and Brass

CERTIFICATIONS

PRODUCT (NOTES)

WATERWORKS

R.W. ATLAS

RWWL18

R.W. Atlas 18" Wall Mounted 90 Degree Shower Arm with Flange

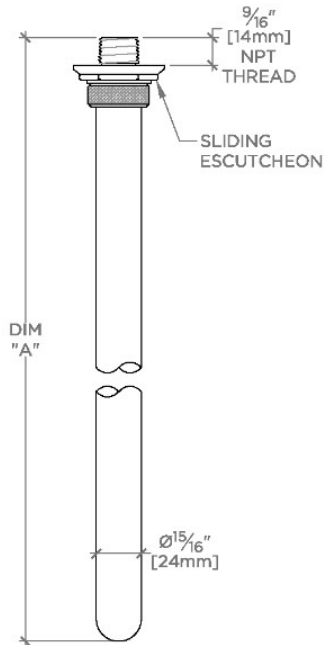

TOP VIEW SCALE: 3"=1'-0"

STYLE NO.	DIM "A"	DIM "B"
RWWL12	$13\frac{1}{16}''$ [331mm]	$12\frac{1}{2}''$ [319mm]
RWWL18	$19\frac{1}{16}''$ [484mm]	$18\frac{1}{2}''$ [472mm]
RWWL22	$23\frac{1}{16}''$ [585mm]	$22\frac{1}{2}''$ [572mm]

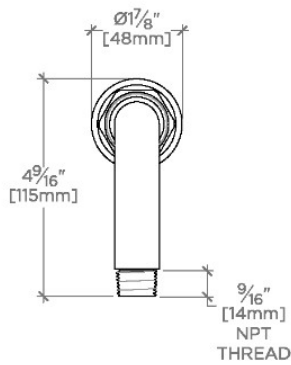

FRONT VIEW SCALE: 3"=1'-0"

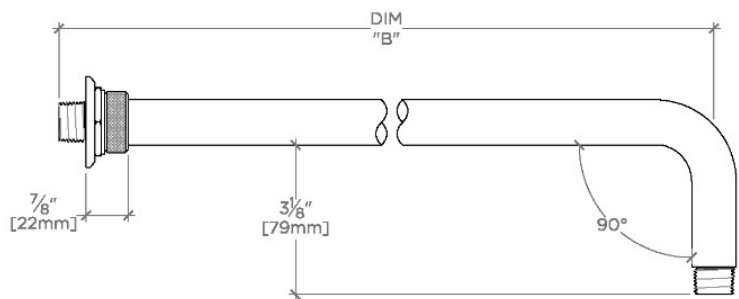

SIDE VIEW SCALE: 3"=1'-0"