

## Bond

B3P120

Bond Solo Series Three Way Pressure Balance Diverter Trim with Roman Numerals and Straight Lever Handle

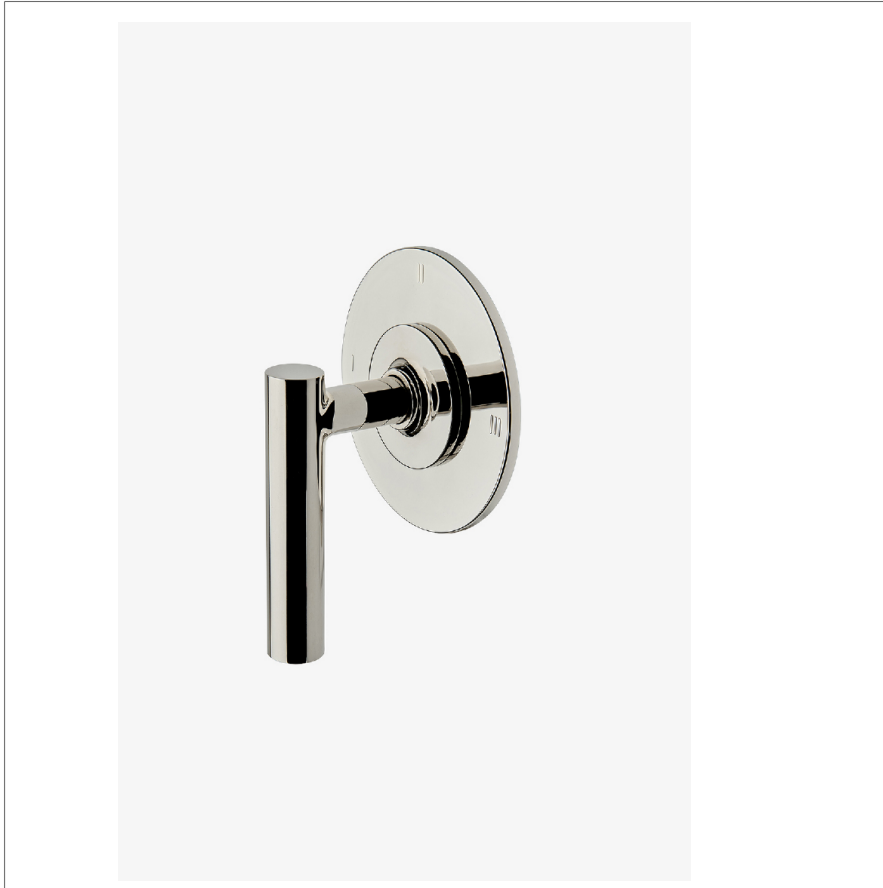

SHOWN IN BOND SOLO SERIES THREE WAY PRESSURE BALANCE DIVERTER TRIM WITH ROMAN NUMERALS AND STRAIGHT LEVER HANDLE | B3P120

### TECHNICAL DETAILS

ADA Compliance: Yes  
 Fittings Hole Diameter: 51 mm  
 Number Of Holes: One Hole  
 Primary Material: Brass

### INSPIRATION

Modern designs infused with rare soul and artistry. Explore our wide range of Bond bath and kitchen elements, from fittings to fixtures to hardware.

### CODES & STANDARDS

ASME A112.18.1/CSA B125.1, State of MA

### PRODUCT FEATURES

Lever Handle

For use with a Pressure Balance shower system and three waterway outlets such as a handshower, shower head, or tub spout

Stocked in Chrome, Nickel, Brass and Dark Nickel

□ Requires valve rough GUDV3P(US) or GU65DV(UK) sold separately

### CERTIFICATIONS



### PRODUCT (NOTES)

## Bond

B3P120

Bond Solo Series Three Way Pressure Balance Diverter Trim  
with Roman Numerals and Straight Lever Handle

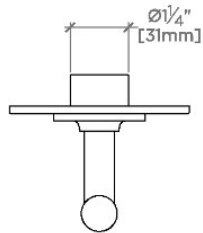

TOP VIEW      SCALE: 3"=1'-0"

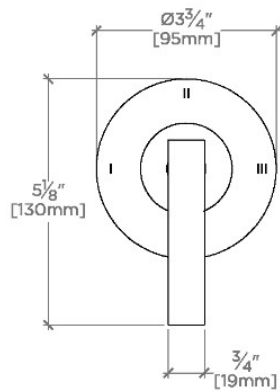

FRONT VIEW      SCALE: 3"=1'-0"

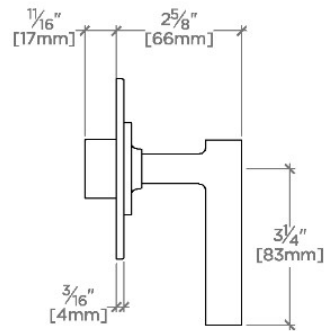

SIDE VIEW      SCALE: 3"=1'-0"