

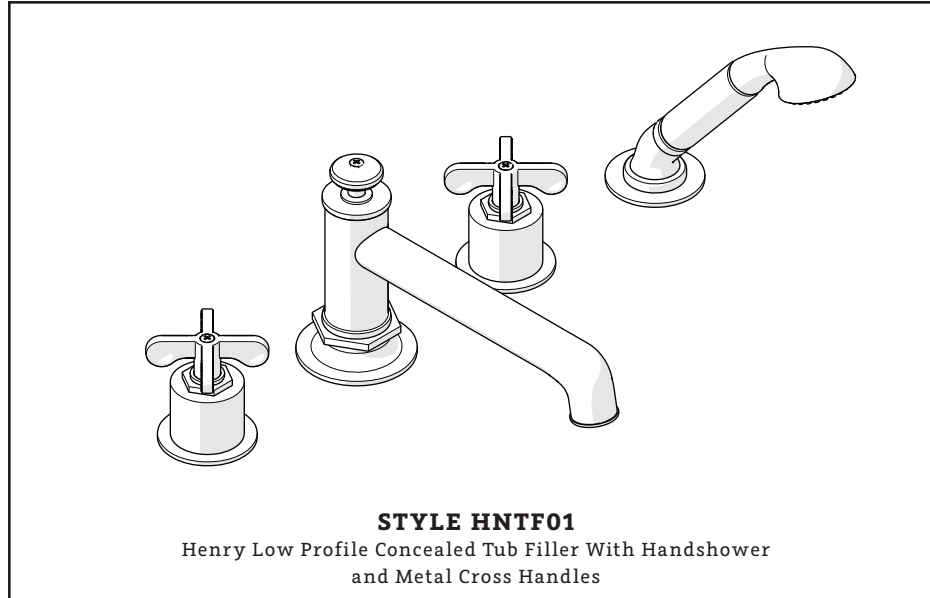

ESTB. 1978

WATERWORKS SERVICE PARTS



STYLE HNTF01

Henry Low Profile Concealed Tub Filler With Handshower
and Metal Cross Handles

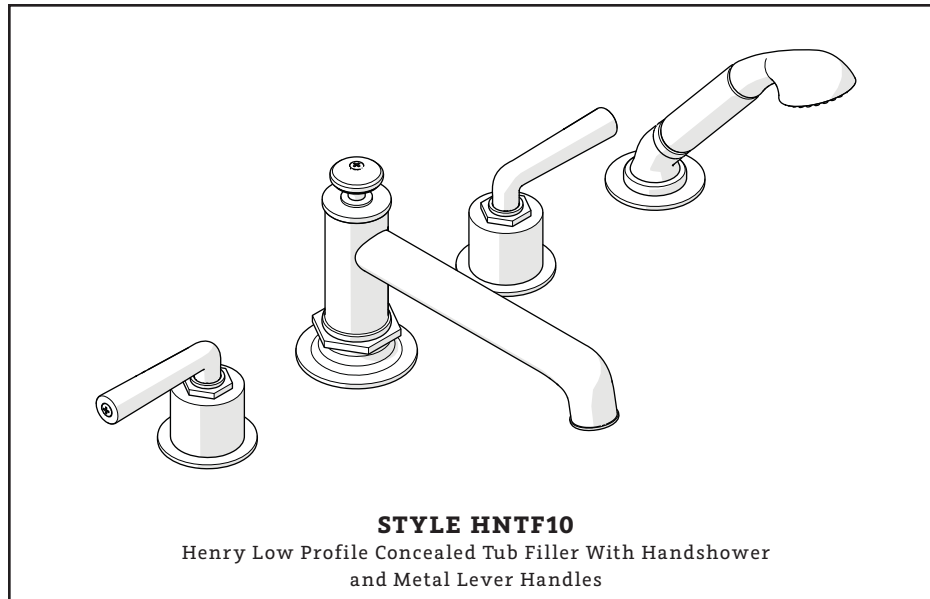

STYLE HNTF10

Henry Low Profile Concealed Tub Filler With Handshower
and Metal Lever Handles

WELCOME TO

WATERWORKS

For over three decades, Waterworks has transformed the bath through an absolute commitment to design authenticity, innovation and quality. A blend of scholarly appreciation and applied experience guarantees mechanical integrity, meticulous craftsmanship, and timeless designs.

**TO ORDER PARTS CALL
1 (800) 927-2120 (EXT 2)**

Order by part number and specify color, finish, or other options if required.

PRODUCT SUPPORT

Our Product Support team provides troubleshooting and technical problem resolution, including replacement parts and installation recommendations throughout the life of your product.

Product Support is available Monday through Friday, 8AM-6PM EST.

**LIMITED LIFETIME
WARRANTY**

Our warranty covers repair and replacement of Waterworks products if within the applicable coverage period and deemed defective by Waterworks. Waterworks will, at its option, repair or replace such products; this does not include installation costs, labor charges, or other incidental or consequential costs.

To obtain your complete warranty or inquire about warranty service, please visit us at www.waterworks.com or contact our Product Support Team.



ESTB. 1978

WATERWORKS

MAIN KITS

STYLES: HNTF01, HNTF10

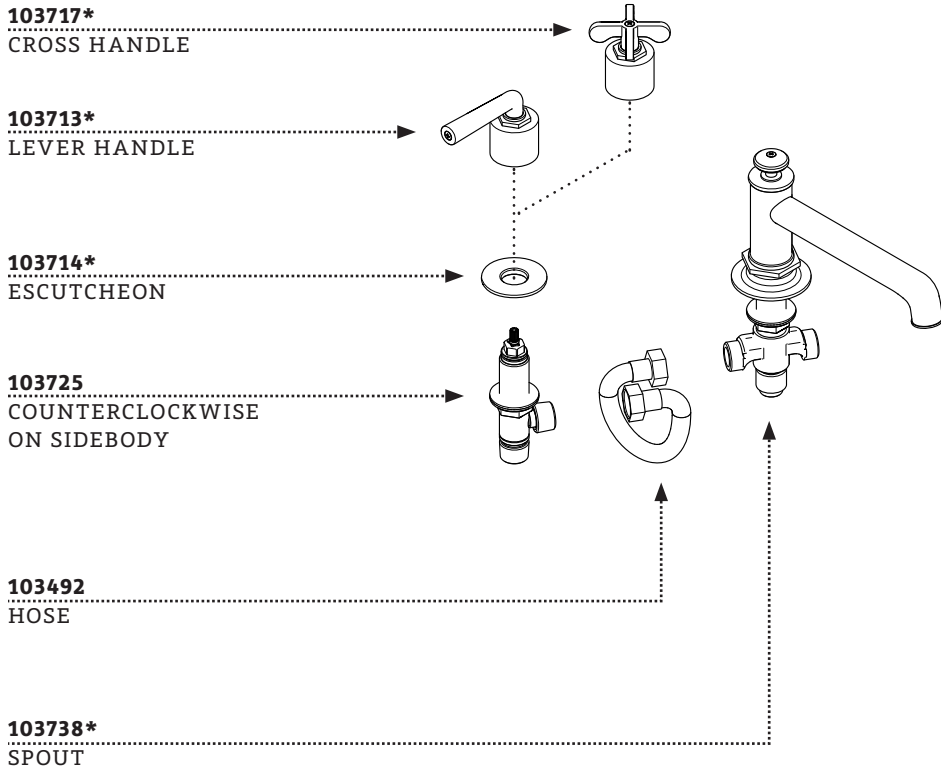

*FINISH/COLOR MUST BE SPECIFIED WHEN ORDERING
++SUPPLIED AS A PAIR

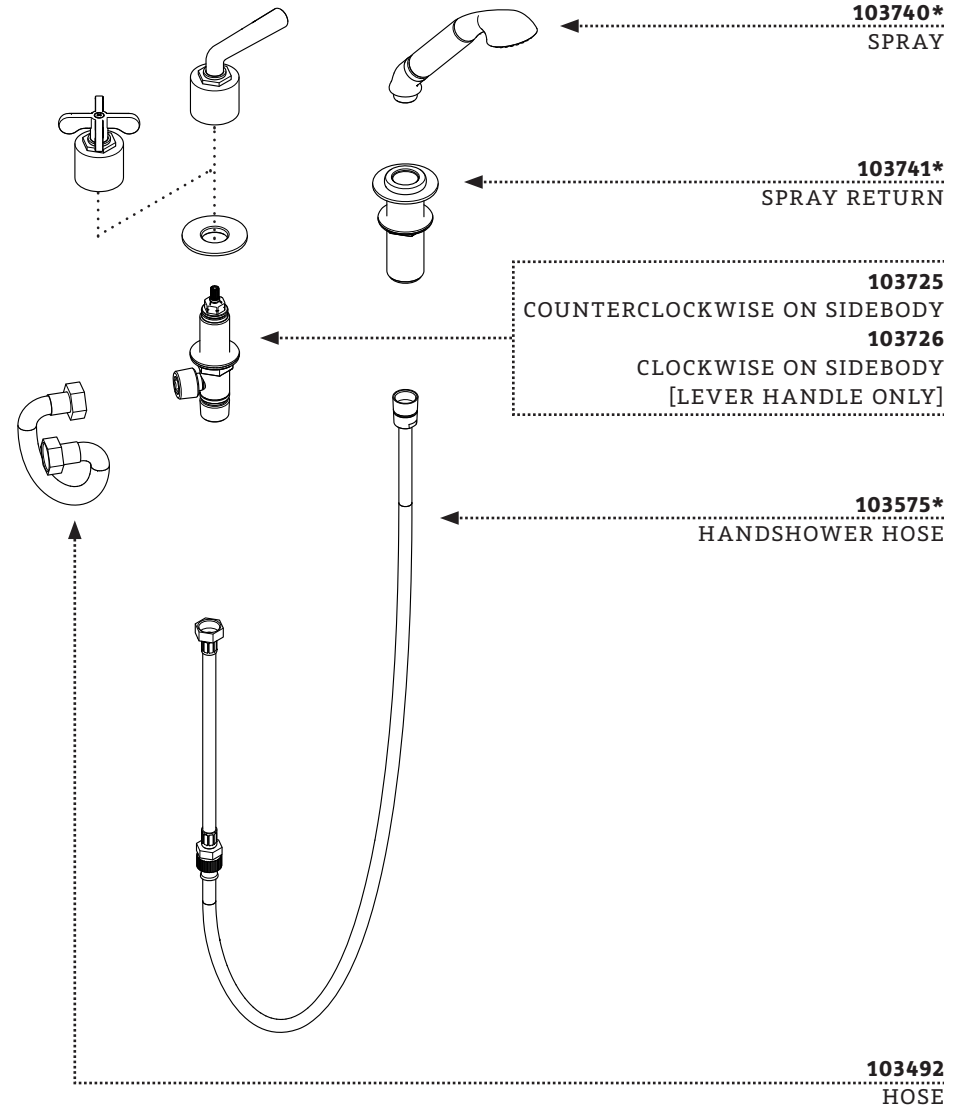



ESTB. 1978

WATERWORKS

KIT COMPONENTS

STYLES: HNTF01, HNTF10

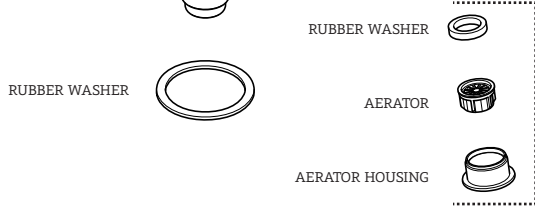
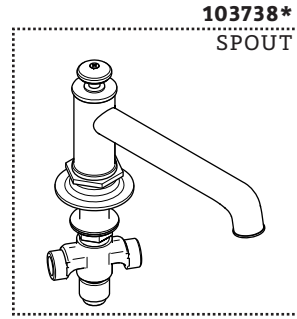
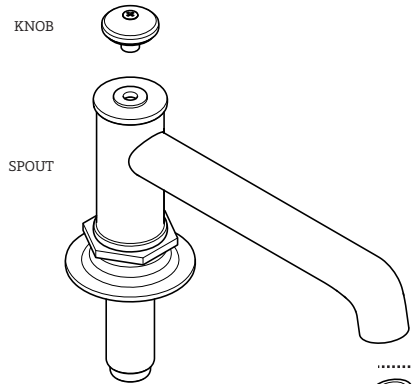

103739*
AERATOR



103471
MOUNTING HARDWARE

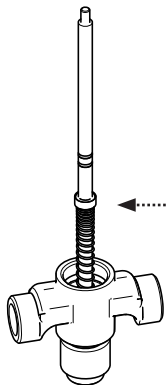

103944*
DIVERTER TEE

*FINISH/COLOR MUST BE SPECIFIED WHEN ORDERING
++SUPPLIED AS A PAIR

KIT COMPONENTS

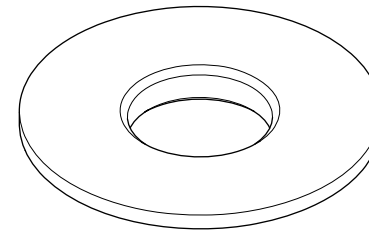
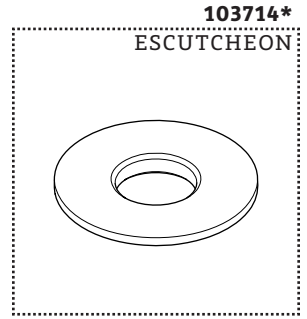

ESCUTCHEON

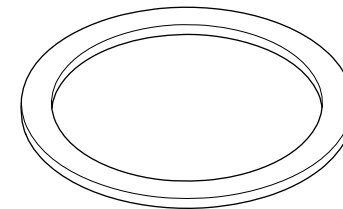

RUBBER WASHER



ESTB. 1978

WATERWORKS

KIT COMPONENTS

STYLES: HNTF01, HNTF10

103471
MOUNTING HARDWARE

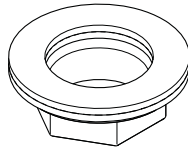

337847
COUNTERCLOCKWISE
ON CARTRIDGE

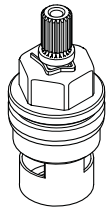

SIDEBODY

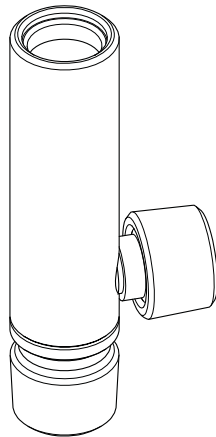

103725

COUNTERCLOCKWISE
ON SIDEBODY

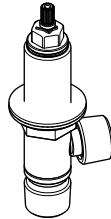

*FINISH/COLOR MUST BE SPECIFIED WHEN ORDERING
++SUPPLIED AS A PAIR

KIT COMPONENTS

103471
MOUNTING HARDWARE

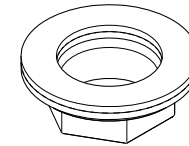

258790
CLOCKWISE ON CARTRIDGE

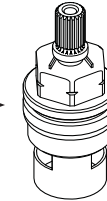

SIDEBODY

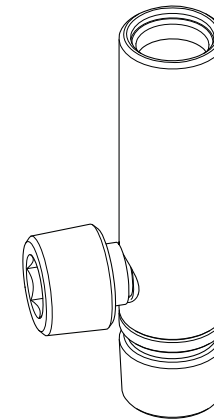

103726

CLOCKWISE ON
SIDEBODY

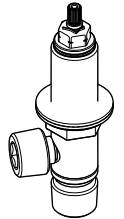



ESTB. 1978

WATERWORKS

KIT COMPONENTS

STYLES: HNTF01, HNTF10

103944*

DIVERTER TEE

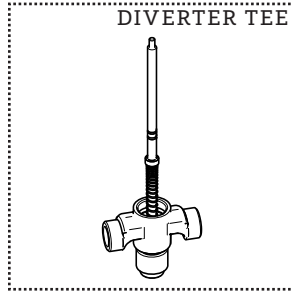

DIVERTER ROD

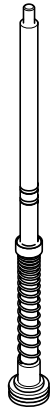

O-RING



TEE

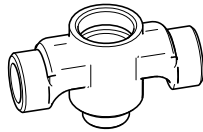

RUBBER WASHER



103678
CHECK VALVE

HOUSING



*FINISH/COLOR MUST BE SPECIFIED WHEN ORDERING
++SUPPLIED AS A PAIR

KIT COMPONENTS

103471

MOUNTING
HARDWARE

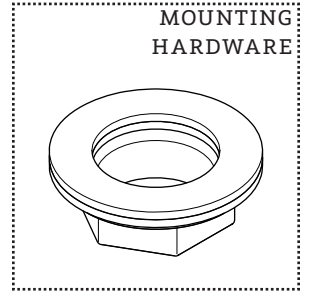

RUBBER WASHER

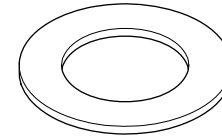

PLASTIC WASHER

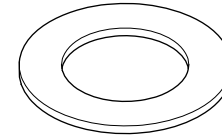

NUT

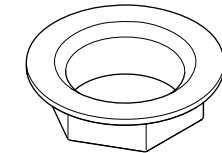



ESTB. 1978

WATERWORKS

KIT COMPONENTS

STYLES: HNTF01, HNTF10

103740*
SPRAY

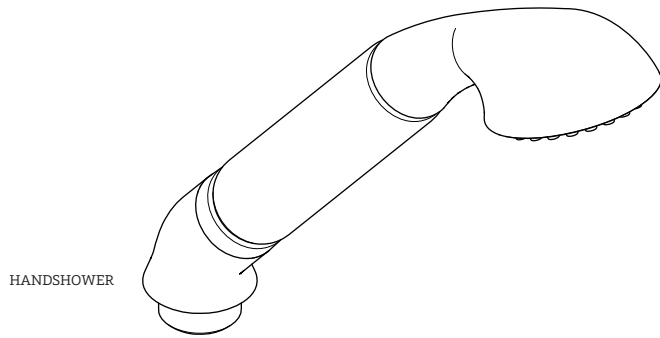
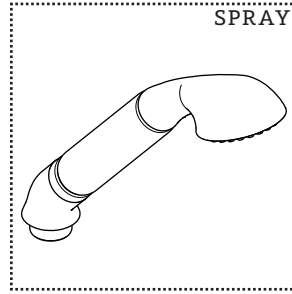

HANDSHOWER

FLOW REGULATING
CHECK VALVE



CLIP



*FINISH/COLOR MUST BE SPECIFIED WHEN ORDERING
++SUPPLIED AS A PAIR

KIT COMPONENTS

103741*

SPRAY RETURN



COLLAR



SLEEVE

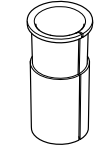

ALL THREAD TUBE

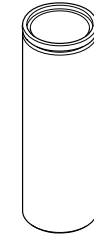

RING



ESCUTCHEON

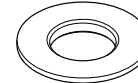

RUBBER WASHER

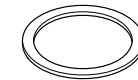

RUBBER WASHER



NUT





ESTB. 1978

WATERWORKS

KIT COMPONENTS

STYLES: HNTF01, HNTF10

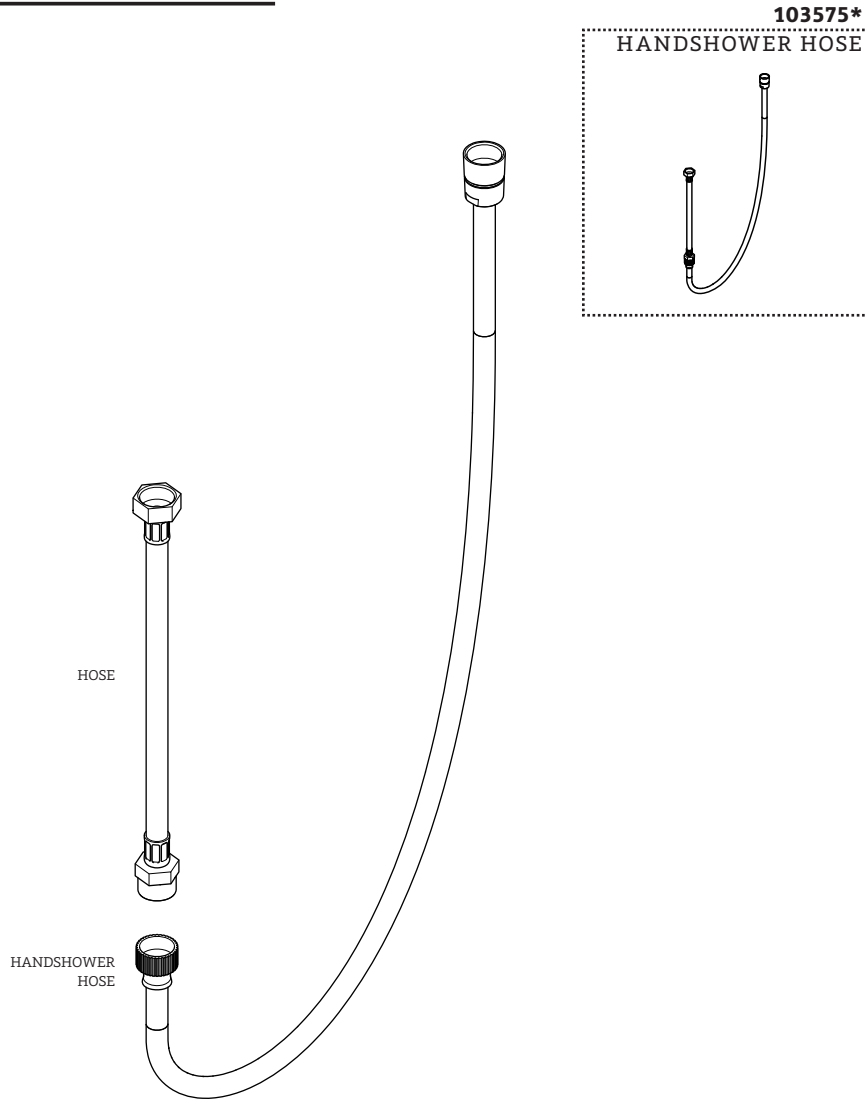

*FINISH/COLOR MUST BE SPECIFIED WHEN ORDERING
++SUPPLIED AS A PAIR

SERVICE PARTS INDEX

<u>STYLE</u>	<u>DESCRIPTION</u>	<u>PG</u>
103739*	AERATOR	4
103678	CHECK VALVE	8
258790	CLOCKWISE ON CARTRIDGE	7
103726	CLOCKWISE ON SIDEBODY	7
337847	COUNTERCLOCKWISE ON CARTRIDGE	6
103725	COUNTERCLOCKWISE ON SIDEBODY	6
103717*	CROSS HANDLE	2
103944*	DIVERTER TEE	8
103714*	ESCUTCHEON	5
103575*	HANDSHOWER HOSE	12
103492	HOSE	3
103713*	LEVER HANDLE	2
103471	MOUNTING HARDWARE	9
103738*	SPOUT	4
103740*	SPRAY	10
103741*	SPRAY RETURN	11

DOCUMENT: SPHN14_REV01



ESTB. 1978

WATERWORKS

PRODUCT SUPPORT

60 BACKUS AVENUE
DANBURY, CT 06810

1 (800) 927-2120 (EXT 2)

WWW.WATERWORKS.COM