

## CATIA

CILT02

Catia Wall Mounted Single Arm Sconce with Shade



SHOWN IN CATIA WALL MOUNTED SINGLE ARM SCONCE WITH SHADE | CILT02

### TECHNICAL DETAILS

Ambient Task: Ambient  
 Bulb Type: Dedicated LED  
 Depth/Width: 5 3/8"  
 Height: 10 3/4"  
 Installation Type: Wall Mounted  
 Interior Exterior Application: Interior Only  
 Junction Box Orientation: Vertical  
 Length: 4 3/16"  
 Number Of Bulbs: One  
 Orientation: Up  
 Primary Material: Brass  
 Safety Warnings: ALWAYS DISCONNECT THE POWER BEFORE INSTALLING AND BEFORE CLEANING OR OTHER MAINTENANCE. CONSULT A QUALIFIED, LICENSED ELECTRICIAN TO ENSURE CORRECT BRANCH CIRCUIT CONDUCTOR.  
 Shade Finish: White or Black  
 Shade Material: Etched Blown Cased Glass or Metal  
 Shade Shape: Tapered Cylinder  
 Suggested Application: Bath, Entry, Kitchen, Laundry  
 Voltage: 120V  
 Wet/Dry: Damp or Dry

### INSPIRATION

Traditional sconce lighting, reinterpreted in a modern way. In this classic design, familiar silhouettes are reduced to their minimalist essence.

### CODES & STANDARDS

cETL

### PRODUCT FEATURES

- Proprietary design
- Solid brass with white glass or black metal shade
- cETL Listed; 3000K, 90CRI, 700lms
- Vertically Mounts
- Dimmable LED fixture - 50,000 hours of life

### CERTIFICATIONS

### PRODUCT (NOTES)

### Catia Wall Mounted Single Arm Sconce with Shade

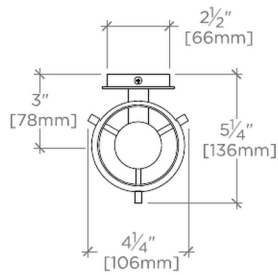

TOP VIEW SCALE: 1 1/2"=1'-0"

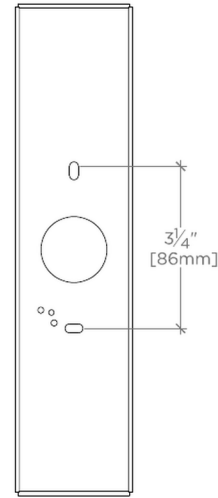

MOUNTING PLATE

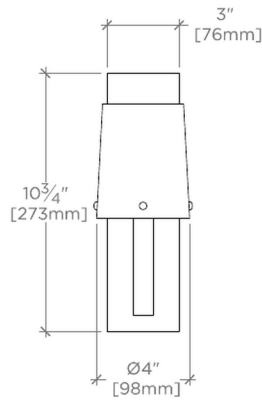

FRONT VIEW SCALE: 1 1/2"=1'-0"

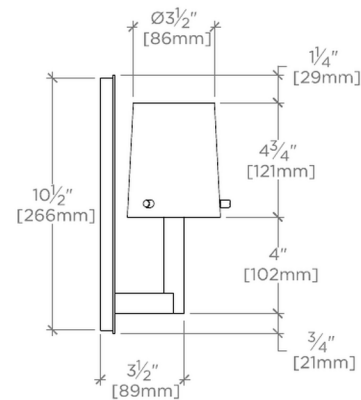

SIDE VIEW SCALE: 1 1/2"=1'-0"