

INSTALLATION GUIDELINES

EXPOSED TUB FILLER

LUDLOW EXPOSED TUB FILLER WITH HANDSHOWER AND HANDLES

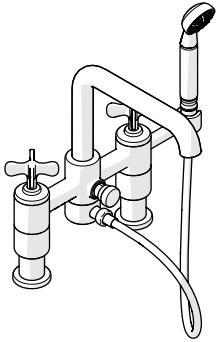

STYLES		
LDXT40 [SHOWN]	LD40XT	LDXT50
LD50XT		

IMPORTANT:

- To ensure this product is installed properly, you must read and follow these guidelines.
- The owner/user of this product must keep this information for future reference.
- This product must be installed by a professional licensed contractor and must be on-site prior to rough-in. This allows the installer to visualize the installation and verify the 8" [203mm] on-center inlet supply spread. The inlet supply spread on this product is **NOT** adjustable.
- Check TUB measurements to ensure the SPOUT project far enough into the TUB.
- Run 3/4" supply lines for **MAXIMUM** flow and install ACCESSIBLE hot and cold service stop valves to facilitate servicing.
- Be sure your installation conforms to federal, state, and local codes.
 - Anti-scaled protection is the responsibility of the installer and according to applicable codes.
 - A water temperature limiting device is the responsibility of the installer and must be in accordance with ASSE 1070.
 - In the State of Massachusetts, all installations must comply with the rules and regulations set forth within 248 CMR.
- Inspect this product to ensure you have all the parts required for proper installation.
- Product is sold partially assembled but shown fully disassembled for illustrative and service purposes only.
- Use only a strap wrench or protected/smooth-jaw wrench on any finished surface.
- The use of certain plumber's putty may stain stone or tile surfaces.

- If further assistance is required, please contact Product Support at 1-800-927-2120 Monday through Friday, 8am - 6pm EST.
- Refer to the separate Service Parts Documents for available replacement parts.

TECHNICAL DETAILS:

DETAIL	SPECIFICATION
DIAMETER OF HANDSHOWER HEAD	2-1/8" [54mm]
DECK THICKNESS MAXIMUM	1-1/2" [38mm]
FITTINGS HOLE DIAMETER	1 1/4" [32 mm]
HANDLE TURN ANGLE	QUARTER TURN
HOSE LENGTH	59" [1.5m]
INLET CONNECTION	3/4" MALE NPT †
INLET SUPPLY SPREAD	8" [203mm] [NOT ADJUSTABLE]
INTEGRATED DIVERTER	YES
SPOUT REACH	8 9/16" [217mm]
WATER PRESSURE MAXIMUM	85psi [6.0 bar]
WATER PRESSURE MINIMUM	20psi [1.5 bar]
WATER PRESSURE RECOMMENDED	45psi [3.0 bar]

† **Style No.** LD40XT and LD50XT are provided with 2 BSPP ADAPTERS. ADAPTERS are packaged separately and assembly is required. Replacement ADAPTERS can be ordered separately:

- Universal 3/4" NPT Female x 3/4" Male BSPP Adapter

Style No. UNUK05

INSTALLATION GUIDELINES

EXPOSED TUB FILLER

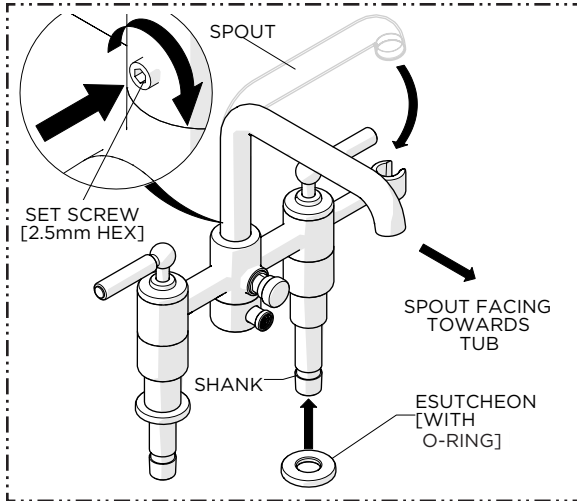

1. Align the SPOUT properly and securely tighten the SET SCREW at the base of the SPOUT then slide the ESCUTCHEONS onto the SHANKS.

NOTE: Do NOT remove the O-RING on the ESCUTCHEONS.

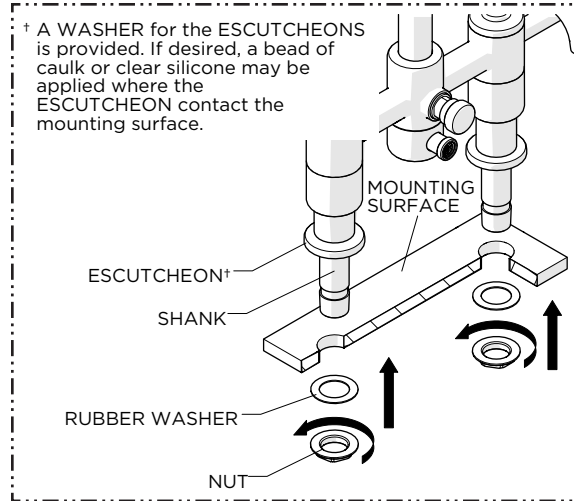

2. Insert the SHANKS into the holes on the mounting surface then attach the RUBBER and METAL WASHERS and NUTS onto the SHANKS. Securely tighten the NUTS against the underside of the mounting surface.

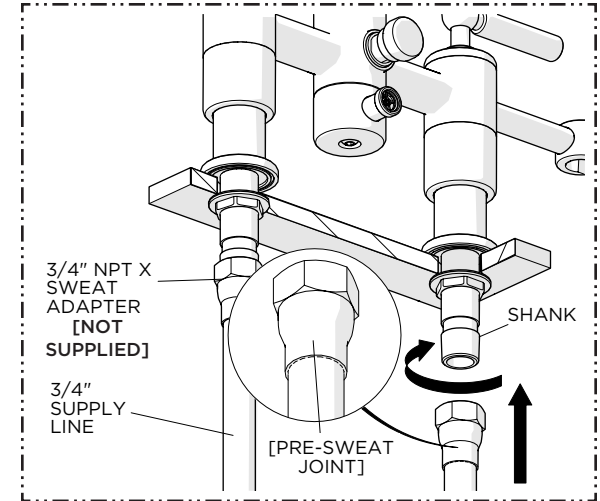

3. Pre-sweat 3/4" female NPT x sweat adapters to 3/4" supply lines and let cool. Apply a thin coat of pipe thread sealant to the male threads on the SHANKS then thread and securely tighten the ADAPTERS onto the SHANKS.

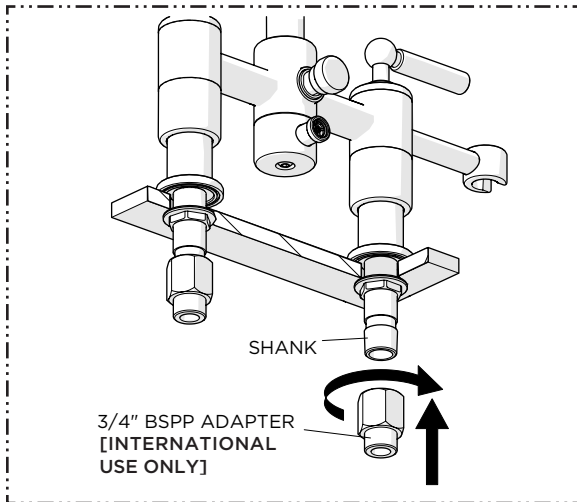

FOR INTERNATIONAL INSTALLATIONS ONLY

4. 3/4" female NPT x 3/4" male BSPP ADAPTERS are provided. Thread and securely tighten the ADAPTERS onto the SHANKS.

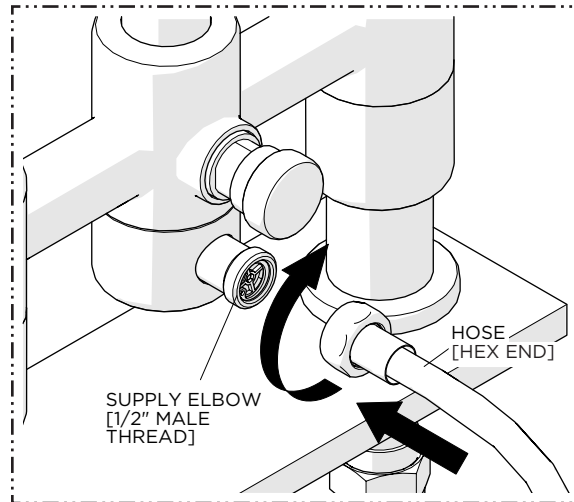

5. Thread the HEX END of the HOSE to the SUPPLY ELBOW on the VALVE BODY.

NOTE: A CHECK VALVE is located inside the outlet of the ELBOW.

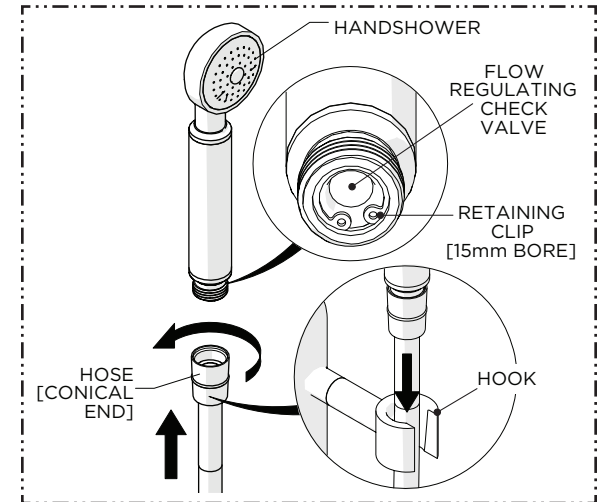

6. Thread the conical end of the HOSE to the HANDSHOWER then rest the HANDSHOWER on the HOOK.

NOTE: A FLOW REGULATING CHECK VALVE is located inside the inlet of the HANDSHOWER.

INSTALLATION GUIDELINES

EXPOSED TUB FILLER

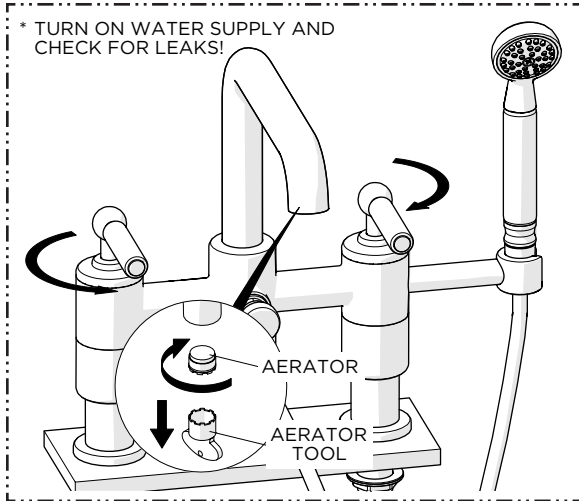

7. Remove the AERATOR using the TOOL provided then turn on the water supply and operate the HANDLES to flush out the supply lines and check all connections for leaks.

NOTE: Ensure the supply lines have been flushed before operating the DIVERTER KNOB.

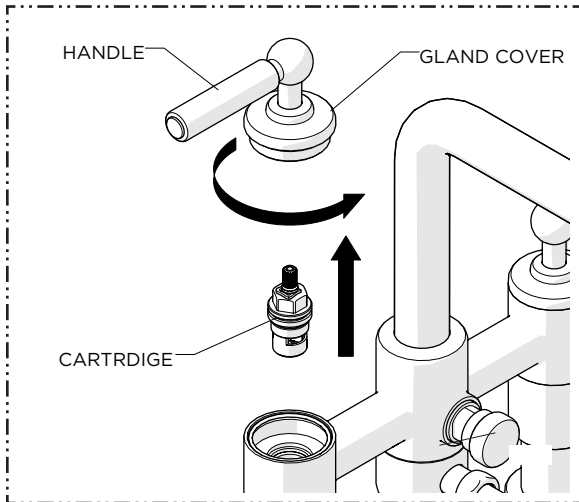

SERVICING THE CARTRIDGE

1. Unthread the GLAND COVER to remove the HANDLE then remove the CARTRIDGE using a 21/32" [17mm] shower valve socket wrench (not supplied).

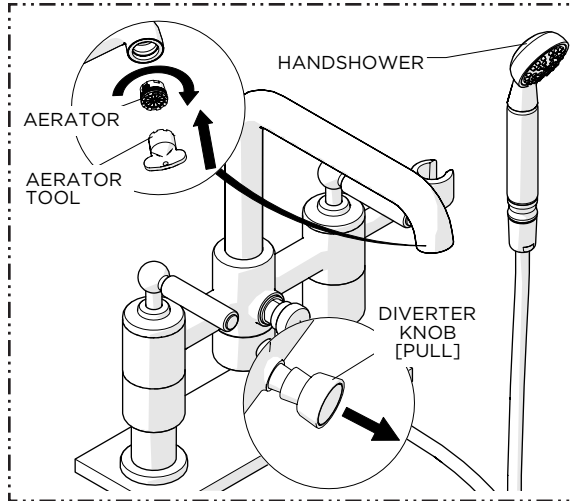

8. With water running, operate the DIVERTER KNOB to ensure it and the HANDSHOWER function properly then turn off the water, and then Re-install the AERATOR.

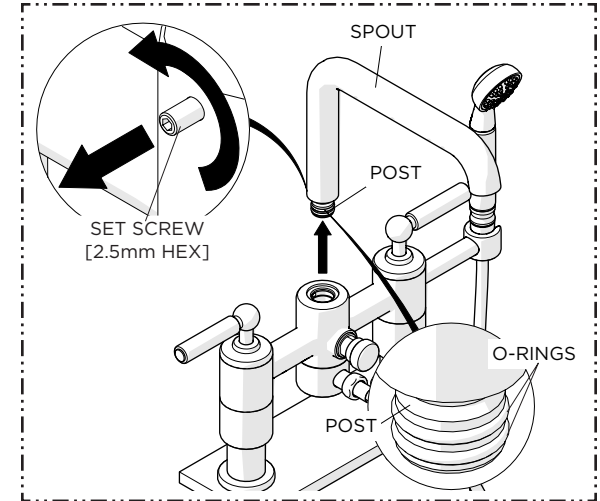

SERVICING THE SPOUT

1. Loosen, but do NOT remove, the SET SCREW at the base of the SPOUT then remove the SPOUT to expose the POST and external O-RINGS

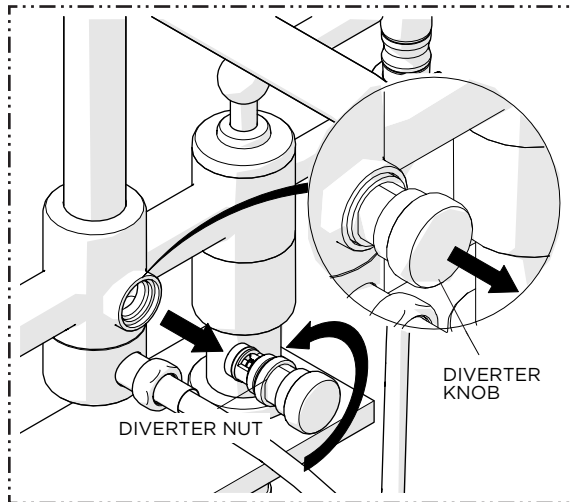

SERVICING THE DIVERTER

1. Pull the DIVERTER KNOB to expose the DIVERTER NUT then unthread and remove the DIVERTER using a 19mm wrench.

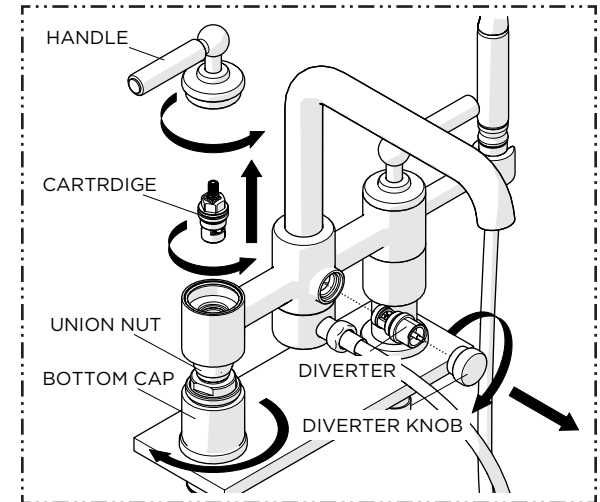

SERVICING THE VALVE BODY

1. If the entire BODY needs to be replaced, unthread BOTTOM CAPS and slide them down the legs to access the UNION CONNECTIONS.