

## HENRY

## HNWH10

Henry 10" Wall Mounted 45 Degree Shower Arm with Flange

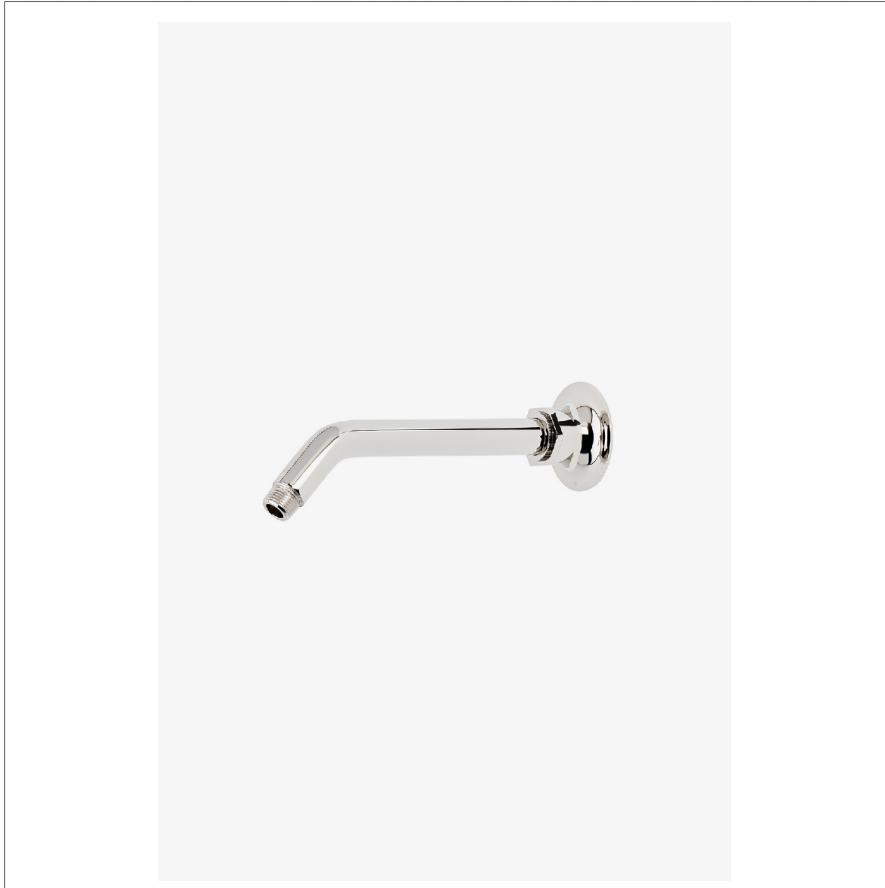

SHOWN IN HENRY 10" WALL MOUNTED 45 DEGREE SHOWER ARM WITH FLANGE | HNWH10

### TECHNICAL DETAILS

Fittings Hole Diameter: 1 1/4"  
Inlet Connection Size: 1/2"  
Inlet Connection Type: Male NPT  
Outlet Connection Size: 1/2"  
Outlet Connection Type: Male NPT  
Water Pressure Recommended: 45.0 psi

### INSPIRATION

Celebrating the connection of industry and art, Henry transitions effortlessly between modern, traditional, and classic settings. These iconic fittings blend 19th-century industrial and artistic references for a look that's forever of the moment—familiar yet wholly original.

### CODES & STANDARDS

### PRODUCT FEATURES

Compatible with an assortment of Waterworks showerheads, sold separately

Brass Construction

Includes 10" wall mounted 45 degree shower arm

Stocked in Chrome, Nickel and Brass

### CERTIFICATIONS

### PRODUCT (NOTES)

HENRY

HNWH10

Henry 10" Wall Mounted 45 Degree Shower Arm with Flange

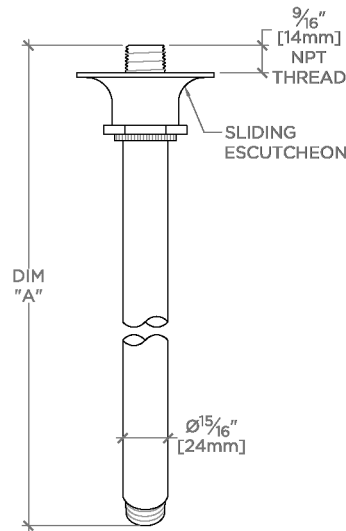

TOP VIEW SCALE: 3"=1'-0"

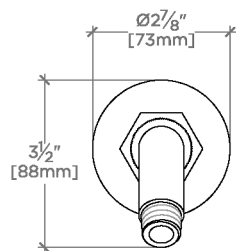

FRONT VIEW SCALE: 3"=1'-0"

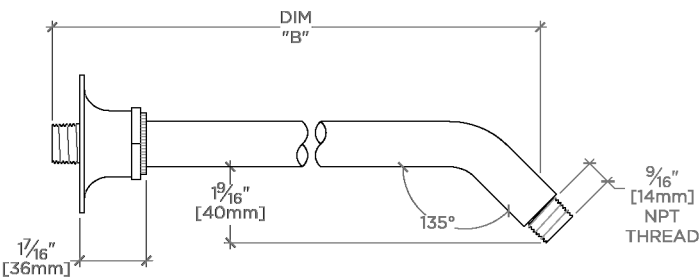

SIDE VIEW SCALE: 3"=1'-0"

| STYLE NO. | DIM "A"                                       | DIM "B"                                     |
|-----------|---|---|
| HNWH06    | 6 <sup>15</sup> / <sub>16</sub> "<br>[176mm]  | 6 <sup>1</sup> / <sub>4</sub> "<br>[158mm]  |
| HNWH08    | 8 <sup>15</sup> / <sub>16</sub> "<br>[226mm]  | 8 <sup>1</sup> / <sub>4</sub> "<br>[209mm]  |
| HNWH10    | 10 <sup>15</sup> / <sub>16</sub> "<br>[277mm] | 10 <sup>1</sup> / <sub>4</sub> "<br>[260mm] |