

WATERWORKS STUDIO

SERVICE PARTS

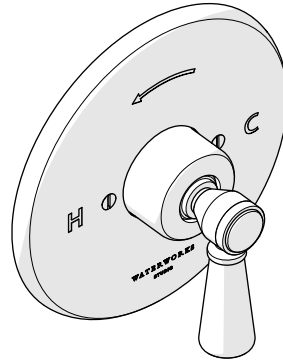

STYLE HGPB10

Highgate Pressure Balance Control Valve Trim with White Porcelain Lever Handles

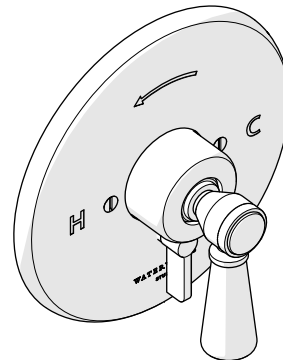

STYLE HGPB30

Highgate Pressure Balance with Diverter Trim with White Porcelain Lever Handles

WELCOME TO

WATERWORKS STUDIO

Over thirty years of experience distilled into signature fittings, surfaces, textiles, and accessories. Waterworks Studio is an edited collection of design solutions curated to be concise, engineered to be complete, and crafted for quality.

Everything you need, nothing more.

**TO ORDER PARTS CALL
1 (800) 927-2120 (EXT 2)**

Order by part number and specify color, finish, or other options if required.

Product Support

Our Product Support team provides troubleshooting and technical problem resolution, including replacement parts and installation recommendations throughout the life of your product.

Product Support is available Monday through Friday 8AM to 6PM EST.

**LIMITED LIFETIME
WARRANTY**

Our warranty covers repair and replacement of Waterworks products if within the applicable coverage period and deemed defective by Waterworks. Waterworks will, at its option, repair or replace such products; this does not include installation costs, labor charges, or other incidental or consequential costs.

To obtain your complete warranty or inquire about warranty service, please visit us at www.waterworks.com or contact our Product Support Team.

MAIN KITS

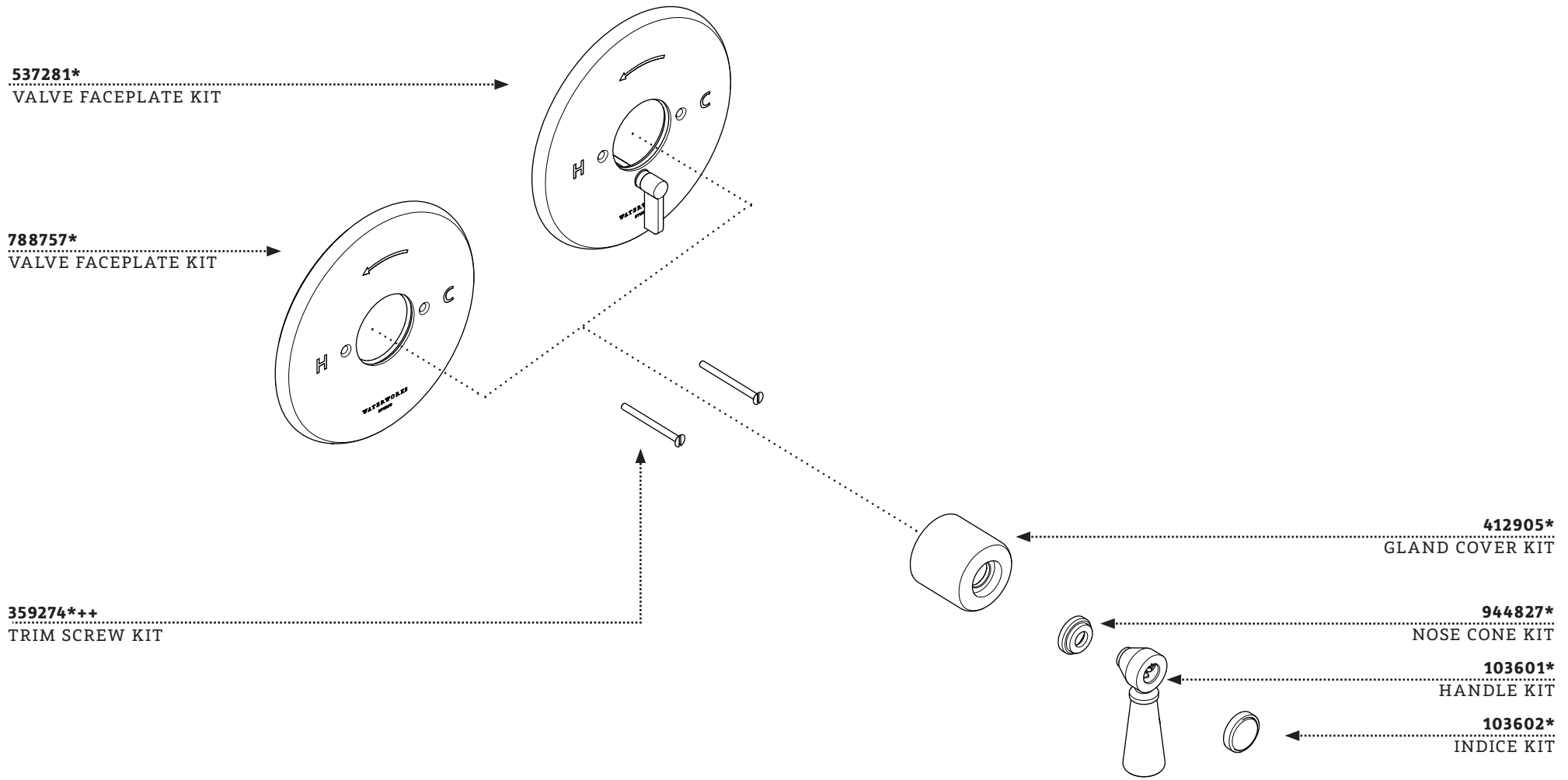

537281*
VALVE FACEPLATE KIT

788757*
VALVE FACEPLATE KIT

359274*++
TRIM SCREW KIT

412905*
GLAND COVER KIT

944827*
NOSE CONE KIT

103601*
HANDLE KIT

103602*
INDICE KIT

KIT COMPONENTS

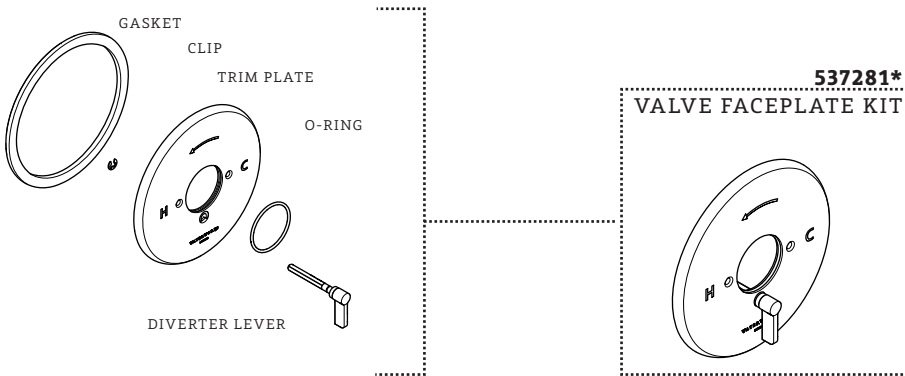
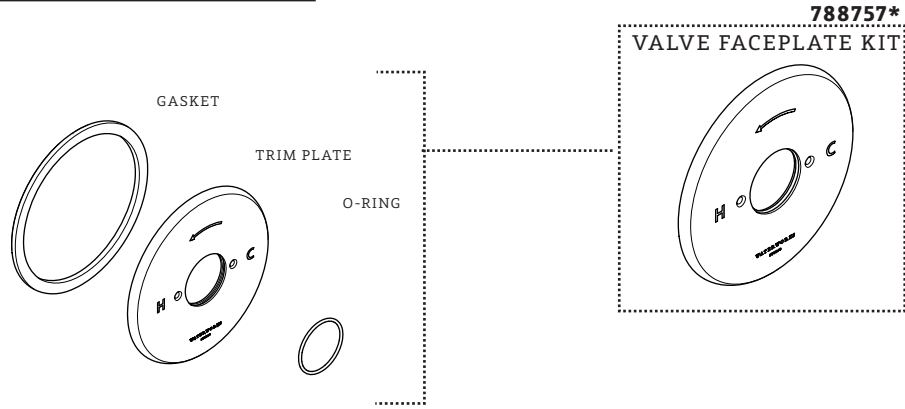

KIT COMPONENTS

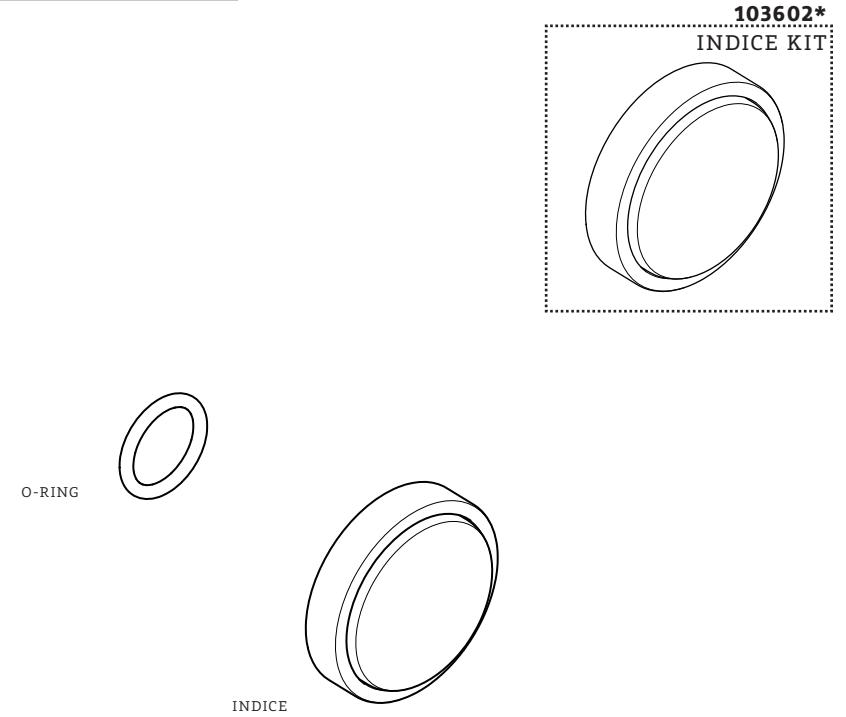

KIT COMPONENTS



HANDLE

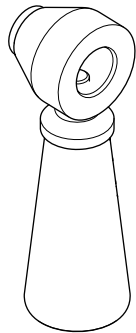

*FINISH/COLOR MUST BE SPECIFIED WHEN ORDERING
++SUPPLIED AS A PAIR

SERVICE PARTS INDEX

<u>STYLE</u>	<u>DESCRIPTION</u>	<u>PG</u>
412905*	GLAND COVER KIT	3
103601*	HANDLE KIT	6
224846	HANDLE SCREW KIT	6
103602*	INDICE KIT	5
944827*	NOSE CONE KIT	3
359274*++	TRIM SCREW KIT	2
537281*	VALVE FACEPLATE KIT	4
788757*	VALVE FACEPLATE KIT	4



WATERWORKS
STUDIO

PRODUCT SUPPORT
60 BACKUS AVENUE
DANBURY, CT 06810
1 (800) 927-2120 (EXT 2)
WWW.WATERWORKS.COM/STUDIO