

## HENRY

HNWH06

Henry 6" Wall Mounted 45 Degree Shower Arm with Flange

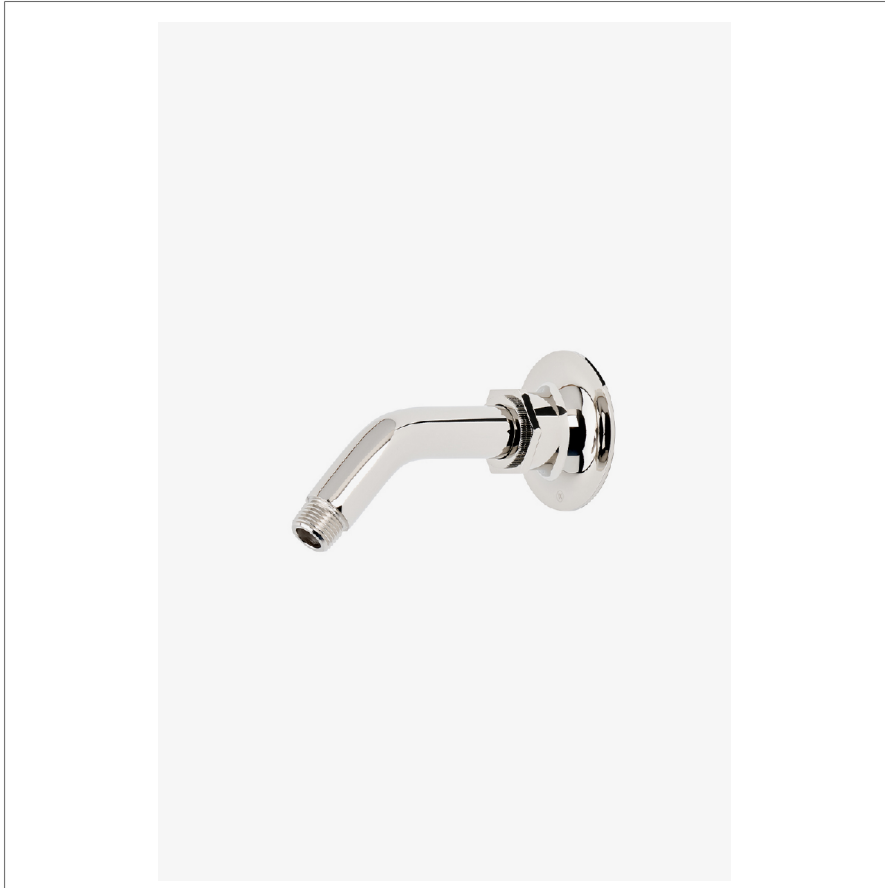

SHOWN IN HENRY 6" WALL MOUNTED 45 DEGREE SHOWER ARM WITH FLANGE | HNWH06

### TECHNICAL DETAILS

Fittings Hole Diameter: 1 1/4"  
Inlet Connection Size: 1/2"  
Inlet Connection Type: Male NPT  
Outlet Connection Size: 1/2"  
Outlet Connection Type: Male NPT  
Water Pressure Recommended: 45.0 psi

### INSPIRATION

Influenced by the connection of industry and art Henry easily transitions between modern, traditional, utilitarian and classic settings.

### CODES & STANDARDS

### PRODUCT FEATURES

Compatible with an assortment of Waterworks showerheads, sold separately

Brass Construction

Includes 6" wall mounted 45 degree shower arm

Stocked in Chrome, Nickel and Brass

### CERTIFICATIONS

### PRODUCT (NOTES)

HENRY

HNWH06

Henry 6" Wall Mounted 45 Degree Shower Arm with Flange

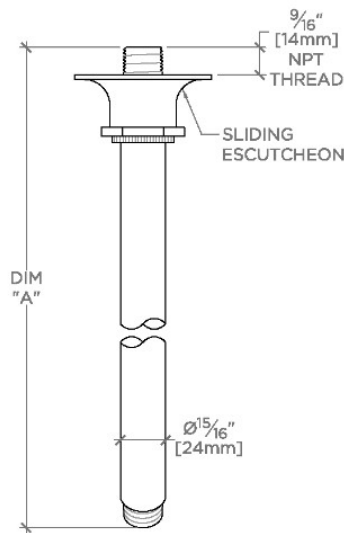

TOP VIEW SCALE: 3"=1'-0"

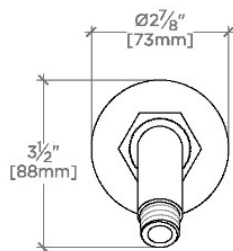

FRONT VIEW SCALE: 3"=1'-0"

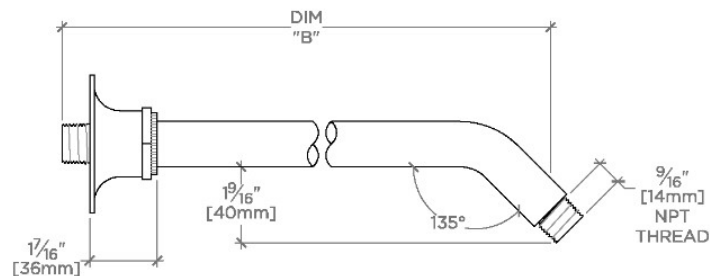

SIDE VIEW SCALE: 3"=1'-0"

STYLE NO.	DIM "A"	DIM "B"
HNWH06	6 <sup>15</sup> / <sub>16</sub> " [176mm]	6 <sup>1</sup> / <sub>4</sub> " [158mm]
HNWH08	8 <sup>15</sup> / <sub>16</sub> " [226mm]	8 <sup>1</sup> / <sub>4</sub> " [209mm]
HNWH10	10 <sup>15</sup> / <sub>16</sub> " [277mm]	10 <sup>1</sup> / <sub>4</sub> " [260mm]