

## Henry

HNLS10

Henry Low Profile Three Hole Deck Mounted Lavatory Faucet  
with Metal Lever Handles



SHOWN IN HENRY LOW PROFILE THREE HOLE DECK MOUNTED LAVATORY FAUCET WITH METAL LEVER HANDLES | HNLS10

## TECHNICAL DETAILS

ADA Compliance: Yes  
Adjustable Versus Fixed Spray: Fixed Spray  
Deck Thickness Maximum: 41 mm  
Deck Thickness Minimum: 5 mm  
Depth/Width: 194 mm  
Drain Depth Maximum: 67 mm  
Drain Depth Minimum: 10 mm  
Drain Hole Diameter: 44 mm  
Escutcheon Primary Material: Brass  
Fittings Hole Diameter: 32 mm  
Handle Spread Maximum: 305 mm  
Handle Spread Minimum: 203 mm  
Handle Turn Angle: Quarter Turn  
Height: 92 mm  
Inlet Connection Size: 1/2"  
Inlet Connection Type: Male with Supply Nut  
Inlet Supply Spread Maximum: 305 mm  
Inlet Supply Spread Minimum: 203 mm  
Installation Type: Deck Mounted  
Integrated Diverter: N  
Integrated Spray: N  
Number Of Handles: Two  
Number Of Holes: Three Hole  
Primary Material: Brass  
Restricted Maximum Flow Rate: 4.5 liters/min  
Spout Swivel: N  
Spray Included In Unit: N  
Suggested Application: Bath  
Valve Material: Ceramic  
Water Pressure Maximum: 6.0 bar  
Water Pressure Minimum: 1.5 bar  
Water Pressure Recommended: 3.0 bar

## INSPIRATION

Influenced by the connection of industry and art Henry easily transitions between modern, traditional, utilitarian and classic settings.

## CODES &amp; STANDARDS

NSF/ANSI/CAN 61:Q < 1, ASME A112.18.1/CSA B125.1,  
CEC, State of MA

## PRODUCT FEATURES

Metal lever handles

Includes European size push touch drain

The manufacturing process encompasses casting, turning, forging, hand-fitting and hand polishing.

Stocked in Chrome, Nickel, Matte Nickel, and Unlacquered Brass

Available in 1.2gpm (4.5L/min) flow rate

## CERTIFICATIONS



## PRODUCT (NOTES)

## Henry

HNLS10

Henry Low Profile Three Hole Deck Mounted Lavatory Faucet  
with Metal Lever Handles

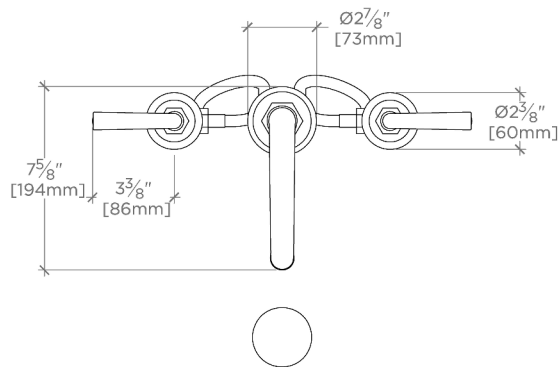

TOP VIEW

SCALE: 1 1/2"=1'-0"

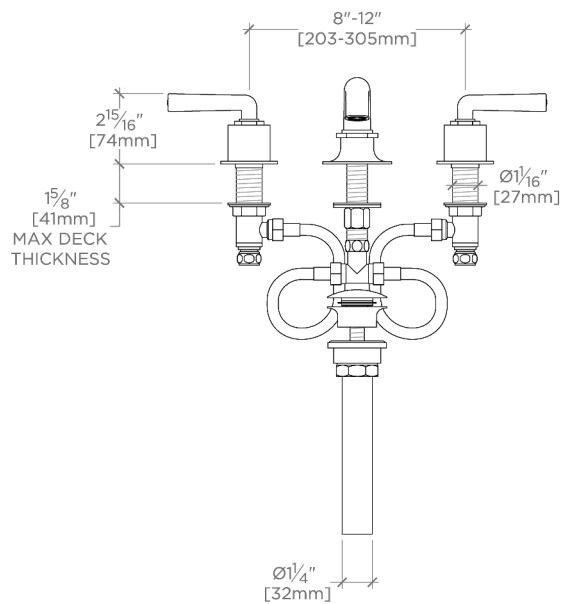

FRONT VIEW

SCALE: 1 1/2"=1'-0"

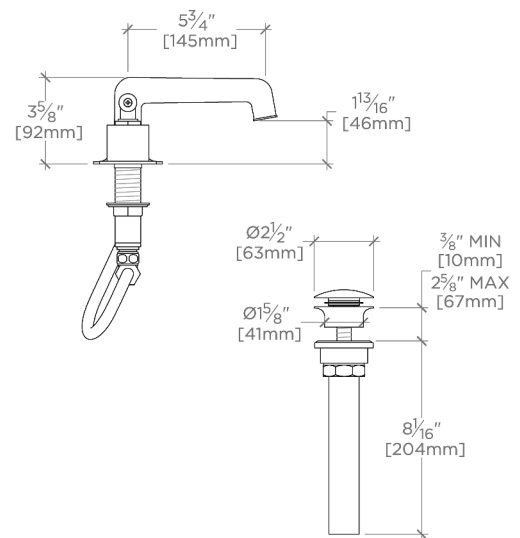

SIDE VIEW

SCALE: 1 1/2"=1'-0"