

## Henry Chronos

CNVC11

Henry Chronos Volume Control with Lever Handle

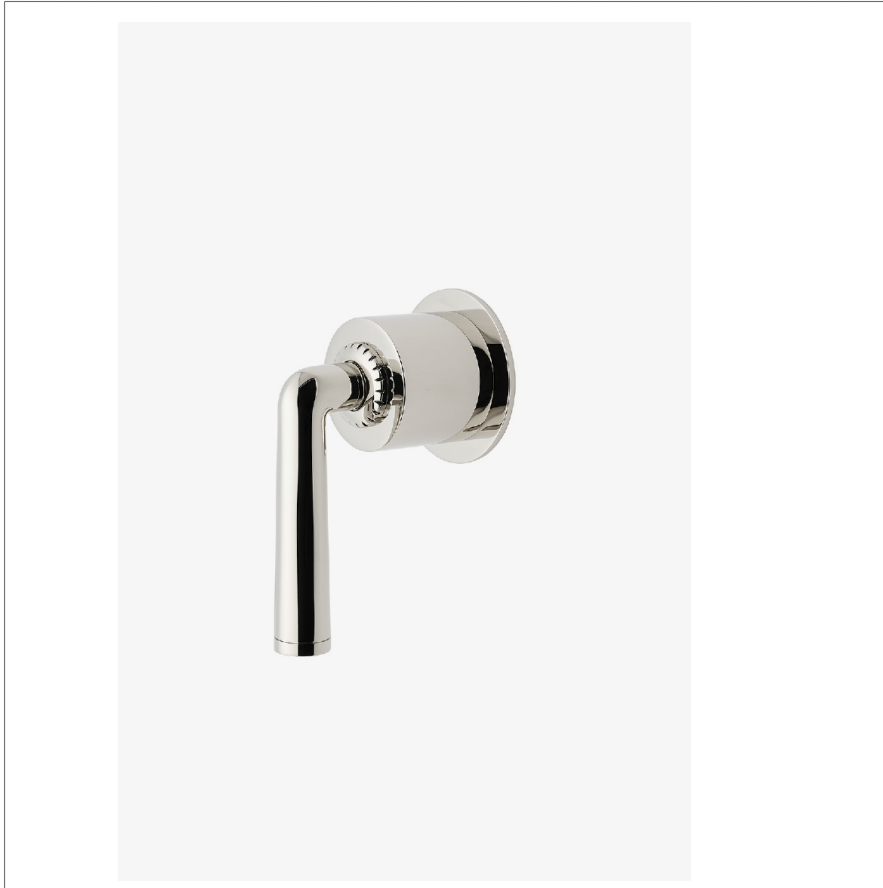

SHOWN IN HENRY CHRONOS VOLUME CONTROL WITH LEVER HANDLE | CNVC11

### TECHNICAL DETAILS

ADA Compliance: Yes  
Fittings Hole Diameter: 35 mm  
Handle Turn Angle: Quarter Turn  
Number Of Holes: One Hole  
Primary Material: Brass

### INSPIRATION

Inspired by dive watches, Henry Chronos radiates design prowess and technical precision. Chronos retains the design integrity of our original, iconic Henry collection, while imbuing it with modern details and exquisite materials.

### CODES & STANDARDS

ASME A112.18.1/CSA B125.1, State of MA

### PRODUCT FEATURES

Features All Metal Lever Handle

Used to Control Water Flow to a Single Waterway Outlet

Stocked in Brass, Chrome and Nickel

Requires Rough Valve, Sold Separately: GUV18/GUV19 or GUV16 /GUV17

### CERTIFICATIONS



### PRODUCT (NOTES)

## Henry Chronos

CNVC11

Henry Chronos Volume Control with Lever Handle

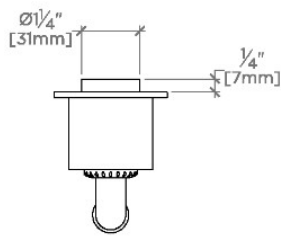

TOP VIEW SCALE: 3"=1'-0"

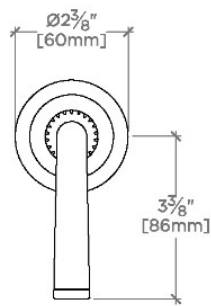

FRONT VIEW SCALE: 3"=1'-0"

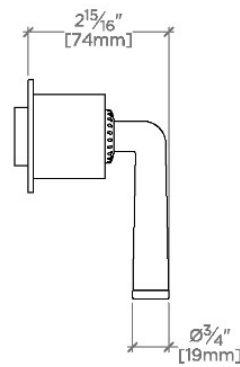

SIDE VIEW SCALE: 3"=1'-0"