

UNIVERSAL

UN2PM1

Universal Two Way Diverter Valve Trim for Pressure Balance with Modern Dots

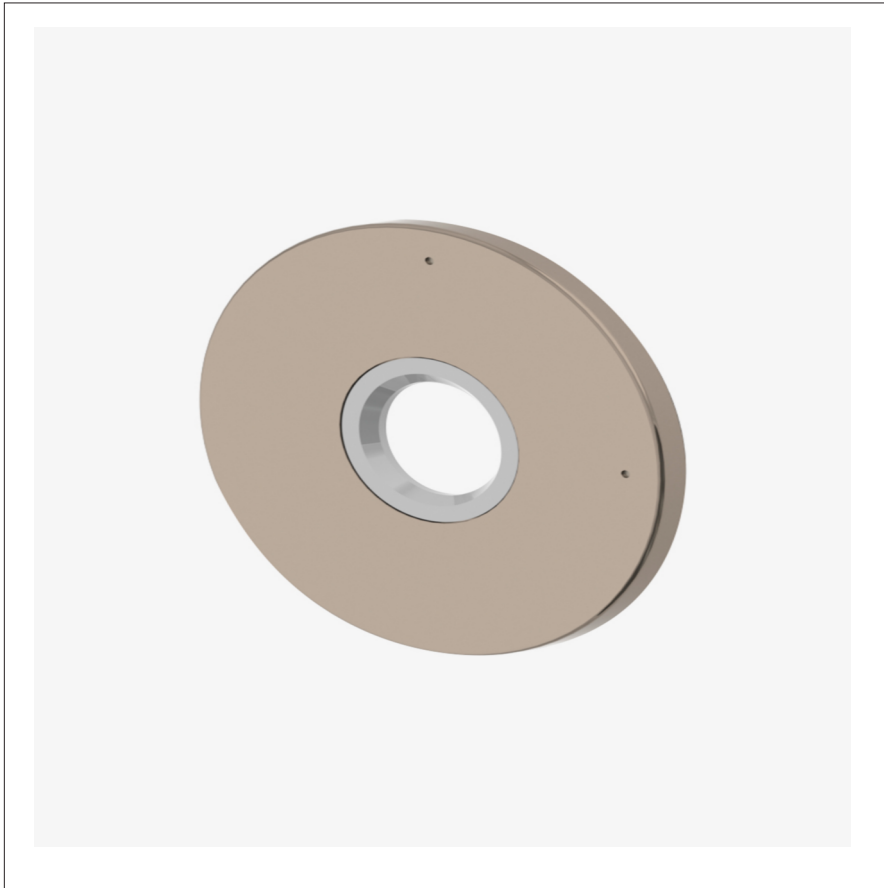

SHOWN IN UNIVERSAL TWO WAY DIVERTER VALVE TRIM FOR PRESSURE BALANCE WITH MODERN DOTS| UN2PM1

TECHNICAL DETAILS

ADA Compliance: Yes
Depth / Width: 5 mm
Height: 95 mm
Length: 95 mm
Primary Material: Brass
Suggested Application: Bath

INSPIRATION

Our Universal collection features timeless designs complementing any of our Waterworks. With a wide range of product, from fittings to accessories, Universal adds exquisite proportion and balance to any environment.

PRODUCT FEATURES

Allows water to be switched between two different water features such as a shower head and handshower

For use with all Waterworks families of diverter handle trims

Shower head and Handshower icons correspond to the handle position. Custom icons are also available as special order

Configured without shutoff position

UNIVERSAL

UN2PM1

Universal Two Way Diverter Valve Trim for Pressure Balance with Modern Dots

