

REGULATOR

RGWH10

Regulator 10" Wall Mounted 45 Degree Shower Arm with Flange

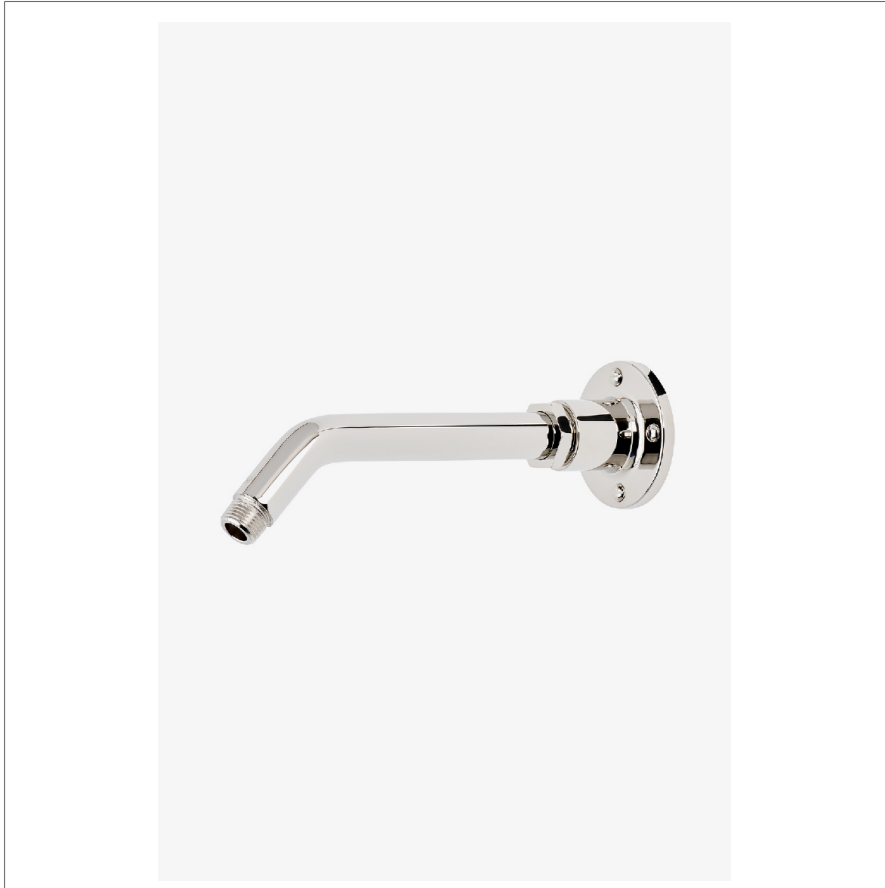

SHOWN IN REGULATOR 10" WALL MOUNTED 45 DEGREE SHOWER ARM WITH FLANGE | RGWH10

TECHNICAL DETAILS

Fittings Hole Diameter: 1 1/4"
Inlet Connection Size: 1/2"
Inlet Connection Type: Male NPT
Outlet Connection Size: 1/2"
Outlet Connection Type: Male NPT
Water Pressure Recommended: 45.0 psi

INSPIRATION

With striking scale and unique design, Regulator commands attention through its tribute to early 20th-century boiler room controls, when pride was lavished on hard-built parts. Each handcrafted fitting brings dramatic beauty through powerful proportions and honest details.

CODES & STANDARDS

PRODUCT FEATURES

Compatible with an assortment of Waterworks showerheads, sold separately

Brass Construction

Includes 10" wall mounted 45 degree shower arm

Stocked in Chrome, Nickel and Brass

CERTIFICATIONS

PRODUCT (NOTES)

REGULATOR

RGWH10

Regulator 10" Wall Mounted 45 Degree Shower Arm with Flange

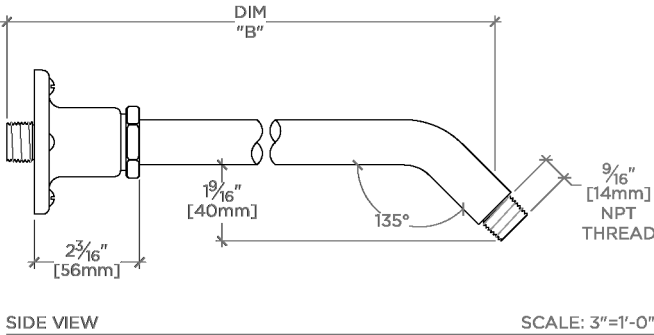
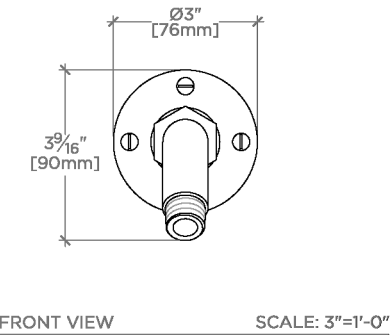
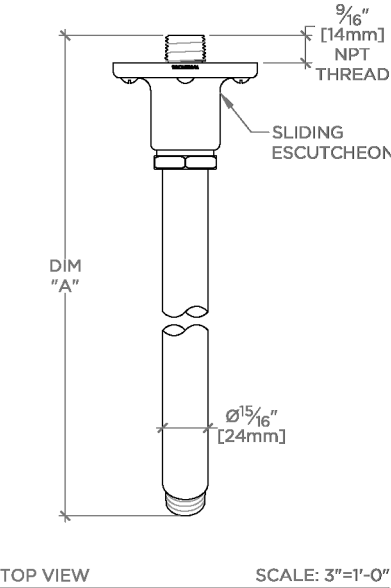

STYLE NO.	DIM "A"	DIM "B"
RGWH06	$6\frac{15}{16}$ " [176mm]	$6\frac{1}{4}$ " [158mm]
RGWH08	$8\frac{15}{16}$ " [226mm]	$8\frac{3}{4}$ " [209mm]
RGWH10	$10\frac{15}{16}$ " [277mm]	$10\frac{1}{4}$ " [260mm]