

Formwork

FMS26W

Formwork 6" Showerhead with 10" Wall Mounted 90 Degree Shower Arm



SHOWN IN FORMWORK 6" SHOWERHEAD WITH 10" WALL MOUNTED 90 DEGREE SHOWER ARM | FMS26W

TECHNICAL DETAILS

Adjustable Versus Fixed Spray: Fixed
Fittings Hole Diameter: 32 mm
Flow Restriction Options: 1.5, 1.75, 2.0
Inlet Connection Size: 1/2"
Inlet Connection Type: Male NPT
Pivot: Y
Primary Material: Brass
Restricted Maximum Flow Rate: 6.6 liters/min
Water Pressure Maximum: 6.0 bar
Water Pressure Minimum: 1.5 bar
Water Pressure Recommended: 3.0 bar

INSPIRATION

Sculptural forms that defy the ordinary. Unexpected geometry and the transition of the planes create a subtle but warm expression.

CODES & STANDARDS

FMS26WX, ASME A112.18.1/CSA B125.1, CEC(1.5GPM & 1.75GPM Only), WaterSense(1.5GPM, 1.75GPM & 2.0GPM Only), DOE, State of MA

PRODUCT FEATURES

Made of Brass

Features a swivel 6" showerhead with easy clean rubber nozzles

Includes a 10" wall mounted 45 degree shower arm

Stocked in Brass, Chrome and Nickel

Showerhead available in 1.75gpm (6.6L/min) flow rate

CERTIFICATIONS



PRODUCT (NOTES)

Formwork

FMS26W

Formwork 6" Showerhead with 10" Wall Mounted 90 Degree Shower Arm

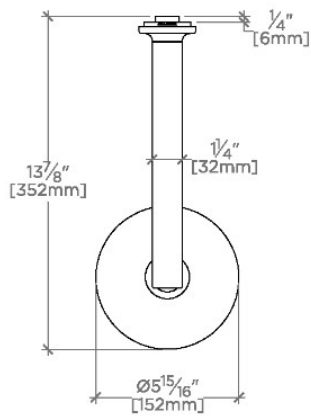

TOP VIEW SCALE: 1/2"=1'-0"

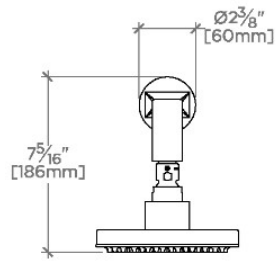

FRONT VIEW SCALE: 1/2"=1'-0"

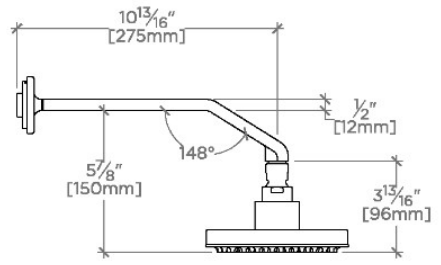

SIDE VIEW SCALE: 1/2"=1'-0"