

WATT

WLLT05

Watt II Wall Mounted Single Arm Sconce with Glass Shade



SHOWN IN WATT II WALL MOUNTED SINGLE ARM SCONCE WITH GLASS SHADE | WLLT05

TECHNICAL DETAILS

Bulb Base Size: E26
Bulb Type: Edison Filament
Depth/Width: 5 5/8"
Height: 10"
Interior Exterior Application: Interior Only
Junction Box Orientation: Any
Length: 4 15/16"
Number Of Bulbs: One
Voltage: 120V

INSPIRATION

Inspired by the countless shapes and colors of telephone pole insulator covers, the Watt collection features two styles of large scale boron molded glass shades in clear, amber or blue. The Watt II collection features a smaller scale molded glass shade available in clear. They are an original interpretation of a vintage form and available in sconces or pendants.

CODES & STANDARDS

UL and CUL

PRODUCT FEATURES

Solid brass and boron molded glass

Proprietary design

Uses (1) 60W Max Edison Filament Style, E26 Base Bulb (not included)

CERTIFICATIONS



PRODUCT (NOTES)

WATT

WLLT05

Watt II Wall Mounted Single Arm Sconce with Glass Shade

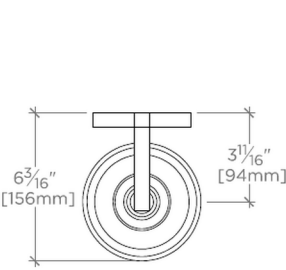

TOP VIEW SCALE: 1 1/2"=1'-0"

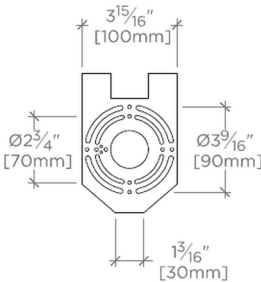

MOUNTING PLATE SCALE: 1 1/2"=1'-0"

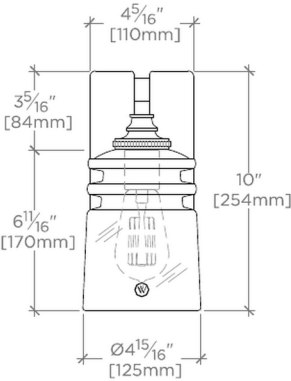

FRONT VIEW SCALE: 1 1/2"=1'-0"

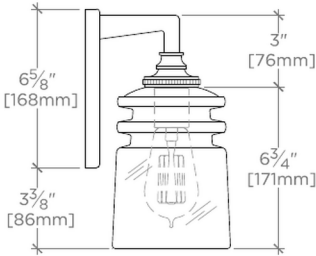

SIDE VIEW SCALE: 1 1/2"=1'-0"