

R.W. Atlas 5" Pull

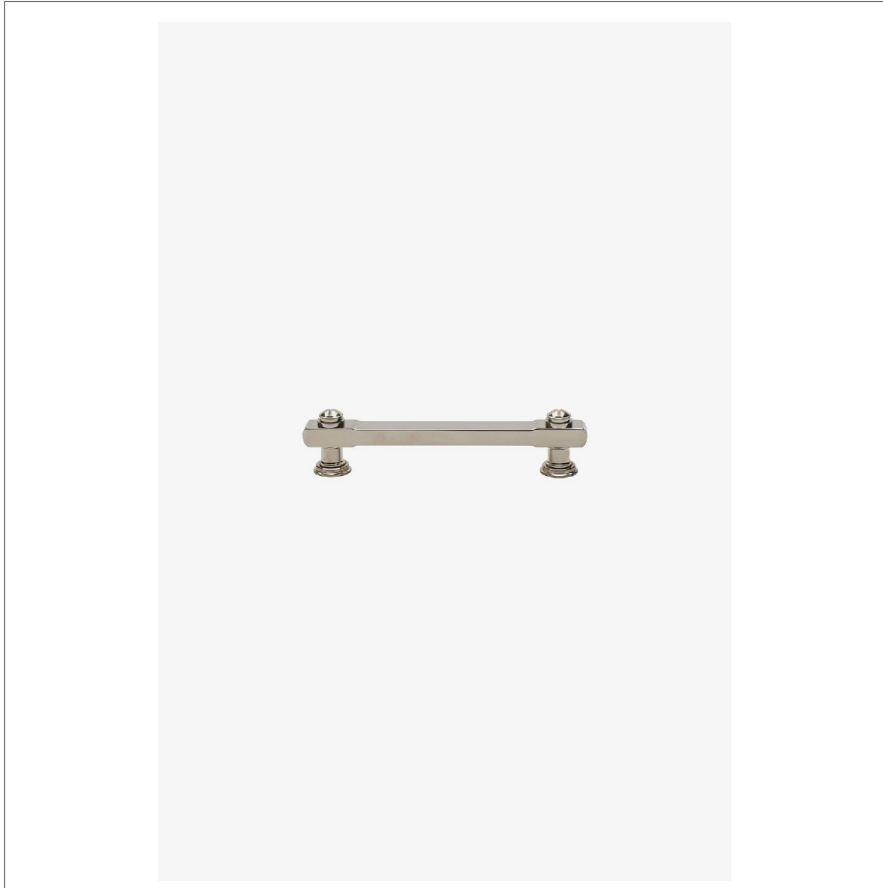

SHOWN IN R.W. ATLAS 5" PULL | RWHW04

TECHNICAL DETAILS

Depth/Width: 1"
Hardware Primary Material: Brass
Hardware Shape: Knob
Height: 13/16"
Length: 6 1/4"
Primary Material: Brass
Suggested Application: All Applications

INSPIRATION

Powerful shapes, exquisite materials, and unique aesthetic details define R.W. Atlas. This groundbreaking collection pairs American ingenuity with European craftsmanship, delivering refined industrial-inspired character that fits seamlessly into any space.

CODES & STANDARDS

PRODUCT FEATURES

Solid Brass

Machined and hand-polished

Made in Portugal

Includes 2 x M4 Pan Head Slot 1" Machine Screw and 2 x M4 Pan Head Slot 1 1/2" Machine Screw

CERTIFICATIONS

Replacement Screws available
PRODUCT (NOTES)

R.W. Atlas 5" Pull

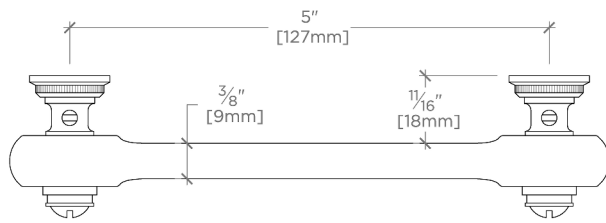

TOP VIEW

SCALE: 6"=1'-0"

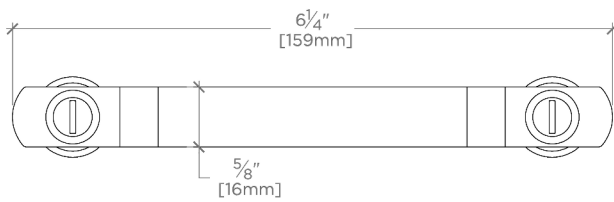

FRONT VIEW

SCALE: 6"=1'-0"

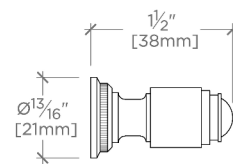

SIDE VIEW

SCALE: 6"=1'-0"