

Normandy

NOSK25

Normandy 14 15/16" x 11 7/16" x 5 11/16" Hammered Copper Bar Sink with Center Drain



SHOWN IN NORMANDY 14 15/16" X 11 7/16" X 5 11/16" HAMMERED COPPER BAR SINK WITH CENTER DRAIN | NOSK25

TECHNICAL DETAILS

ADA Compliance: When installed per ADA guidelines
Bowl Shape: Rectangular
Depth/Width: 291 mm
Drain Hole Depth: 5 mm
Drain Hole Diameter: 51 mm
Drain Style: Center Drain
Garbage Disposal: N
Height: 144 mm
Installation Type: Drop In or Undermount
Length: 379 mm
Number Of Holes: One Hole
Outer Rim Shape: Rectangular
Primary Material: Hammered Copper
Sound Proofing: N
Suggested Application: Bar, Kitchen, Laundry

INSPIRATION

Modeled after antique French copper cookware, each Normandy sink is hammered and polished by hand according to old French tradition. The process involves over 40 steps and countless hours of craftsmanship, creating strikingly authentic, one-of-a-kind designs.

CODES & STANDARDS

PRODUCT FEATURES

16 Gauge lead free pure red copper

Hand Hammered and hand polished

All Normandy kitchen sinks with 3 1/2" drain can be used with garbage disposals or 3 1/2" kitchen drain(UNKS30). Bar sinks require 2 1/2" bar drains(UNKS15).

A copper sink will patina and age to a unique, individual appearance which reflects its handmade heritage.

CERTIFICATIONS

Dimensions of sinks are nominal and are subject to slight variation.
PRODUCT (NOTES)

Normandy

NOSK25

Normandy 14 15/16" x 11 7/16" x 5 11/16" Hammered
Copper Bar Sink with Center Drain

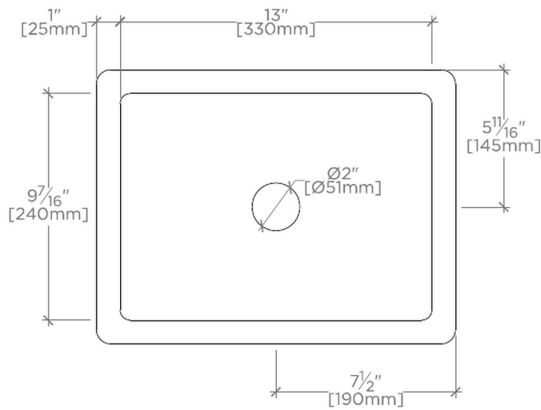

TOP VIEW SCALE: 1/2"=1'-0"

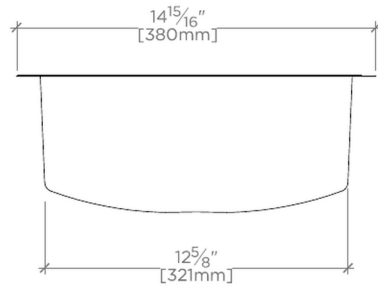

FRONT VIEW SCALE: 1/2"=1'-0"

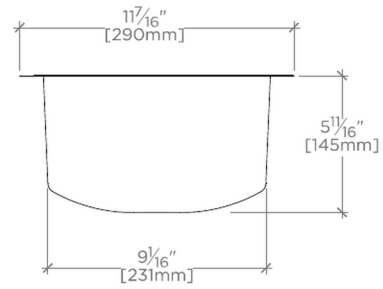

SIDE VIEW SCALE: 1/2"=1'-0"