

## NORMANDY

NOSK25

Normandy 14 15/16" x 11 7/16" x 5 11/16" Hammered Copper Bar Sink with Center Drain

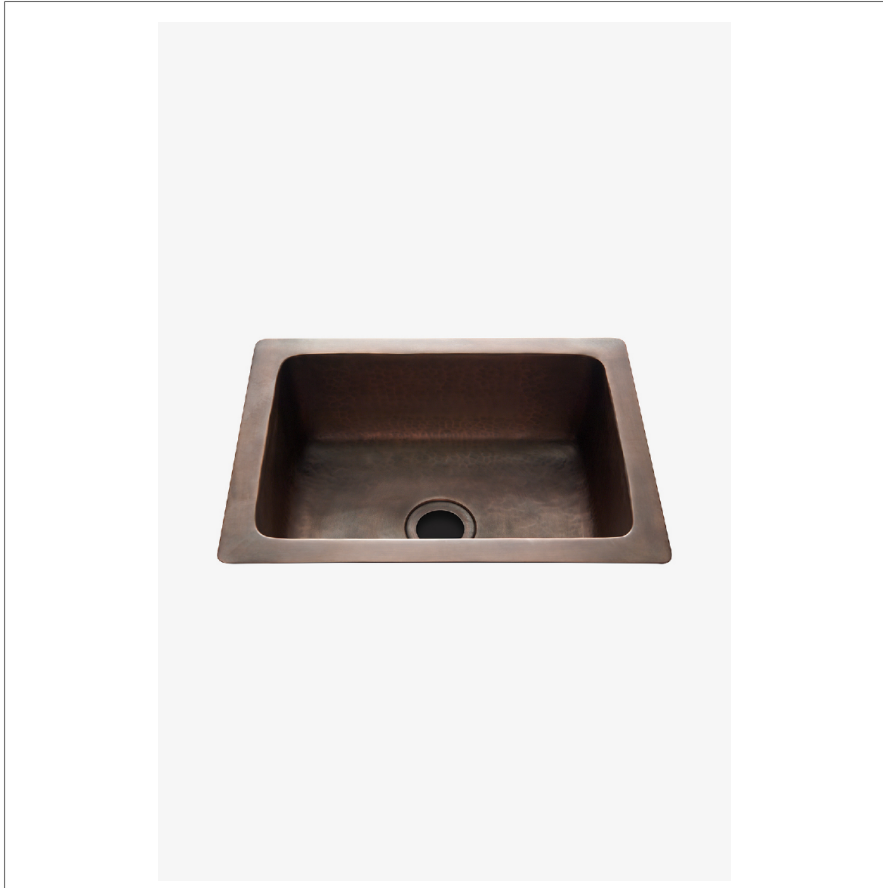

SHOWN IN NORMANDY 14 15/16" X 11 7/16" X 5 11/16" HAMMERED COPPER BAR SINK WITH CENTER DRAIN | NOSK25

### TECHNICAL DETAILS

ADA Compliance: When installed per ADA guidelines  
 Bowl Shape: Rectangular  
 Depth/Width: 11 7/16"  
 Drain Hole Depth: 3/16"  
 Drain Hole Diameter: 2"  
 Drain Style: Center Drain  
 Garbage Disposal: N  
 Height: 5 11/16"  
 Installation Type: Drop In or Undermount  
 Length: 14 15/16"  
 Number Of Holes: One Hole  
 Outer Rim Shape: Rectangular  
 Primary Material: Hammered Copper  
 Sound Proofing: N  
 Suggested Application: Bar, Kitchen, Laundry

### INSPIRATION

Like the antique French copper cookware that inspired them, our Normandy sinks lend a special warmth and richness to any environment. Each pure red copper design is hammered and polished by hand according to the old French tradition.

### CODES & STANDARDS

### PRODUCT FEATURES

16 Gauge lead free pure red copper

Hand Hammered and hand polished

All Normandy kitchen sinks with 3 1/2" drain can be used with garbage disposals or 3 1/2" kitchen drain(UNKS30). Bar sinks require 2 1/2" bar drains(UNKS15).

A copper sink will patina and age to a unique, individual appearance which reflects its handmade heritage.

### CERTIFICATIONS

Dimensions of sinks are nominal and are subject to slight variations.  
**PRODUCT (NOTES)**

## NORMANDY

NOSK25

Normandy 14 15/16" x 11 7/16" x 5 11/16" Hammered  
Copper Bar Sink with Center Drain

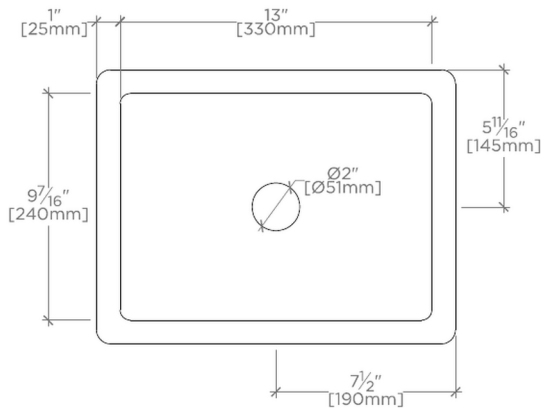

TOP VIEW

SCALE: 1 1/2" = 1'-0"

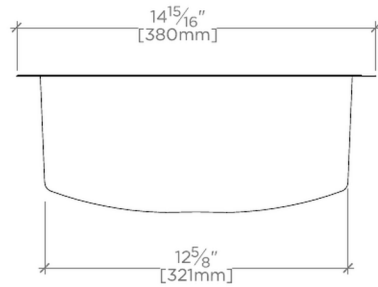

FRONT VIEW

SCALE: 1 1/2" = 1'-0"

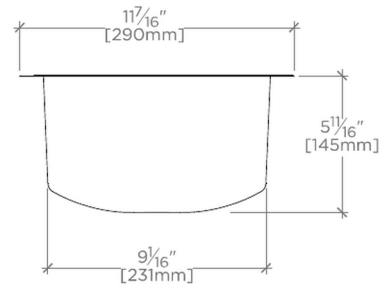

SIDE VIEW

SCALE: 1 1/2" = 1'-0"