

## HENRY

HTH412

Henry Integrated Thermostatic and Two Way Diverter Trim with Two Tone Cross and Lever Handles

### TECHNICAL DETAILS

ADA Compliance: Yes  
Fittings Hole Diameter: 2 1/2"  
Integrated Diverter: Y  
Number Of Holes: Two Hole  
Primary Material: Brass



SHOWN IN HENRY INTEGRATED THERMOSTATIC AND TWO WAY DIVERTER TRIM WITH TWO TONE CROSS AND LEVER HANDLES | HTH412

### INSPIRATION

Influenced by the connection of industry and art Henry easily transitions between modern, traditional, utilitarian and classic settings.

### CODES & STANDARDS

ASME A112.18.1/CSA B125.1, State of MA

### PRODUCT FEATURES

Two-Tone Cross and Lever Handles

Allows bather to adjust temperature of all waterway outlets with a hot limit safety stop providing anti-scald protection

Stocked in Brass/Dark Nickel and Nickel/Dark Nickel

Requires valve rough sold separately

### CERTIFICATIONS



### PRODUCT (NOTES)

## HENRY

HTH412

Henry Integrated Thermostatic and Two Way Diverter Trim  
with Two Tone Cross and Lever Handles

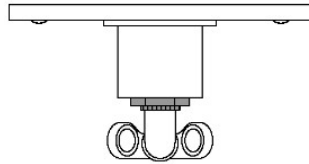

TOP VIEW

SCALE: 3"=1'-0"

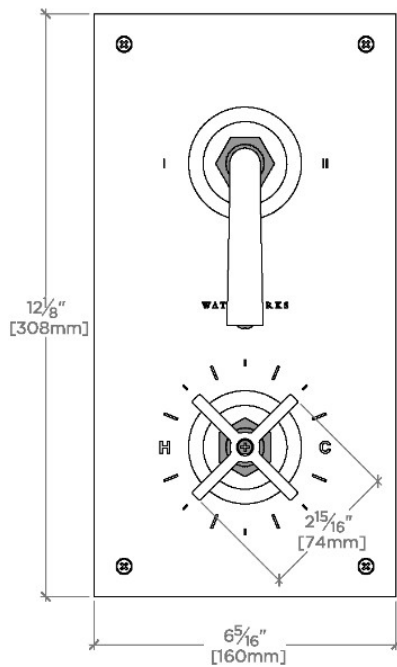

FRONT VIEW

SCALE: 3"=1'-0"

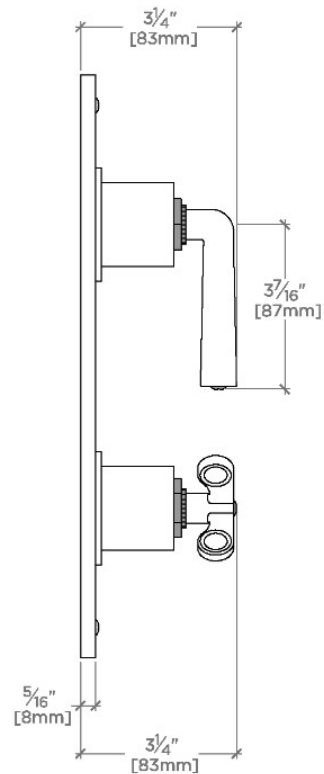

SIDE VIEW

SCALE: 3"=1'-0"