

VIAWORKS

GUPB87

ViaWorks 1/2" Pressure Balance Valve with Integrated Diverter for Tub/Shower Combination



SHOWN IN VIAWORKS 1/2" PRESSURE BALANCE VALVE WITH INTEGRATED DIVERTER FOR TUB/SHOWER COMBINATION | GUPB87

TECHNICAL DETAILS

ADA Compliance: Yes
 Depth/Width: 5 3/4"
 Fittings Hole Diameter: 3 1/2"
 Height: 3 3/4"
 Inlet Connection Size: 1/2"
 Inlet Connection Type: Copper Sweat
 Integrated Diverter: N
 Length: 4 3/4"
 Outlet Connection Size: 1/2"
 Outlet Connection Type: Sweat Shower/ NPT Tub
 Primary Material: Brass
 Safety Warnings: The risk of scalding exists until the installer has properly set the temperature high limit stop screw.
 Suggested Application: Bath
 Valve Material: Stainless Steel/ Rubber
 Water Pressure Maximum: 85.0 psi
 Water Pressure Minimum: 20.0 psi
 Water Pressure Recommended: 45.0 psi

INSPIRATION

The ViaWorks collection encompasses all Waterworks valves, which are just as impeccably engineered as our legendary fittings and the finest the industry has to offer in terms of performance, features and functionality. ViaWorks valves are engineered with more than three generations of bath and kitchen expertise, each with installers and lifelong service in mind.

CODES & STANDARDS

Complies with ASSE 1016/ASME A112.1016/CSA B125.16; State of MA(Model# GUSV87R)

PRODUCT FEATURES

Integrated anti-scald protection.

1/2" sweat inlet and 1/2" sweat shower/NPT tub outlet.

6 gpm (gallons per minute) unrestricted maximum flow at 60 psi

Do not use the bottom (tub) outlet of this product for any fittings with restricted flow, such as a handshower or body spray. The back pressure created would cause water to flow out through the top (shower) outlet. The integrated diverter on the GUPB87 would also malfunction. Single handle ON/OFF with temperature control

CERTIFICATIONS



PRODUCT (NOTES)

The risk of scalding exists until the installer has properly set the temperature high limit stop screw.

VIAWORKS

GUPB87

ViaWorks 1/2" Pressure Balance Valve with Integrated Diverter for Tub/Shower Combination

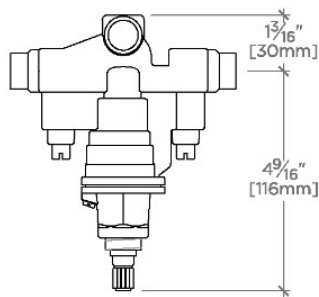

TOP VIEW SCALE: 3"=1'-0"

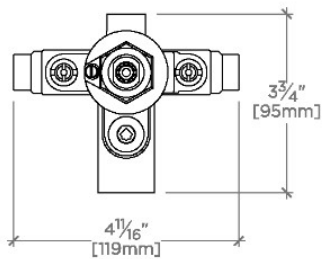

FRONT VIEW SCALE: 3"=1'-0"

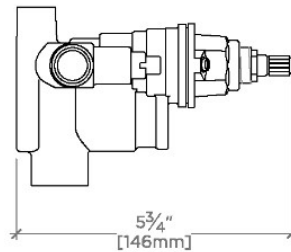

SIDE VIEW SCALE: 3"=1'-0"