

## R.W. Atlas

RWHW04

R.W. Atlas 5" Pull

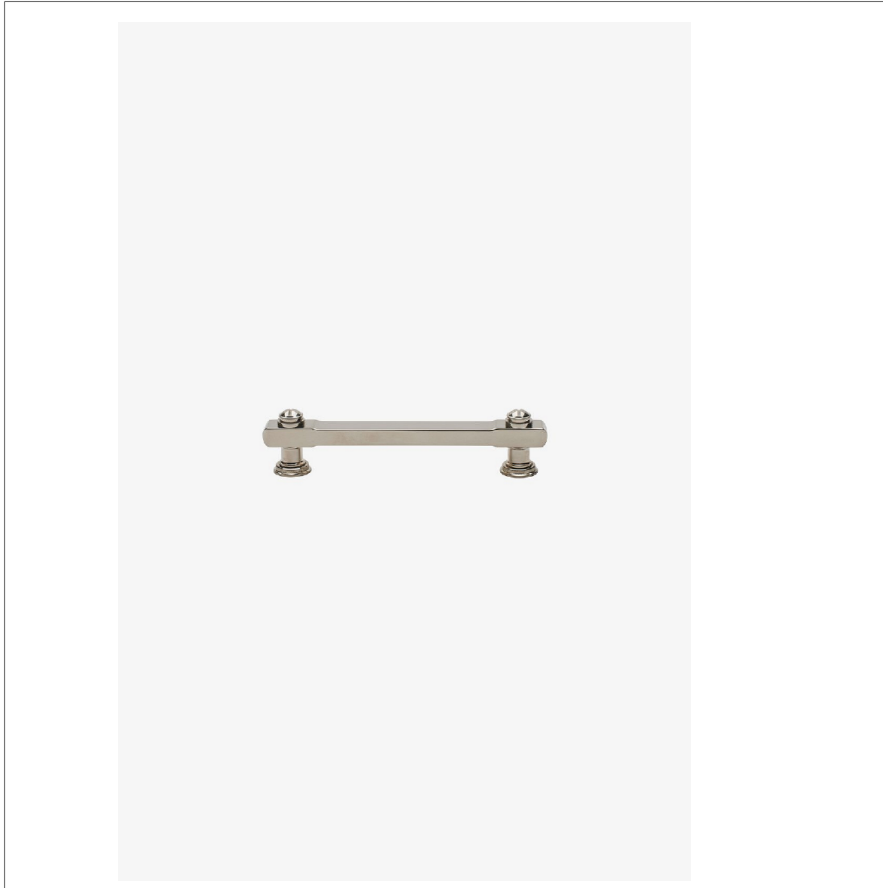

SHOWN IN R.W. ATLAS 5" PULL | RWHW04

### TECHNICAL DETAILS

Depth/Width: 25 mm  
Hardware Primary Material: Brass  
Hardware Shape: Knob  
Height: 21 mm  
Length: 159 mm  
Primary Material: Brass  
Suggested Application: All Applications

### INSPIRATION

Powerful shapes, exquisite materials, and unique aesthetic details define R.W. Atlas. This groundbreaking collection pairs American ingenuity with European craftsmanship, delivering refined industrial-inspired character that fits seamlessly into any space.

### CODES & STANDARDS

### PRODUCT FEATURES

Solid Brass

Machined and hand-polished

Made in Portugal

Includes 2 x M4 Pan Head Slot 1" Machine Screw and 2 x M4 Pan Head Slot 1 1/2" Machine Screw

### CERTIFICATIONS

Replacement Screws available  
**PRODUCT (NOTES)**

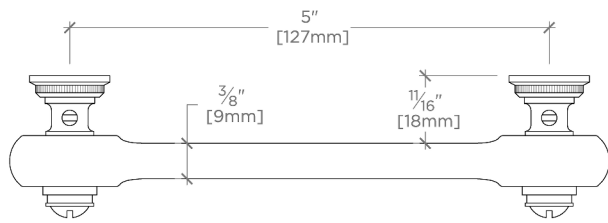

TOP VIEW

SCALE: 6"=1'-0"

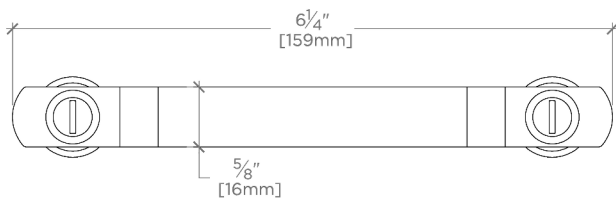

FRONT VIEW

SCALE: 6"=1'-0"

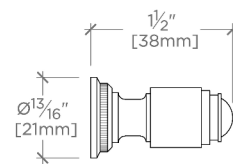

SIDE VIEW

SCALE: 6"=1'-0"