

FLYTE

FL2T10

Flyte Two Way Diverter Valve Trim for Thermostatic with Modern Dots and Lever Handle

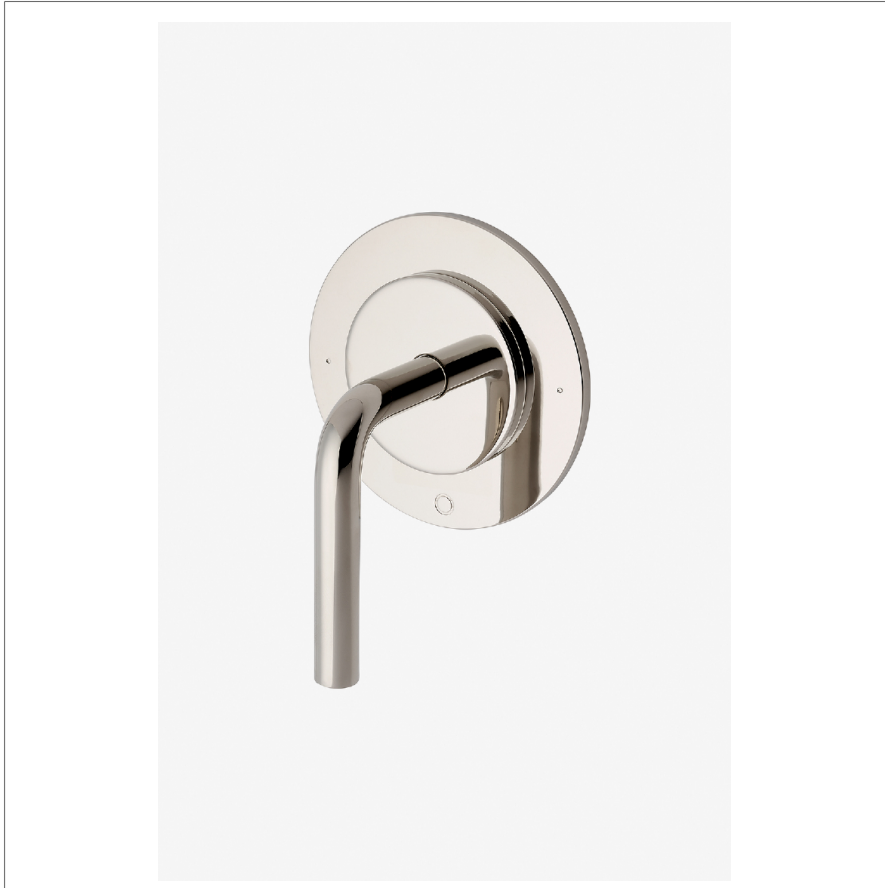

SHOWN IN FLYTE TWO WAY DIVERTER VALVE TRIM FOR THERMOSTATIC WITH MODERN DOTS AND LEVER HANDLE | FL2T10

TECHNICAL DETAILS

ADA Compliance: Yes
Fittings Hole Diameter: 2"
Handle Turn Angle: Quarter Turn Each Way
Number Of Holes: One Hole
Primary Material: Brass

INSPIRATION

Pure Modernism. Like minimalist works of art, the elegant proportions of these light, fluid elements bring sculptural reference to a room.

CODES & STANDARDS

FL2T10X, ASME A112.18.1/CSA B125.1

PRODUCT FEATURES

Lever Handle

For Use With a Thermostatic Shower System and Two Waterway Outlets

Features Modern Dots Representing Outlet Position

Stocked in Chrome, Nickel, Brass and Matte Black

Requires valve rough sold separately

CERTIFICATIONS

PRODUCT (NOTES)

FLYTE

FL2T10

Flyte Two Way Diverter Valve Trim for Thermostatic with Modern Dots and Lever Handle

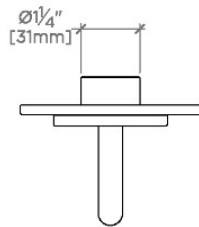

TOP VIEW SCALE: 3"=1'-0"

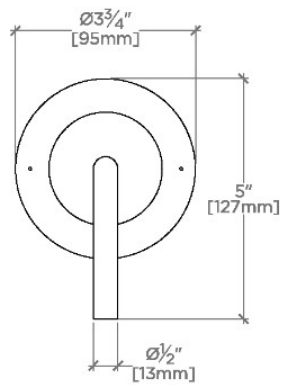

FRONT VIEW SCALE: 3"=1'-0"

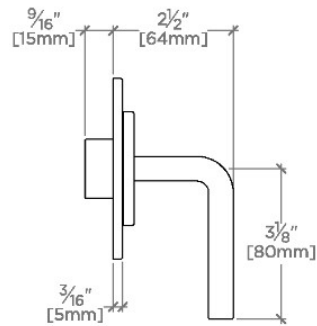

SIDE VIEW SCALE: 3"=1'-0"