

INSTALLATION GUIDELINES

ONE HOLE DECK MOUNTED LAVATORY FAUCET

HIGHGATE ONE HOLE LAVATORY FAUCET WITH HANDLE

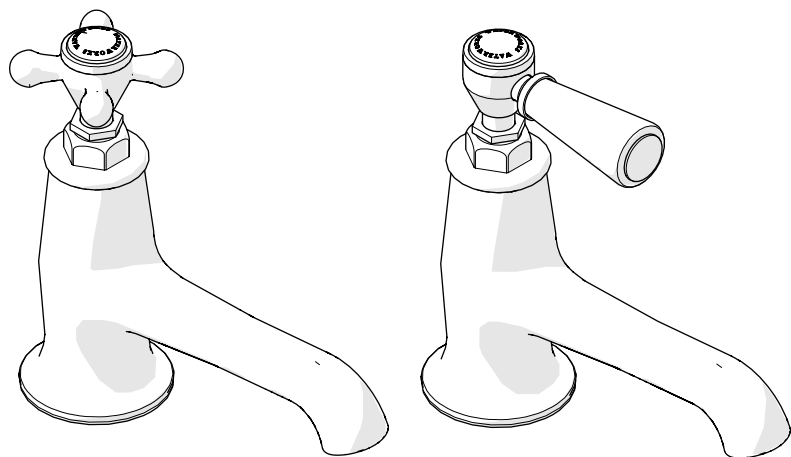

STYLES	
HGLS40	HGLS50

IMPORTANT:

- To ensure this product is installed properly, you must read and follow these guidelines.
- The owner/user of this product must keep this information for future reference.
- This product must be installed by a professional licensed contractor.
- Be sure your installation conforms to all federal, state, and local codes. In the State of Massachusetts, all installations must comply with the rules and regulations set forth within 248 CMR.
- Inspect this product to ensure you have all the parts required for proper installation.
- This product is sold partially assembled but shown fully disassembled for illustrative and service purposes only.
- Flushing the SUPPLY VALVES (sold separately) prior to installing the LAVATORY FAUCET is recommended. Flushing can prevent damage to the CARTRIDGE and other internal components.
- Use only a strap wrench or protected/smooth-jaw wrench on any finished surface.
- The use of certain plumber's putty may stain stone or tile surfaces.

➤ If further assistance is required, please contact Product Support at 1-800-927-2120 Monday through Friday, 8am - 6pm EST.

➤ Refer to the separate Service Parts Documents for available replacement parts.

TECHNICAL DETAILS:

DETAIL	SPECIFICATION
DRAIN DEPTH	3/8" [10mm] MINIMUM - 2" [51mm] MAXIMUM
DRAIN HOLE DIAMETER	Ø1-1/2" [38mm]
DRAIN STYLE	LIFT & TURN
INLET CONNECTION	3/8" COMPRESSION CONNECTOR HOSES †
SPOUT REACH	5-3/8" [136mm]
WATER PRESSURE	20psi [1.5 bar] MINIMUM - 85psi [6.0 bar] MAXIMUM
WATER PRESSURE RECOMMENDED	45psi [3.0 bar]

† For **INTERNATIONAL USE ONLY**, two UNUK08 9/16"-24 UNEF MALE x 3/8" FEMALE BSPP ADAPTERS and RUBBER WASHERS are provided.

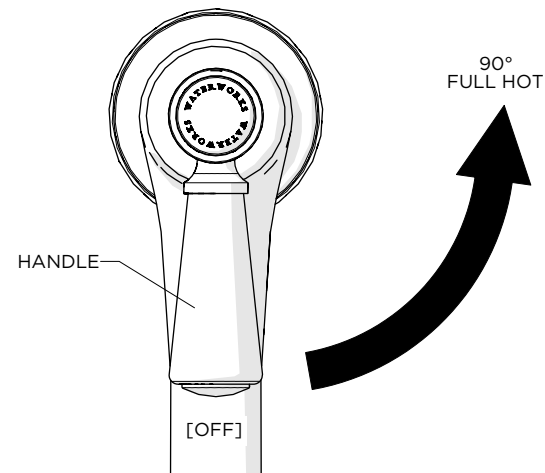
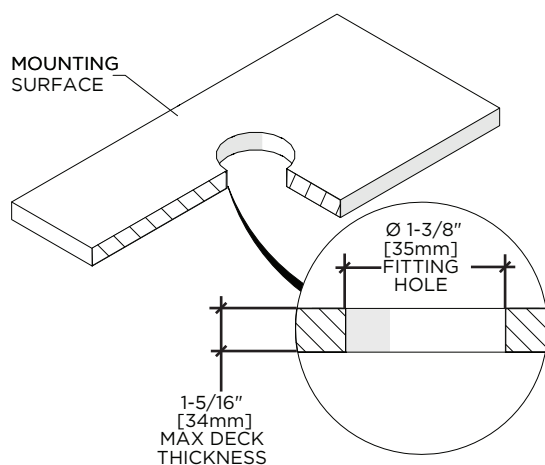

HANDLE OPERATION:

- This product is equipped with a PROGRESSIVE MIXING CARTRIDGE.
- The HANDLE rotates a 1/4 turn counterclockwise through cold, warm, and hot water temperatures as shown above.

INSTALLATION GUIDELINES

ONE HOLE DECK MOUNTED LAVATORY FAUCET

WATERWORKS

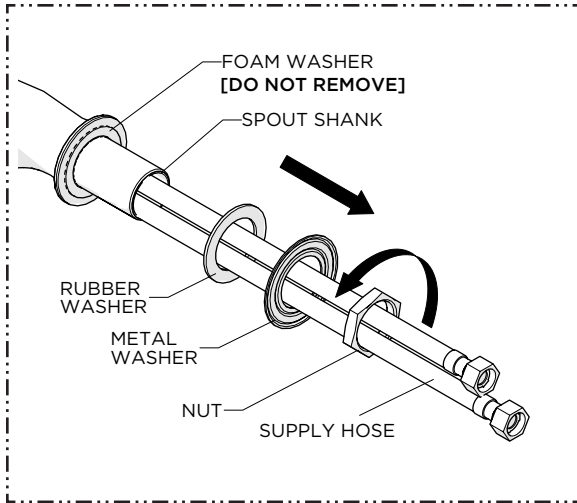

1. Remove the NUT, METAL WASHER, and RUBBER WASHER from the SPOUT SHANK.

NOTE: Do **NOT** remove the SPOUT SHANK or FOAM WASHER.

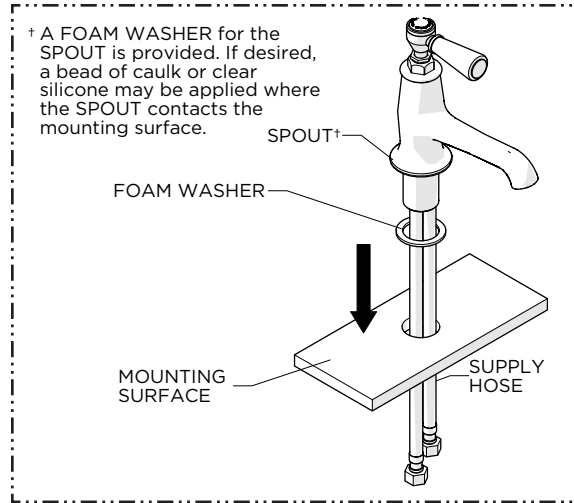

2. Insert the SUPPLY HOSES through the hole on the mounting surface making sure the FOAM WASHER provided is beneath the SPOUT.

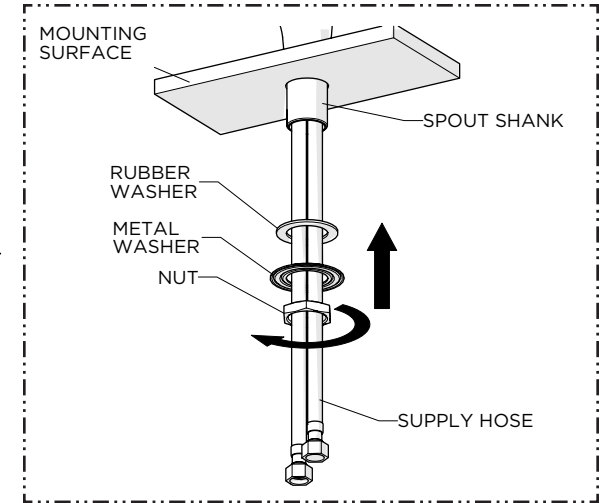

3. Slide the RUBBER and METAL WASHERS back onto the SPOUT SHANK then thread and securely tighten the NUT onto the SHANK.

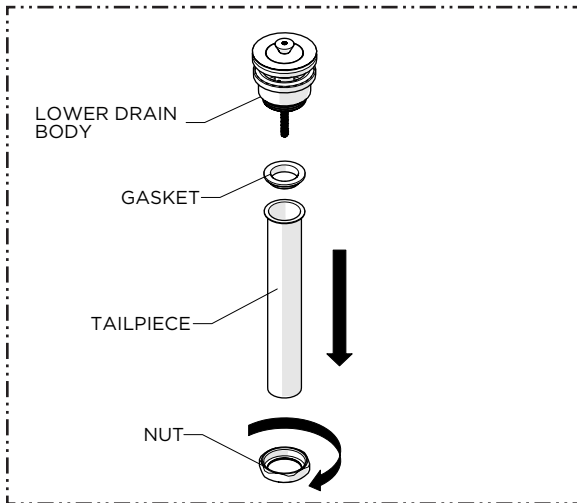

4. Unthread and remove the NUT, TAILPIECE, and GASKET from the LOWER DRAIN BODY.

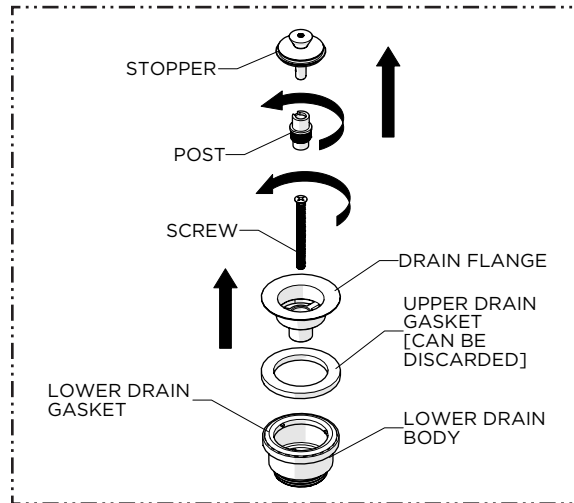

5. Remove the DRAIN STOPPER and POST from the DRAIN FLANGE then unthread the SCREW from the LOWER DRAIN BODY.

NOTE: Do **NOT** remove or discard the LOWER DRAIN GASKET.

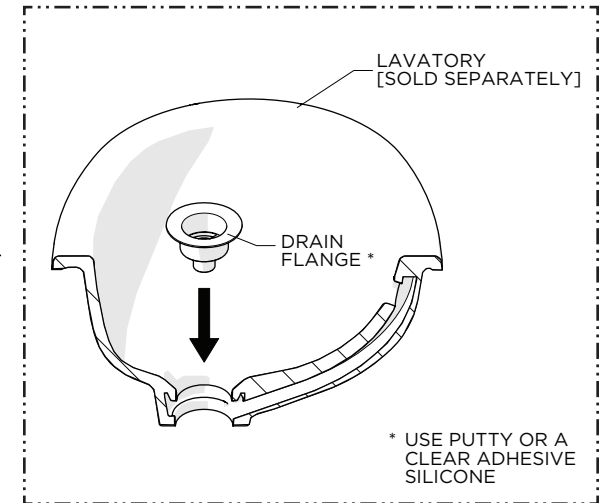

6. Set the DRAIN FLANGE into the LAVATORY (sold separately) using putty or a clear silicone.

INSTALLATION GUIDELINES

ONE HOLE DECK MOUNTED LAVATORY FAUCET

WATERWORKS

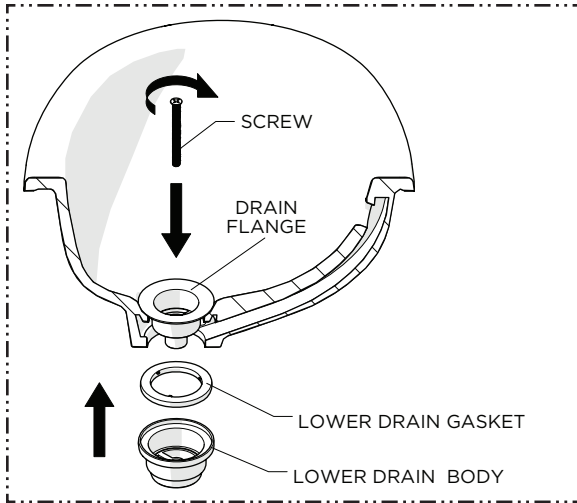

7. Insert the SCREW provided into the FLANGE then thread and securely tighten the SCREW into the LOWER DRAIN BODY making sure the LOWER DRAIN GASKET makes a full seal on the underside of the LAVATORY.

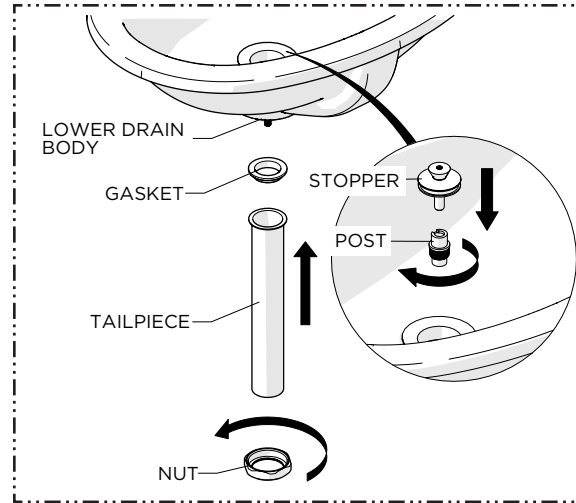

8. Re-install the POST, DRAIN STOPPER, and TAILPIECE using the GASKET and NUT provided.

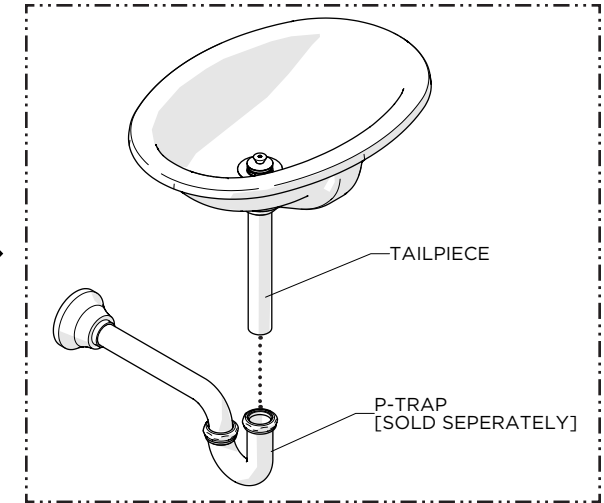

9. Make final P-TRAP (sold separately) connections.

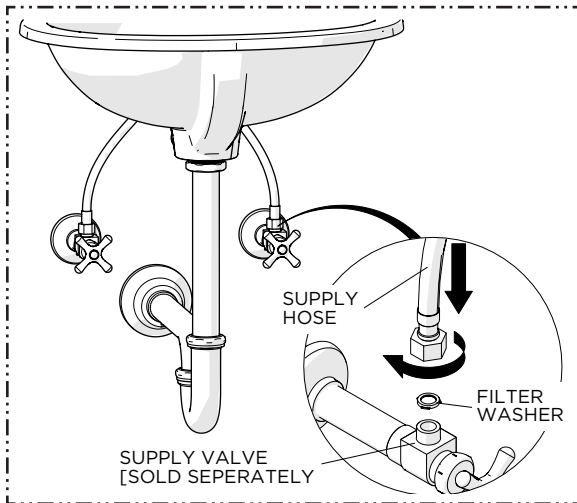

10. Connect the SUPPLY HOSES to the SUPPLY VALVES (sold separately), making sure to use the FILTER WASHERS provided.

NOTE: The HOSES are marked BLUE for cold and RED for HOT.

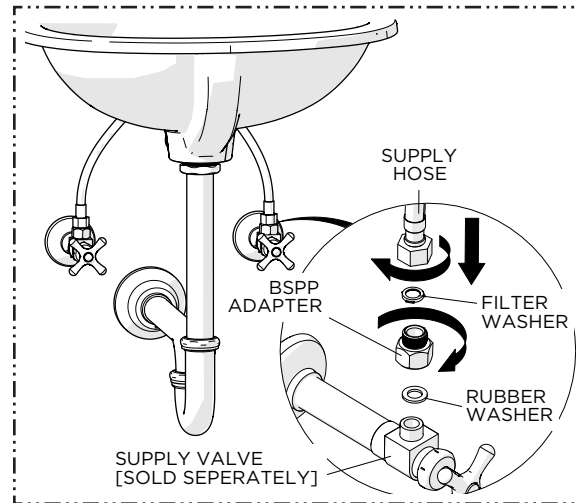

FOR INTERNATIONAL INSTALLATIONS ONLY:

11. Using the RUBBER WASHERS provided, thread and securely tighten the BSPP ADAPTERS onto the SUPPLY VALVES then thread and securely tighten the SUPPLY HOSES onto the ADAPTERS, making sure to use the FILTER WASHERS provided.

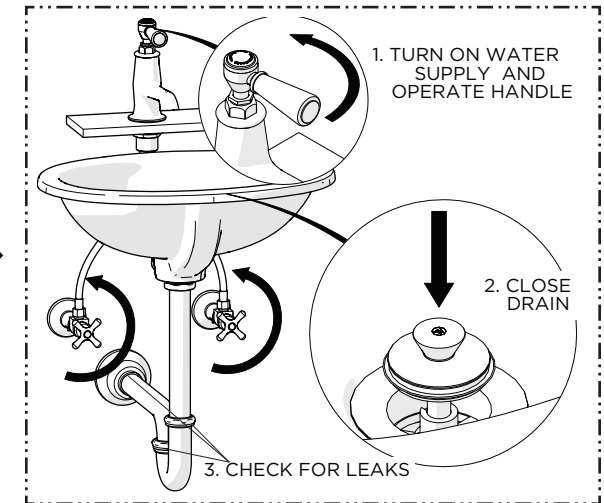

12. Turn on the water supply and operate the HANDLE to flush out the supply lines. Inspect all connections for leaks then close the DRAIN to ensure it functions properly.

NOTE: The HANDLE will rotate counterclockwise a 1/4 turn through cold, warm, and hot water temperatures.

INSTALLATION GUIDELINES

ONE HOLE DECK MOUNTED LAVATORY FAUCET

WATERWORKS

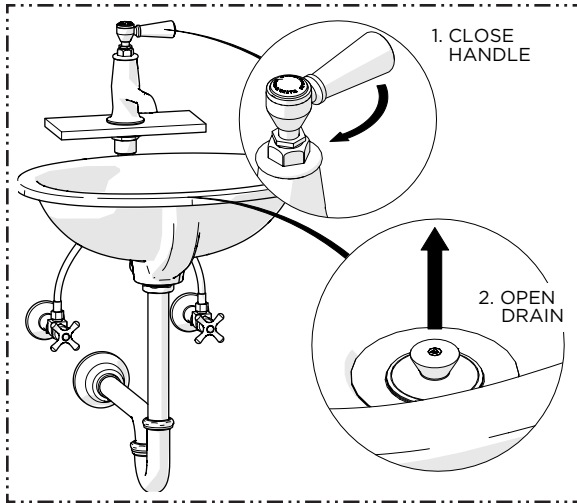

13. Close the HANDLE then open the DRAIN to drain the water.

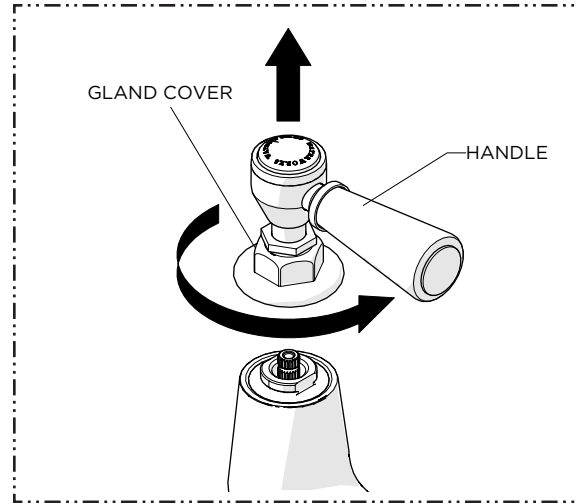

SERVICING THE CARTRIDGE:

1. Unthread the GLAND COVER along with the HANDLE from the SPOUT.

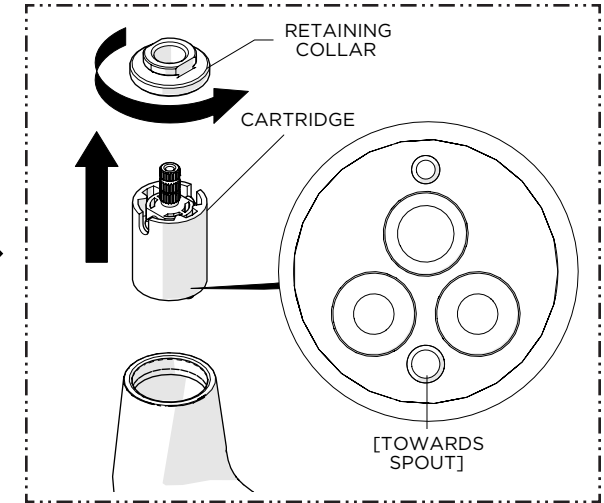

2. Unthread and remove the RETAINING COLLAR then pull the CARTRIDGE out.

NOTE: Replacing the RETAINING COLLAR requires a torque of 9 ft-lb [12Nm]. Exceeding this torque will damage the CARTRIDGE.

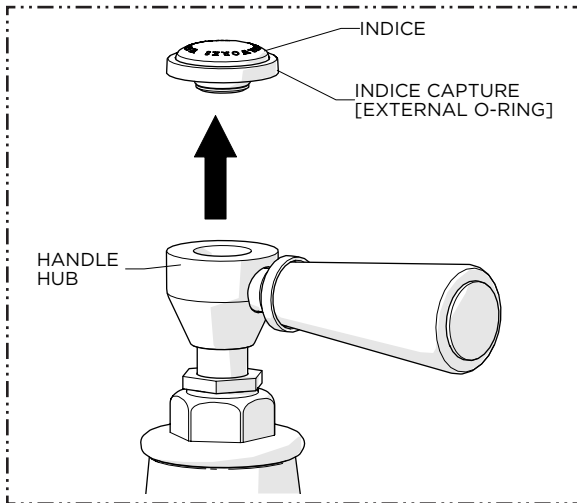

SERVICING THE INDICE AND HANDLE SLEEVE:

1. Pull the INDICE CAPTURE along with the INDICE from the HANDLE HUB.

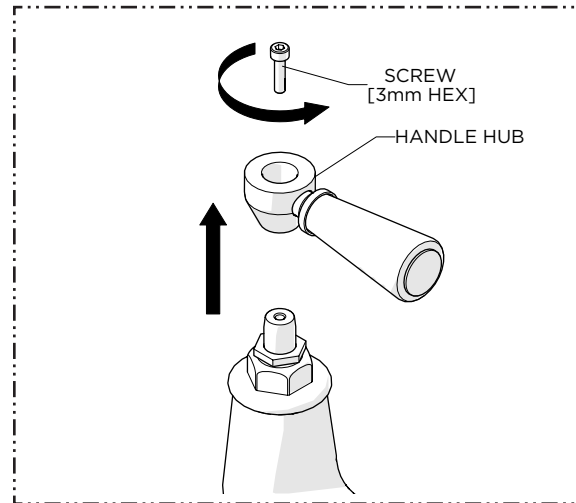

2. Unthread and remove the SCREW from the HANDLE HUB and then remove the HANDLE.

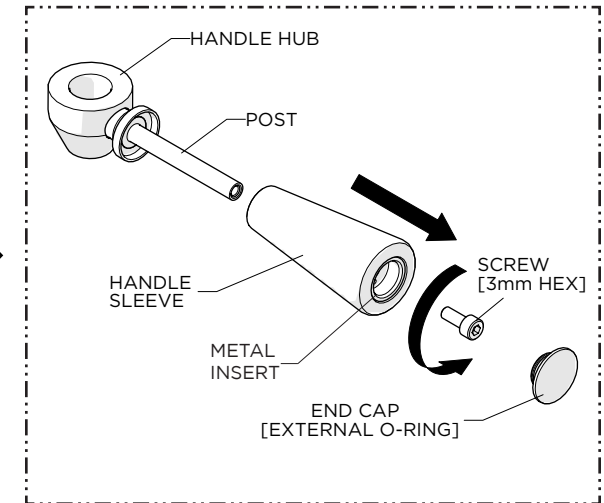

3. Remove the END CAP, then unthread and remove the SCREW from the POST, then remove the HANDLE SLEEVE from the POST.