

## Henry

HN3P12

Henry Three Way Diverter Valve Trim for Pressure Balance  
with Roman Numerals and Two-Tone Lever Handle

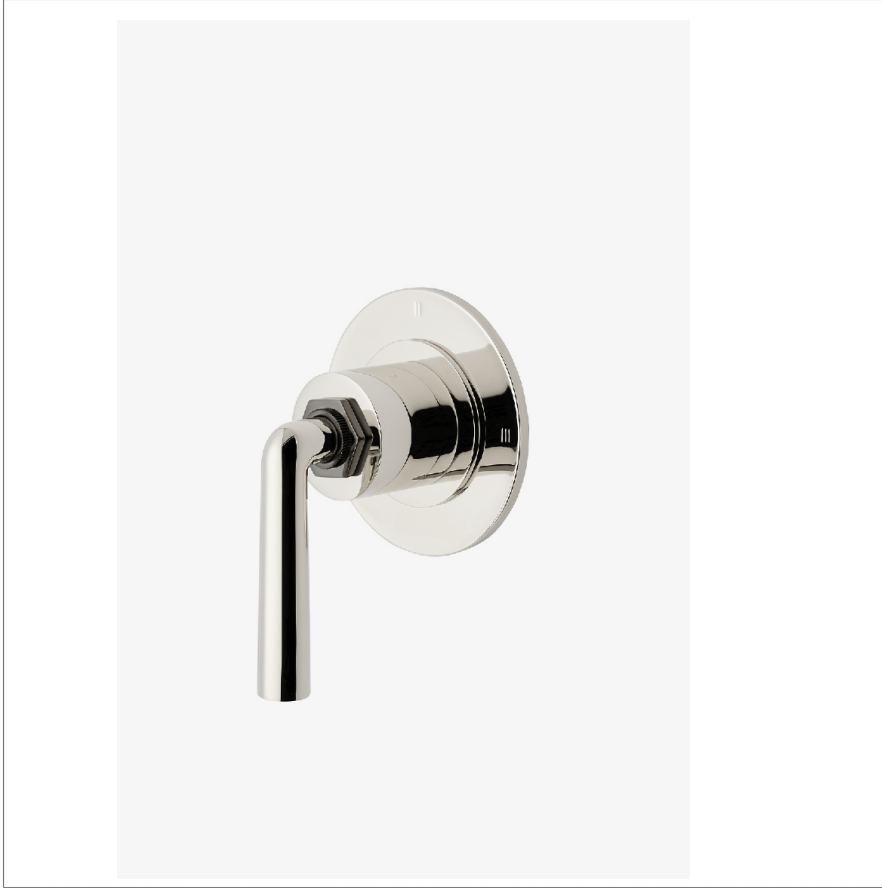

SHOWN IN HENRY THREE WAY DIVERTER VALVE TRIM FOR PRESSURE BALANCE WITH ROMAN NUMERALS AND TWO-TONE LEVER HANDLE | HN3P12

### TECHNICAL DETAILS

ADA Compliance: Yes  
Fittings Hole Diameter: 64 mm  
Handle Turn Angle: Quarter Turn Each Way  
Number Of Holes: One Hole  
Primary Material: Brass

### INSPIRATION

Celebrating the connection of industry and art, Henry transitions effortlessly between modern, traditional, and classic settings. These iconic fittings blend 19th-century industrial and artistic references for a look that's forever of the moment—familiar yet wholly original.

### CODES & STANDARDS

ASME A112.18.1/CSA B125.1, State of MA

### PRODUCT FEATURES

Two-Tone Lever Handle

For Use With a Pressure Balance Shower System and Three Waterway Outlets

Features Roman Numerals Representing Outlet Position

Stocked in Brass/Dark Nickel and Nickel/Dark Nickel

Requires valve rough sold separately

### CERTIFICATIONS



### PRODUCT (NOTES)

## Henry

HN3P12

Henry Three Way Diverter Valve Trim for Pressure Balance  
with Roman Numerals and Two-Tone Lever Handle

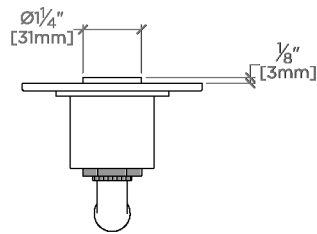

TOP VIEW SCALE: 3"=1'-0"

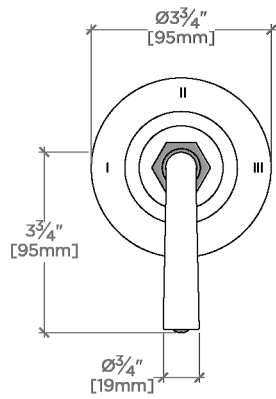

FRONT VIEW SCALE: 3"=1'-0"

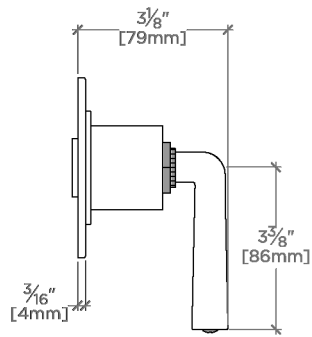

SIDE VIEW SCALE: 3"=1'-0"