

## ENZO

Enzo Ceiling Flush Mount

ENLT03



SHOWN IN ENZO CEILING FLUSH MOUNT | ENLT03

### TECHNICAL DETAILS

Ambient Task: Ambient  
 Depth/Width: 12 1/2"  
 Height: 4 3/8"  
 Installation Type: Ceiling Mounted  
 Interior Exterior Application: Interior Only  
 Length: 12 1/2"  
 Light Direction: Omnidirectional from wall surface  
 Orientation: Vertical or Horizontal  
 Primary Material: Brass  
 Safety Warnings: Do not exceed max wattage.  
 Voltage: 120  
 Wet/Dry: Damp or Dry

### INSPIRATION

Our Enzo collection exemplifies sophisticated organic minimalism. Each fixture showcases the unique beauty of carved marble or alabaster, thoughtfully paired with coordinating diffusers.

### CODES & STANDARDS

### PRODUCT FEATURES

Proprietary design

Available in Brass or Nickel with Alabaster or Marble & Glass

Handcrafted in Italy

Dimmable integrated LED fixture - 50,000 hours of life

Variation is to be expected from light to light

### CERTIFICATIONS

### PRODUCT (NOTES)

## ENZO

Enzo Ceiling Flush Mount

## ENLT03

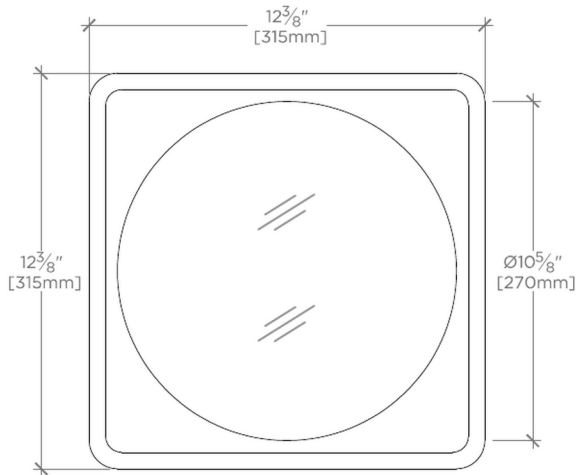

CEILING VIEW

SCALE: 2"=1'-0"

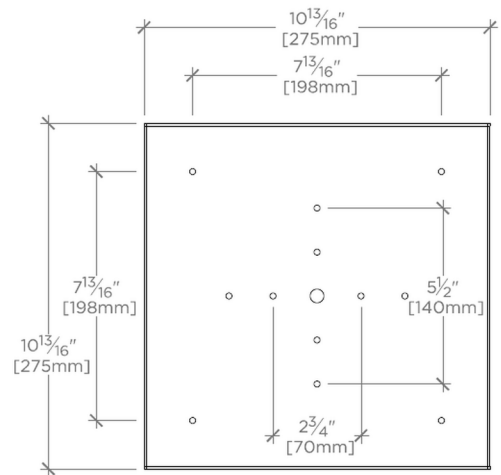

MOUNTING PLATE

SCALE: 2"=1'-0"

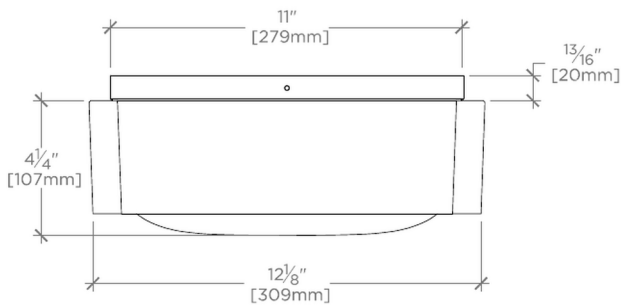

FRONT VIEW

SCALE: 2"=1'-0"

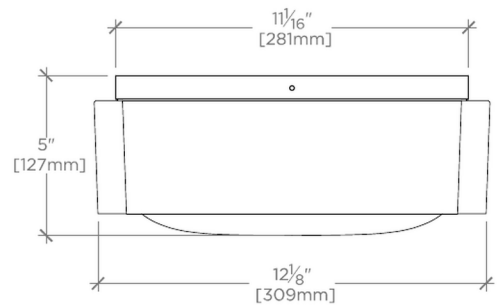

SIDE VIEW

SCALE: 2"=1'-0"