

UNIVERSAL

UNMS33

Universal Angle Watercloset Supply Kits 1/2" Sweat x 3/8"
O.D. Compression



SHOWN IN UNIVERSAL ANGLE WATERCLOSET SUPPLY KITS 1/2" SWEAT X 3/8" O.D. COMPRESSION | UNMS33

TECHNICAL DETAILS

ADA Compliance: No
 Depth/Width: 8"
 Escutcheon Primary Material: Brass
 Height: 13 1/2"
 Inlet Connection Size: 1/2"
 Inlet Connection Type: Sweat
 Length: 2 3/16"
 Outlet Connection Size: 3/8"
 Outlet Connection Type: Compression
 Primary Material: Brass
 Suggested Application: Bath
 Water Pressure Maximum: 85.0 psi
 Water Pressure Minimum: 20.0 psi
 Water Pressure Recommended: 45.0 psi

INSPIRATION

Our Universal collection features timeless designs complementing any of our Waterworks. With a wide range of product, from fittings to accessories, Universal adds exquisite proportion and balance to any environment.

CODES & STANDARDS

NSF/ANSI/CAN 61:Q < 0.5, ASME A112.18.1/CSA B125.1, State of MA

PRODUCT FEATURES

Created specifically to complement any bathroom aesthetic, the Universal watercloset supply kit adds a timeless touch of elegant to your plumbing.

This item is stocked in a Chrome, Nickel or Matte Nickel finishes and additional made-to-order finish options are available in 12 weeks from purchase

Made of beautifully hand fitted and hand polished brass, this watercloset supply kit has a clean design style that is simple and refined.

CERTIFICATIONS



PRODUCT (NOTES)

UNIVERSAL

UNMS33

Universal Angle Watercloset Supply Kits 1/2" Sweat x 3/8"
O.D. Compression

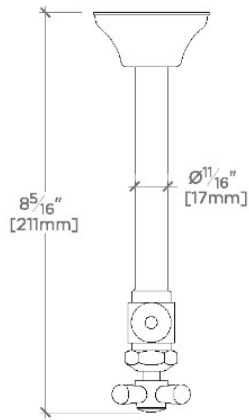

TOP VIEW SCALE: 3"=1'-0"

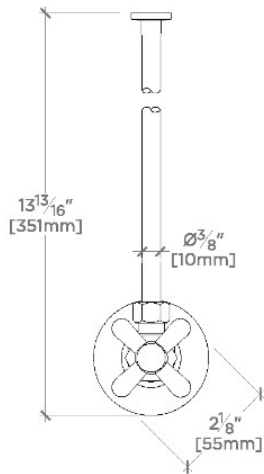

FRONT VIEW SCALE: 3"=1'-0"

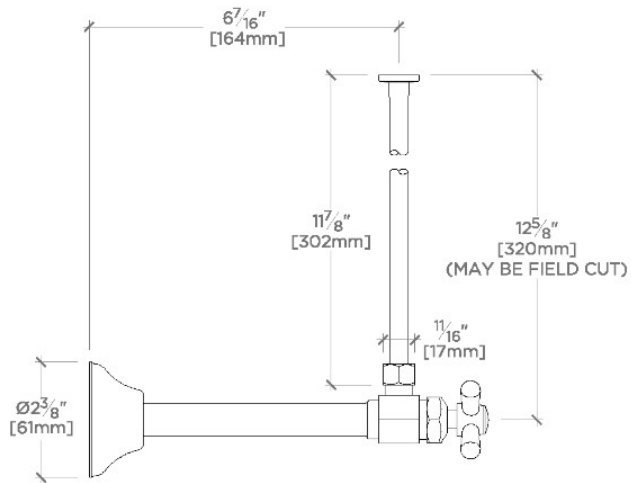

SIDE VIEW SCALE: 3"=1'-0"