

Flyte

FLPB30

Flyte Pressure Balance with Diverter Trim with Lever Handle



SHOWN IN FLYTE PRESSURE BALANCE WITH DIVERTER TRIM WITH LEVER HANDLE | FLPB30

TECHNICAL DETAILS

ADA Compliance: Yes
 Depth/Width: 78 mm
 Fittings Hole Diameter: 89 mm
 Height: 149 mm
 Integrated Diverter: N
 Integrated Spray: N
 Length: 140 mm
 Number Of Handles: One
 Pivot: N
 Primary Material: Brass
 Spout Swivel: N
 Spray Included In Unit: N
 Suggested Application: Bath

INSPIRATION

Pure modernism expressed through masterful proportions and light, fluid forms. Like minimalist works of art, these designs bring sculptural reference to any space with graceful proportions and versatile finish options.

CODES & STANDARDS

ASME A112.18.1/CSA B125.1, State of MA

PRODUCT FEATURES

Lever Handle

Integrated diverter allows bather to move water between two sources

Stocked in Chrome, Nickel, Brass and Matte Black

Requires rough valve, sold separately: GUPB87 (USA) or GU87PB (UK/International)

CERTIFICATIONS



PRODUCT (NOTES)

Requires valve rough GUSV87, item 26-50948-33633 sold separately.

Flyte

FLPB30

Flyte Pressure Balance with Diverter Trim with Lever Handle

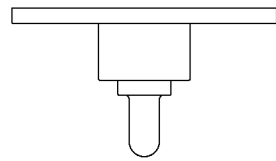

TOP VIEW SCALE: 3"=1'-0"

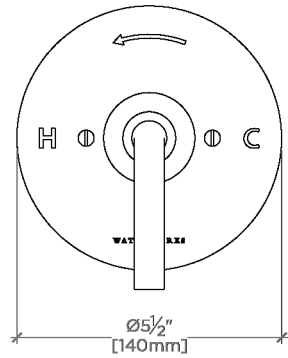

FRONT VIEW SCALE: 3"=1'-0"

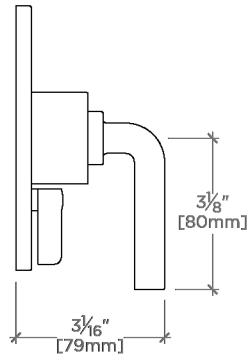

SIDE VIEW SCALE: 3"=1'-0"