

# WATERWORKS

DURHAM II Apron Rectangular Bathtub  
DUBT6R, DUBT6L

## IMPORTANT SAFETY INSTRUCTIONS: pertaining to a risk of injury to persons

**Warning:** Waterworks bathtubs utilize acrylic and fiberglass materials (which are inherently slippery surfaces). The following basic safety precautions should always be followed when using your bathtub.

### CAREFULLY READ AND FOLLOW ALL INSTRUCTIONS before

attempting to install this bathtub.

#### 1. Prior to Installation:

- Remove protective plastic and packaging and carefully inspect for any damage.
- Check tub for correct model name, size, color and trim finish.
- The tub **MUST** be tested while piping (plumbing) is accessible.
- If there are any issues, do not install and report the issues immediately to our factory or the authorized dealer.

2. **WARNING:** To avoid injury, exercise caution when entering or exiting the bathtub.

3. **DANGER/WARNING:** To reduce the risk of injury, do not permit children or persons with a disability to use this unit unless they are closely supervised at all times. Risk of accidental injury or drowning.

4. This product is for indoor use only. Use the bathtub only for its intended purpose as described in this manual and do not use attachments or accessories which are not recommended by manufacturer.

5. Never drop or insert any objects into any openings.

6. Keep all appliances, such as radios and hair dryers, a safe distance from the bathtub.

7. Install in accordance with manufacturer's installation instructions. Failure to comply with all instructions, requirements and warnings contained in this manual creates a serious hazard to the bathtub user and may result in serious personal injury.

## SAVE THESE INSTRUCTIONS

Waterworks baths are assembled complete and ready for installation. Immediately upon receiving the bath and removal of packing, **INSPECT** the unit for freight damage. Any claims for damage, whether apparent or hidden, must be made to freight carrier immediately, in order for them to assume all associated costs. Should inspection reveal any defect in the finish, **DO NOT INSTALL THE BATH**. Damage or defect to the finish claimed after the bath is installed is excluded from the warranty. The warranty **DOES NOT** cover labor or materials to remove or re-install the bath.

#### PRIOR TO INSTALLATION

Check to ensure that:

- The installation will conform with all applicable Federal, State and Local Building Codes & Regulations;
- The unit is the correct model and color;
- There has been no shipping damage;
- The "notice" or "warning" tags on the bathtub have been read and thoroughly understood;
- The interior of the tub will be protected during installation;
- Make sure sub floor is level.

#### DURING INSTALLATION

Check to ensure that:

- Bathtub is not hanging from the rim. Bath must be supported from the floor (See Figure 1.)
- All Bathtubs with seats must have additional support for each seat.

## Installation Instructions

**Be sure to take any necessary precautions to keep tub protected during installation.**

- Prepare tub setting bed using lightweight cement, plaster, gypsum or fix-all bed approximately 1" or 2" thick (Figure 1).
- Place the tub in the proper position using the floor, not the deck or rim, as the support, and set it in the bedding compound (Figure 2).

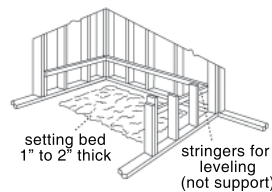

Figure 1

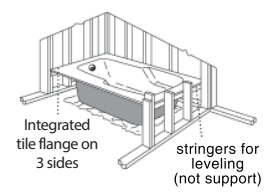
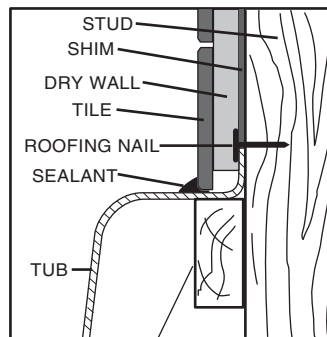

Figure 2

#### COMPLETE BATH INSTALLATION

Level the top of the bathtub in both directions, using a 4 ft. level, to ensure drainage. Bring the tile or finished surface to tub deck and then seal. Seal edges as shown (See Figures 3.) Using recommended drain opening, connect drain (not supplied) to the waste line. Tighten all drain joints securely.

Figure 3



2" x 4" (US) or 38mm x 89mm (UK)  
WOOD STRINGER FULL LENGTH

#### CLEAN-UP AFTER INSTALLATION

When cleaning up after installation, do not use abrasive cleaners as they may scratch and dull the surface. Use warm water and a liquid non-abrasive detergent to clean the surface.

Stubborn stains, paint or tar can be removed with turpentine or paint thinner. Do not allow cleaners containing petroleum distillates to remain in contact with bath surface for long periods of time. Plaster can be removed by scraping with a wood edge. Do not use metal scrapers, wire brushes, or other metal tools.

When cleaning up after installation do not use abrasive cleaners, steel wool, scouring pads or harsh chemicals. For cleaning procedures refer to the "Care and Maintenance" instructions provided separately.

If further assistance is required, please contact Product Support at 1-800-927-2120 Monday through Friday, 8am - 6pm EST.