

## R.W. Atlas

RWWL18

R.W. Atlas 18" Wall Mounted 90 Degree Shower Arm with Flange



SHOWN IN R.W. ATLAS 18" WALL MOUNTED 90 DEGREE SHOWER ARM WITH FLANGE | RWWL18

### TECHNICAL DETAILS

Fittings Hole Diameter: 32 mm  
Inlet Connection Size: 1/2"  
Inlet Connection Type: Male NPT  
Outlet Connection Size: 1/2"  
Outlet Connection Type: Male NPT  
Water Pressure Recommended: 3.0 bar

### INSPIRATION

Powerful shapes, genuine materials and unique aesthetic details. The original, impeccable vision of R.W. Atlas pairs American ingenuity with European craftsmanship.

### CODES & STANDARDS

### PRODUCT FEATURES

Compatible with an assortment of Waterworks showerheads, sold separately

Brass Construction

Includes 18" wall mounted 90 degree shower arm

Stocked in Chrome, Nickel and Brass

### CERTIFICATIONS

### PRODUCT (NOTES)

# WATERWORKS

R.W. Atlas

RWWL18

R.W. Atlas 18" Wall Mounted 90 Degree Shower Arm with Flange

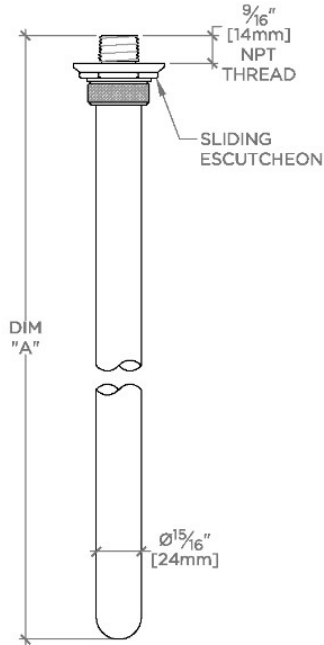

TOP VIEW SCALE: 3"=1'-0"

STYLE NO.	DIM "A"	DIM "B"
RWWL12	13 1/16" [331mm]	12 1/2" [319mm]
RWWL18	19 1/16" [484mm]	18 1/2" [472mm]
RWWL22	23 1/16" [585mm]	22 1/2" [572mm]

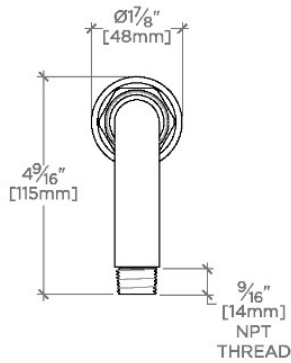

FRONT VIEW SCALE: 3"=1'-0"

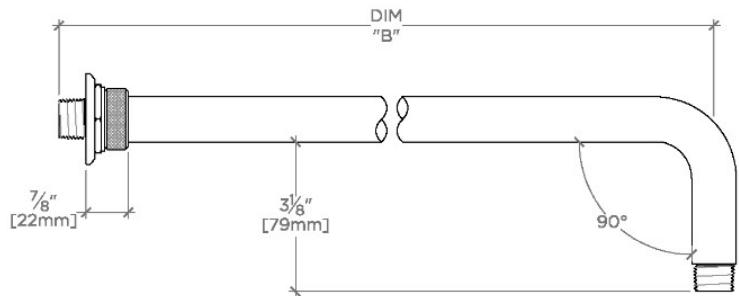

SIDE VIEW SCALE: 3"=1'-0"