

## UNIVERSAL

Universal Wall Mounted Tub Spout

## UN34TS



SHOWN IN UNIVERSAL WALL MOUNTED TUB SPOUT | UN34TS

### TECHNICAL DETAILS

ADA Compliance: Yes  
Adjustable versus Fixed Spray: Fixed Spray  
Escutcheon Primary Material: Brass  
Fittings Hole Diameter: 32 mm  
Installation Notes: Comes with 1/2inch Female NPT Adapter  
Depth / Width: 195 mm  
Height: 64 mm  
Inlet Connection Size: 3/4"  
Inlet Connection Type: Male G/BSPP  
Installation Type: Wall Mounted  
Length: 64 mm  
Primary Material: Brass  
Spout Reach: 7.1"  
Spout Swivel: N  
Suggested Application: Bath  
Water Pressure Maximum: 5.5 bar  
Water Pressure Minimum: 1.5 bar  
Water Pressure Recommended: 3.0 bar

### INSPIRATION

Our Universal collection features timeless designs complementing any of our Waterworks. With a wide range of product, from fittings to accessories, Universal adds exquisite proportion and balance to any environment.

### CODES & STANDARDS

Code # : ASME A112.18.1 / CSA B125.1, IAPMO, State of MA

### PRODUCT FEATURES

Create a refined environment for your daily ritual by installing an exquisitely proportioned Universal tub spout

A clean, universal aesthetic is applicable to all bath environments (traditional to modern)

A wall mounted tub spout works seamlessly with Waterworks' thermostatic or diverter shower systems

# WATERWORKS

## UNIVERSAL

## UN34TS

Universal Wall Mounted Tub Spout

ADAPTER(S) PACKAGED SEPARATELY		
ADAPTER	DESCRIPTION	QTY
UNUK06	3/4" NPT Male x 3/4" Male Nipple 50mm Long BSP	1

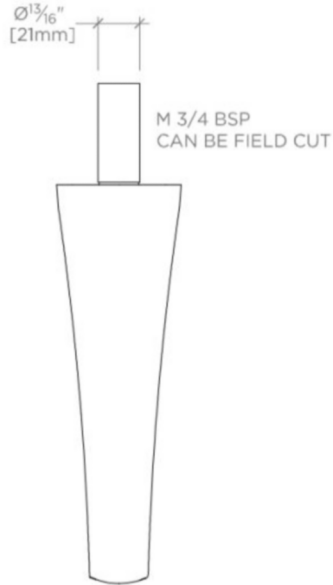

TOP VIEW SCALE: 3"=1'-0"

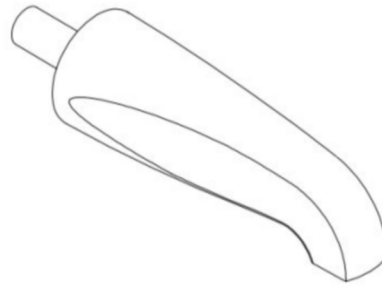

ISO VIEW SCALE: 3"=1'-0"



FRONT VIEW SCALE: 3"=1'-0"

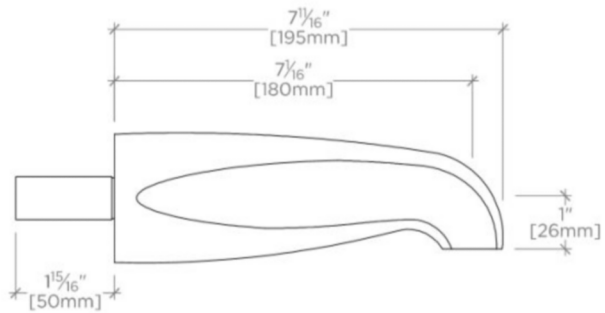

SIDE VIEW SCALE: 3"=1'-0"