

## Henry

Henry 1 1/4" Knob

HNHW01



SHOWN IN HENRY 1 1/4" KNOB | HNHW01

### TECHNICAL DETAILS

Primary Material: Brass

### INSPIRATION

Celebrating the connection of industry and art, Henry transitions effortlessly between modern, traditional, and classic settings. These iconic fittings blend 19th-century industrial and artistic references for a look that's forever of the moment—familiar yet wholly original.

### CODES & STANDARDS

### PRODUCT FEATURES

Match to Henry fittings and accessories

Hexagon shapes in knobs and pulls with exposed screws

Solid brass

Made in Portugal

Includes 1 x M4 Pan Head Slot 1" Machine Screw and 1 x M4 Pan Head Slot 1 1/2" Machine Screw

### CERTIFICATIONS

### PRODUCT (NOTES)

## Henry

Henry 1 1/4" Knob

HNHW01

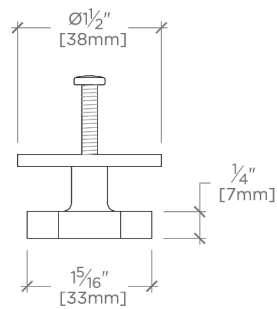

TOP VIEW SCALE: 6"=1'-0"

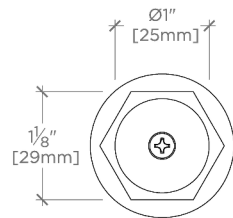

FRONT VIEW SCALE: 6"=1'-0"

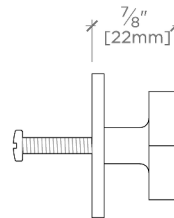

SIDE VIEW SCALE: 6"=1'-0"