

## HENRY

CNWH06

Henry Chronos 6" Wall Mounted 45 Degree Shower Arm with Flange



SHOWN IN HENRY CHRONOS 6" WALL MOUNTED 45 DEGREE SHOWER ARM WITH FLANGE | CNWH06

### TECHNICAL DETAILS

Fittings Hole Diameter: 1 1/4"  
Inlet Connection Size: 1/2"  
Inlet Connection Type: Male NPT  
Outlet Connection Size: 1/2"  
Outlet Connection Type: Male NPT  
Water Pressure Recommended: 45.0 psi

### INSPIRATION

Influenced by the connection of industry and art Henry easily transitions between modern, traditional, utilitarian and classic settings.

### CODES & STANDARDS

### PRODUCT FEATURES

Compatible with an assortment of Waterworks showerheads, sold separately

Brass Construction

Includes 10" wall mounted 45 degree shower arm

Stocked in Chrome, Nickel and Brass

### CERTIFICATIONS

### PRODUCT (NOTES)

HENRY

CNWH06

Henry Chronos 6" Wall Mounted 45 Degree Shower Arm with Flange

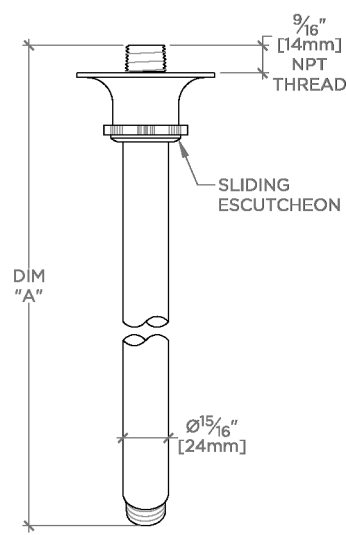

TOP VIEW SCALE: 3"=1'-0"

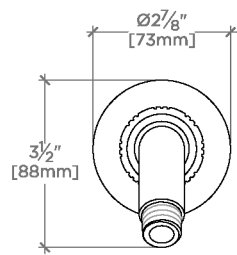

FRONT VIEW SCALE: 3"=1'-0"

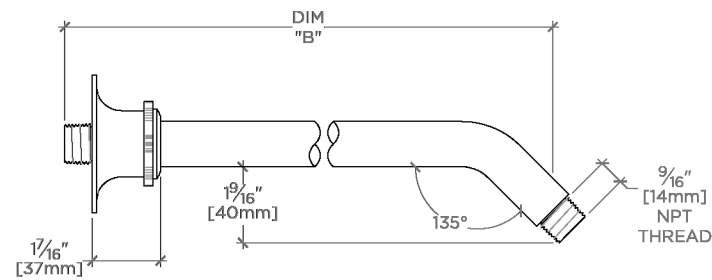

SIDE VIEW SCALE: 3"=1'-0"

STYLE NO.	DIM "A"	DIM "B"
CNWH06	$6\frac{15}{16}$ " [176mm]	$6\frac{1}{4}$ " [158mm]
CNWH08	$8\frac{15}{16}$ " [226mm]	$8\frac{1}{4}$ " [209mm]
CNWH10	$10\frac{15}{16}$ " [277mm]	$10\frac{1}{4}$ " [260mm]