

BOND

BTH44B

Bond Tandem Series Integrated Thermostatic and Two Way Diverter Trim with Two-Tone Guilloche Lines Knob Handles



SHOWN IN BOND TANDEM SERIES INTEGRATED THERMOSTATIC AND TWO WAY DIVERTER TRIM WITH TWO-TONE GUILLOCHE LINES KNOB HANDLES | BTH44B

TECHNICAL DETAILS

ADA Compliance: Yes
 Integrated Diverter: N
 Number Of Holes: Two Hole
 Primary Material: Brass

INSPIRATION

Modern designs infused with rare soul and artistry. Explore our wide range of Bond bath and kitchen elements, from fittings to fixtures to hardware.

CODES & STANDARDS

ASME A112.18.1/CSA B125.1, State of MA

PRODUCT FEATURES

Knob Handles

Allows bather to adjust temperature of all waterway outlets with a hot limit safety stop providing anti-scald protection

Features Two-Tone Knob Handles

Stocked in Nickel and Brass

Requires valve rough sold separately

CERTIFICATIONS



PRODUCT (NOTES)

BOND

BTH44B

Bond Tandem Series Integrated Thermostatic and Two Way Diverter Trim with Two-Tone Guilloche Lines Knob Handles

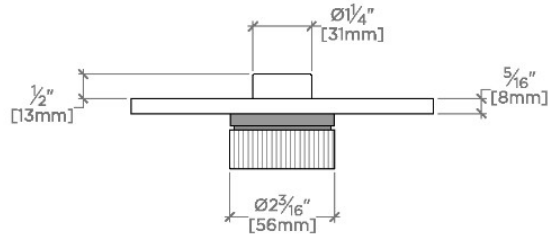

TOP VIEW

SCALE: 3"=1'-0"

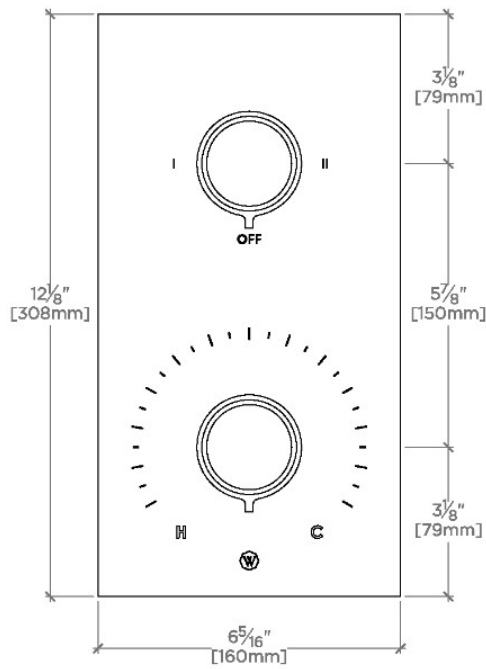

FRONT VIEW

SCALE: 3"=1'-0"

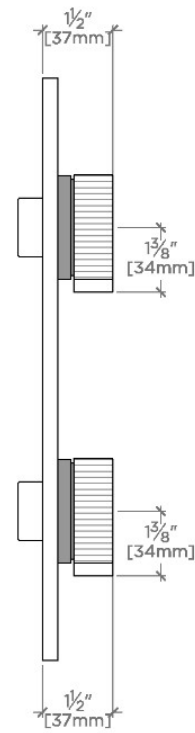

SIDE VIEW

SCALE: 3"=1'-0"