

LUDLOW

LDVC15

Ludlow Volta Volume Control Valve Trim with Lever Handle

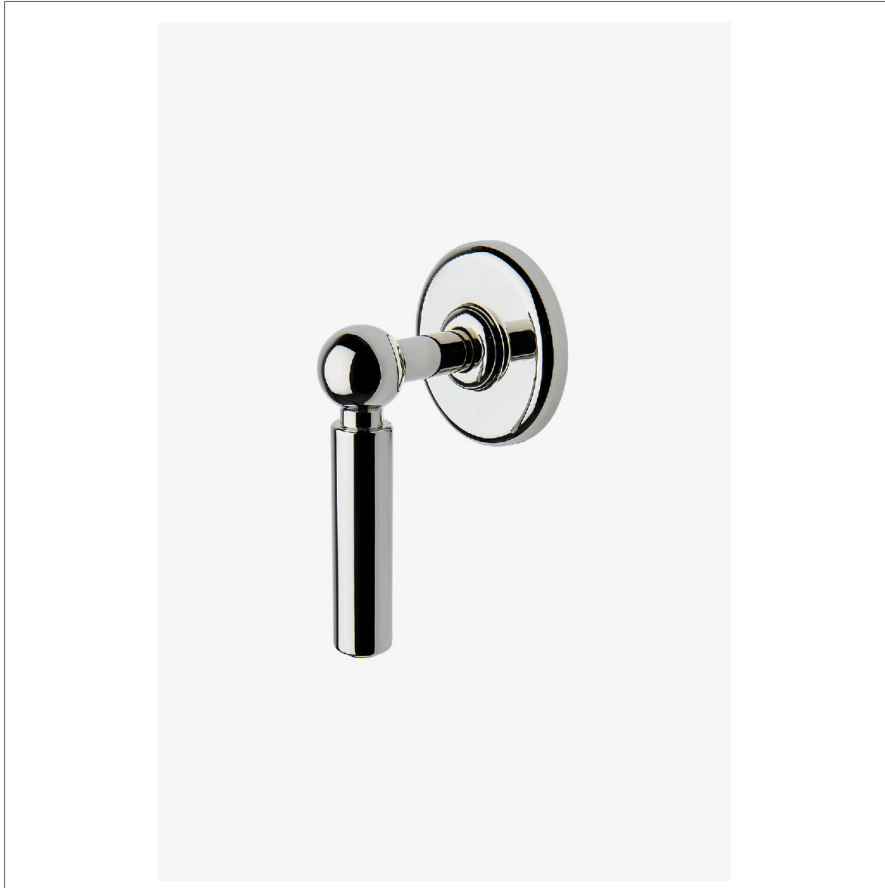

SHOWN IN LUDLOW VOLTA VOLUME CONTROL VALVE TRIM WITH LEVER HANDLE | LDVC15

TECHNICAL DETAILS

ADA Compliance: Yes
Fittings Hole Diameter: 1 3/8"
Primary Material: Brass

INSPIRATION

Our fresh take on American industrial design comes in three styles, each of them clean-lined, and distinct to Waterworks.

CODES & STANDARDS

ASME A112.18.1/CSA B125.1, State of MA

PRODUCT FEATURES

Lever Handle

Used to control water flow to a single waterway outlet such as a showerhead, handshower, or tub spout

Stocked in a Chrome, Nickel and Brass

Requires rough valve, sold separately: GUV18/GUV19 (1/2") or GUV16/GUV17 (3/4")

CERTIFICATIONS



PRODUCT (NOTES)

Ludlow Volta Volume Control Valve Trim with Lever Handle

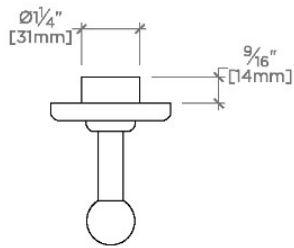

TOP VIEW SCALE: 3"=1'-0"

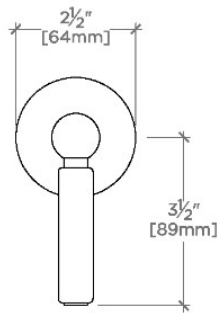

FRONT VIEW SCALE: 3"=1'-0"

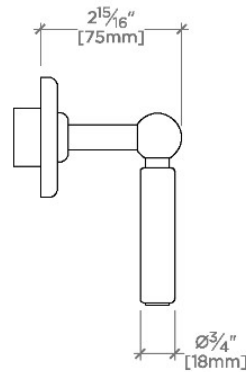

SIDE VIEW SCALE: 3"=1'-0"