

R.W. Atlas

RWVC01

R.W. Atlas Volume Control Valve Trim with Metal Wheel Handle
Handle



SHOWN IN R.W. ATLAS VOLUME CONTROL VALVE TRIM WITH METAL WHEEL HANDLE | RWVC01

TECHNICAL DETAILS

ADA Compliance: Yes
Depth/Width: 68 mm
Escutcheon Primary Material: Brass
Fittings Hole Diameter: 35 mm
Height: 67 mm
Integrated Diverter: N
Integrated Spray: N
Length: 67 mm
Number Of Handles: One
Pivot: N
Primary Material: Brass
Spout Swivel: N
Spray Included In Unit: N
Suggested Application: Bath

INSPIRATION

Powerful shapes, genuine materials and unique aesthetic details. The original, impeccable vision of R.W. Atlas pairs American ingenuity with European craftsmanship.

CODES & STANDARDS

ASME A112.18.1/CSA B125.1, State of MA

PRODUCT FEATURES

Features knurled detail on the handle.

CERTIFICATIONS



PRODUCT (NOTES)

Requires 3/4" Universal Volume Control Valve.

R.W. Atlas

RWVC01

R.W. Atlas Volume Control Valve Trim with Metal Wheel Handle

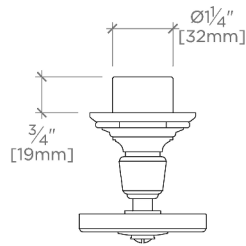

TOP VIEW SCALE: 3"=1'-0"

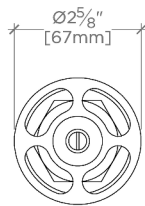

FRONT VIEW SCALE: 3"=1'-0"

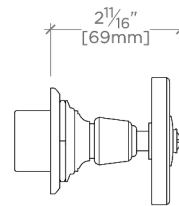

SIDE VIEW SCALE: 3"=1'-0"