

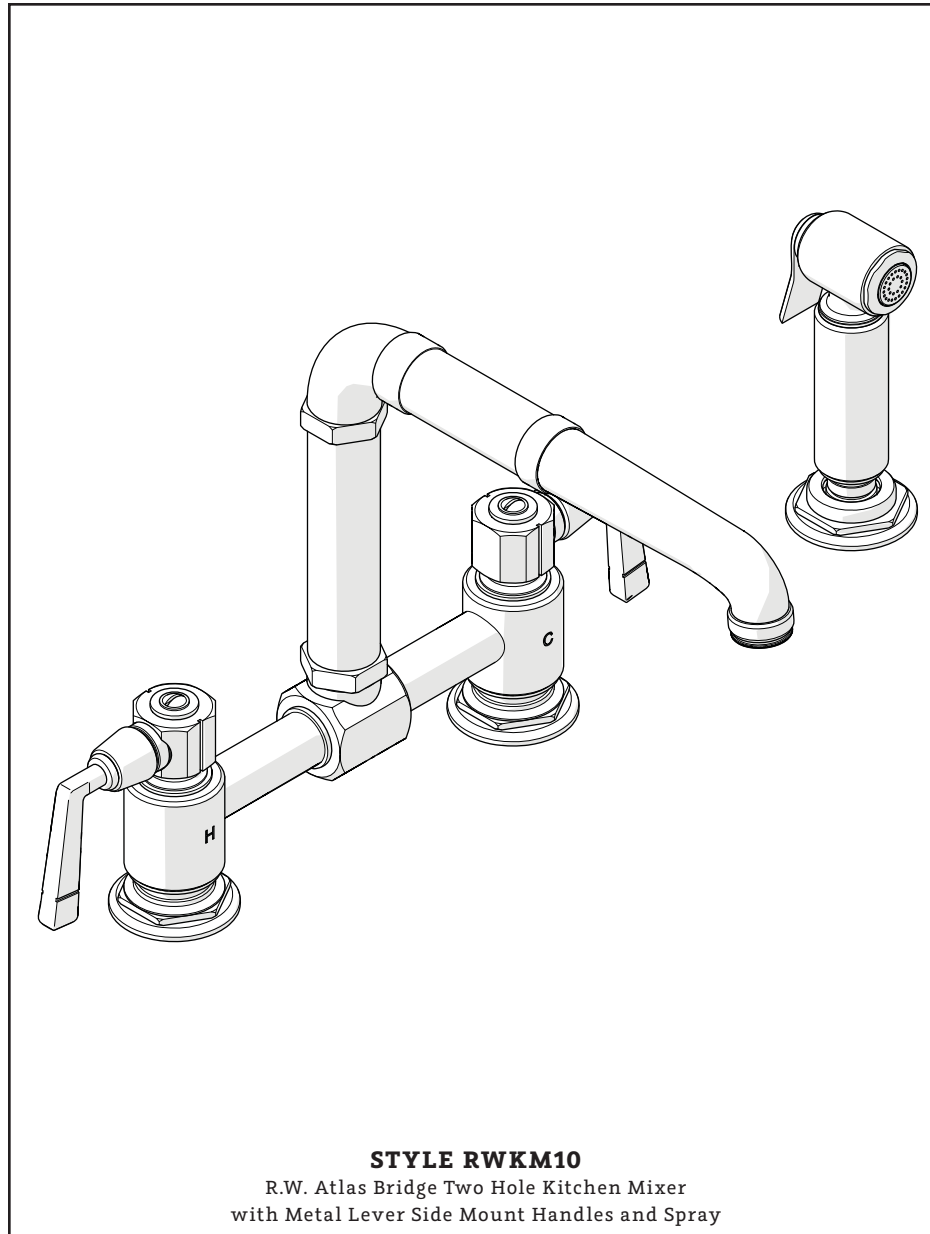

ESTB. 1978

WATERWORKS

SERVICE PARTS



STYLE RWKM10

R.W. Atlas Bridge Two Hole Kitchen Mixer
with Metal Lever Side Mount Handles and Spray

WELCOME TO

WATERWORKS

For over three decades, Waterworks has transformed the bath through an absolute commitment to design authenticity, innovation and quality. A blend of scholarly appreciation and applied experience guarantees mechanical integrity, meticulous craftsmanship, and timeless designs.

**TO ORDER PARTS CALL
1 (800) 927-2120 (EXT 2)**

Order by part number and specify color, finish, or other options if required.

PRODUCT SUPPORT

Our Product Support team provides troubleshooting and technical problem resolution, including replacement parts and installation recommendations throughout the life of your product.

Product Support is available Monday through Friday, 8AM-6PM EST.

**LIMITED LIFETIME
WARRANTY**

Our warranty covers repair and replacement of Waterworks products if within the applicable coverage period and deemed defective by Waterworks. Waterworks will, at its option, repair or replace such products; this does not include installation costs, labor charges, or other incidental or consequential costs.

To obtain your complete warranty or inquire about warranty service, please visit us at www.waterworks.com or contact our Product Support Team.



ESTB. 1978

WATERWORKS

MAIN KITS

STYLES: RWKM10

105945*
SPOUT

105948
DIVERTER

103702
3/8" COUNTERCLOCKWISE ON CARTRIDGE

103704*
LEVER HANDLE

105949
SEAL KIT

105949
SEAL KIT

103722*
ESCUTCHEON

103471
MOUNTING HARDWARE

105950
HOSE

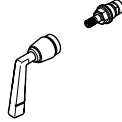
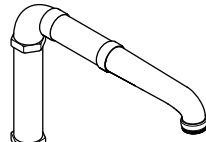

*FINISH/COLOR MUST BE SPECIFIED WHEN ORDERING
++SUPPLIED AS A PAIR

103704*
LEVER HANDLE

103703
3/8" CLOCKWISE ON CARTRIDGE

105949
SEAL KIT

105949
SEAL KIT

105949
SEAL KIT

105951*
SPRAY

103728*
SPRAY RETURN

105952
KITCHEN SPRAY HOSE

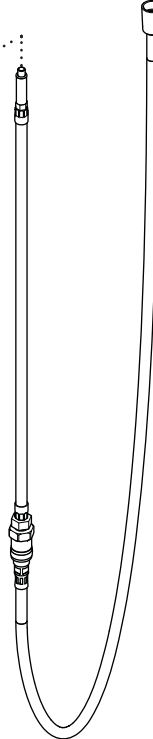



ESTB. 1978

WATERWORKS

KIT COMPONENTS

STYLES: RWKM10

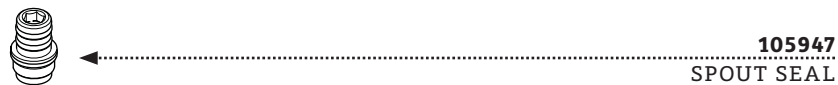
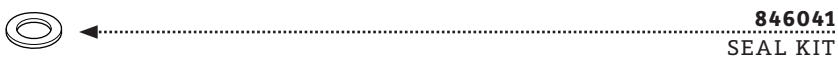
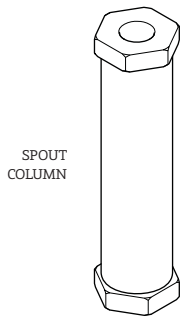
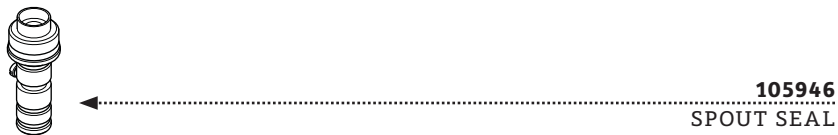
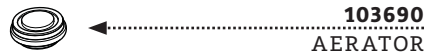
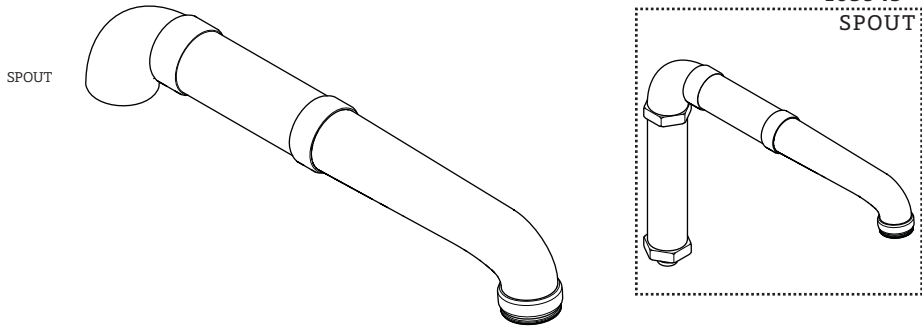

*FINISH/COLOR MUST BE SPECIFIED WHEN ORDERING
++SUPPLIED AS A PAIR

KIT COMPONENTS

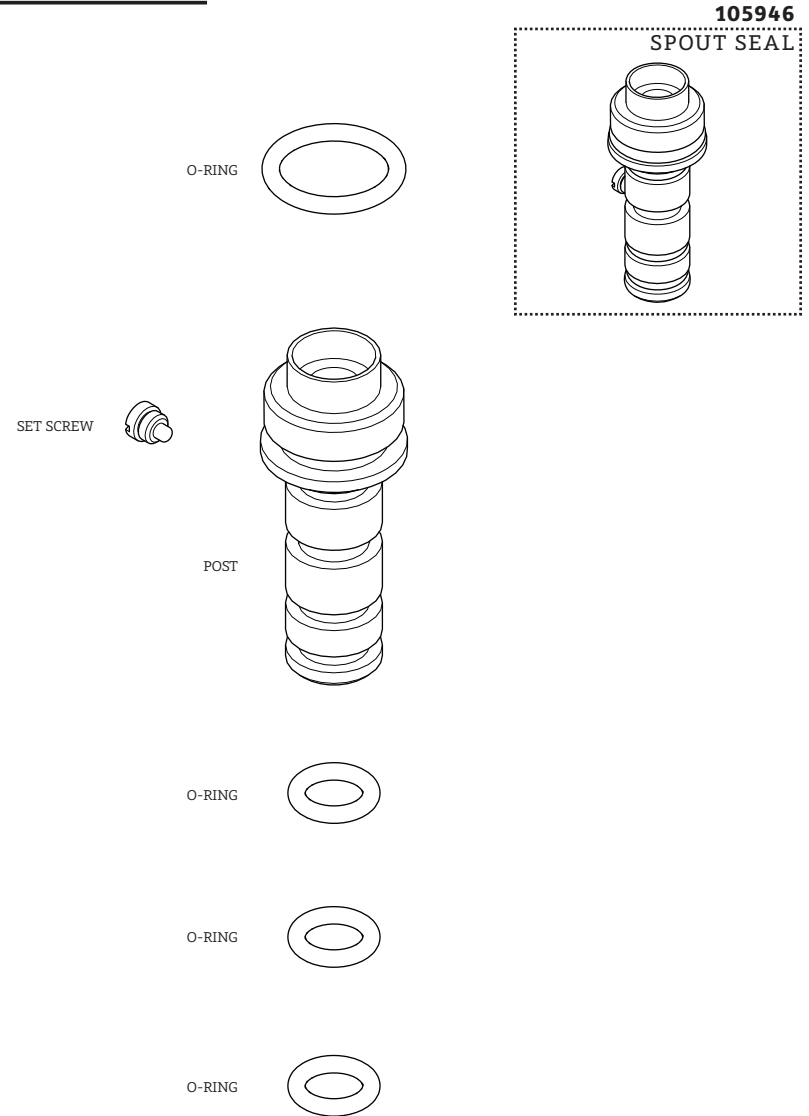



ESTB. 1978

WATERWORKS

KIT COMPONENTS

STYLES: RWKM10

105947

SPOUT SEAL

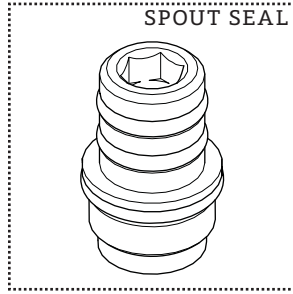

O-RING

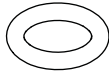

O-RING

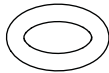

POST

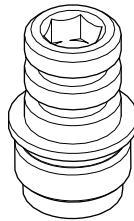

O-RING

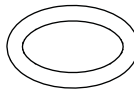

*FINISH/COLOR MUST BE SPECIFIED WHEN ORDERING
++SUPPLIED AS A PAIR

KIT COMPONENTS

103722*

ESCUTCHEON

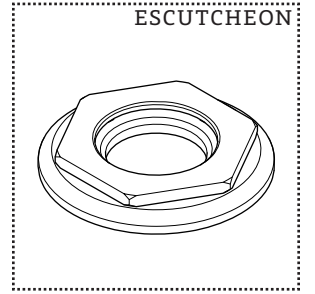

HEX COLLAR

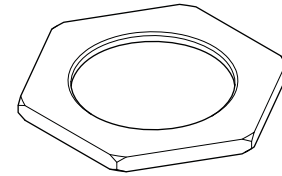

O-RING

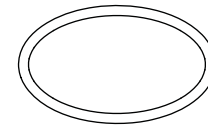

ESCUTCHEON

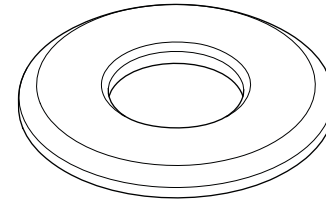

O-RING

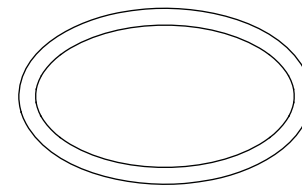



ESTB. 1978

WATERWORKS

KIT COMPONENTS

STYLES: RWKM10

103471

MOUNTING
HARDWARE

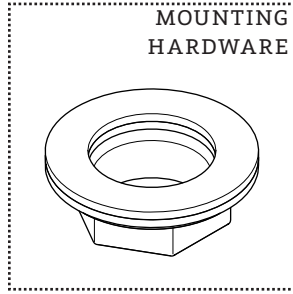

RUBBER WASHER

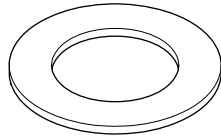

PLASTIC WASHER

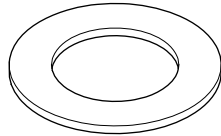

NUT

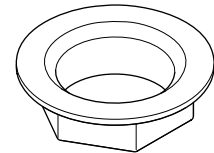

*FINISH/COLOR MUST BE SPECIFIED WHEN ORDERING
++SUPPLIED AS A PAIR

KIT COMPONENTS

103728*

SPRAY RETURN



COLLAR



SLEEVE

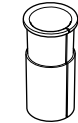

ALL THREAD TUBE



RING



HEX COLLAR



O-RING



ESCUTCHEON



O-RING



RUBBER WASHER



NUT





ESTB. 1978

WATERWORKS

KIT COMPONENTS

STYLES: RWKM10

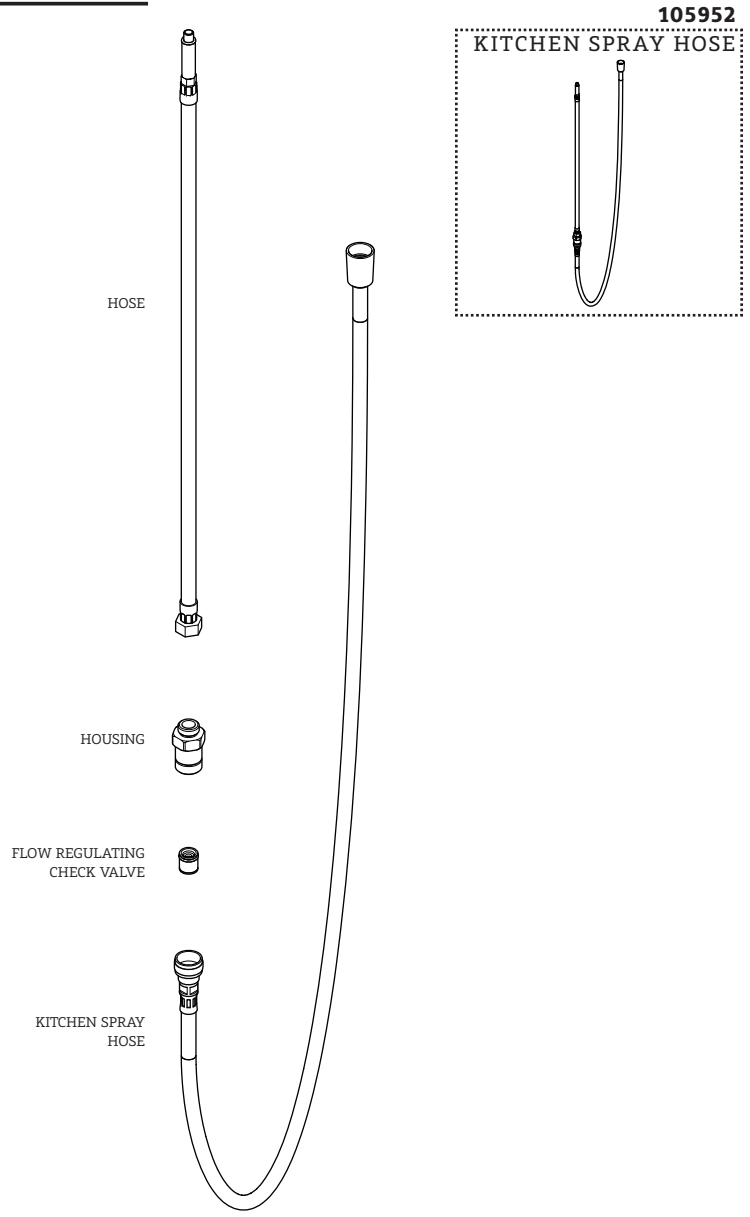

*FINISH/COLOR MUST BE SPECIFIED WHEN ORDERING
++SUPPLIED AS A PAIR

SERVICE PARTS INDEX

| <u>STYLE</u> | <u>DESCRIPTION</u> | <u>PG</u> |
|--------------|------------------------------------|-----------|
| 103703 | 3/8" CLOCKWISE ON CARTRIDGE | 3 |
| 103702 | 3/8" COUNTERCLOCKWISE ON CARTRIDGE | 2 |
| 103690 | AERATOR | 4 |
| 105948 | DIVERTER | 2 |
| 103722* | ESCUTCHEON | 7 |
| 105950 | HOSE | 2 |
| 105952 | KITCHEN SPRAY HOSE | 8 |
| 103704* | LEVER HANDLE | 3 |
| 103471 | MOUNTING HARDWARE | 8 |
| 105949 | SEAL KIT | 3 |
| 846041 | SEAL KIT | 4 |
| 105945* | SPOUT | 4 |
| 105947 | SPOUT SEAL | 6 |
| 105946 | SPOUT SEAL | 5 |
| 105951* | SPRAY | 3 |
| 103728* | SPRAY RETURN | 9 |

DOCUMENT: SPRW05_REV01



ESTB. 1978

WATERWORKS

NOTES

STYLES: RWKM10

*FINISH/COLOR MUST BE SPECIFIED WHEN ORDERING
++SUPPLIED AS A PAIR

NOTES



ESTB. 1978

WATERWORKS

PRODUCT SUPPORT

60 BACKUS AVENUE
DANBURY, CT 06810

1 (800) 927-2120 (EXT 2)

WWW.WATERWORKS.COM