

R.W. ATLAS

RWHS10

R.W. Atlas Handshower On Bar with Metal Handle



SHOWN IN R.W. ATLAS HANDSHOWER ON BAR WITH METAL HANDLE | RWHS10

TECHNICAL DETAILS

ADA Compliance: When installed per ADA guidelines
 Adjustable Versus Fixed Spray: Fixed Spray
 Depth/Width: 6 1/8"
 Diameter Of Head: 2 11/16"
 Escutcheon Primary Material: Brass
 Fittings Hole Diameter: 1"
 Flow Restriction Options: 2.5, 2.2, 2.0, 1.75, 1.5, 0.92
 Handshower Spray Hose Length: 59"
 Height: 24 3/4"
 Inlet Connection Size: 3/4"
 Inlet Connection Type: Copper Compression
 Installation Type: Wall Mounted
 Integrated Diverter: N
 Length: 3 1/2"
 Pivot: Y
 Primary Material: Brass
 Restricted Maximum Flow Rate: 1.75 gpm
 Suggested Application: Bath
 Water Pressure Maximum: 85.0 psi
 Water Pressure Minimum: 20.0 psi
 Water Pressure Recommended: 45.0 psi

INSPIRATION

Powerful shapes, genuine materials and unique aesthetic details. The original, impeccable vision of R.W. Atlas pairs American ingenuity with European craftsmanship.

CODES & STANDARDS

RWHS10-F.RX, ASME A112.18.1/CSA B125.1, Waterworks Handshowers use check valves compliant to ASME A112.18.3 for backflow protection. CEC, State of MA

PRODUCT FEATURES

Meets ADA requirements.

Adjustable handshower.

Utilizes the bottom mount as the water inlet, which is a 3/4" compression connection.

Stocked in 2.5gpm (9.5 L/min) and 1.75gpm (6.6 L/min). State of California requires 1.75gpm (6.6 L/min) to comply with their water conservation requirements. Other flow options are available to order, contact your sales associate or call 1 (800) 899-6757 for details.

CERTIFICATIONS



PRODUCT (NOTES)

R.W. Atlas Handshower On Bar with Metal Handle

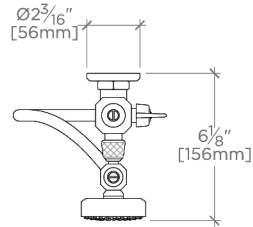

TOP VIEW SCALE: 1 1/2"=1'-0"

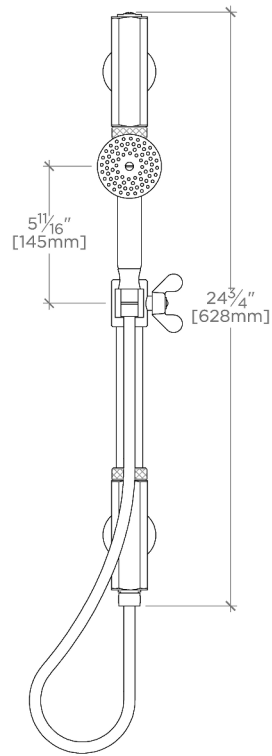

FRONT VIEW SCALE: 1 1/2"=1'-0"

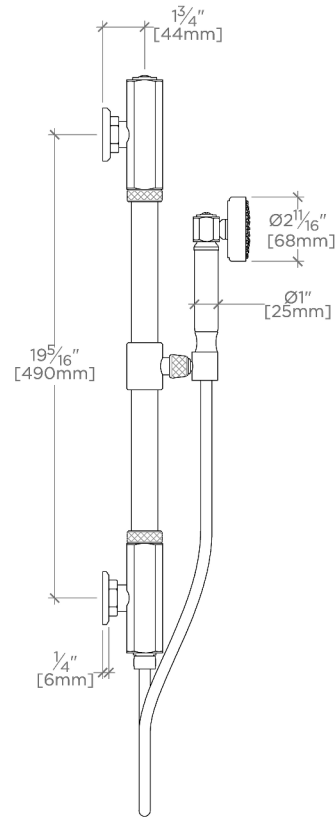

SIDE VIEW SCALE: 1 1/2"=1'-0"