

## Bond

BLS73S

Bond Rally Series Wall Mounted Lavatory Faucet with Knob Handles



SHOWN IN BOND RALLY SERIES WALL MOUNTED LAVATORY FAUCET WITH KNOB HANDLES | BLS73S

### TECHNICAL DETAILS

ADA Compliance: Yes  
 Drain Depth Maximum: 67 mm  
 Drain Depth Minimum: 10 mm  
 Drain Hole Diameter: 44 mm  
 Drain Style: Push Touch  
 Fittings Hole Diameter: 35 mm  
 Handle Spread Maximum: 203 mm  
 Handle Spread Minimum: 203 mm  
 Handle Turn Angle: Quarter Turn Each Way  
 Inlet Connection Size: 1/2"  
 Inlet Connection Type: Female NPT  
 Number Of Holes: Three Hole  
 Primary Material: Brass  
 Restricted Maximum Flow Rate: 4.5 liters/min  
 Spout Swivel: N  
 Water Pressure Maximum: 6.0 bar  
 Water Pressure Minimum: 1.5 bar  
 Water Pressure Recommended: 3.0 bar

### INSPIRATION

Bond draws inspiration from the Aesthetic Movement, rare vintage lighters, and modern industrial design. The result is a contemporary collection with a soulful quality that inhabits the full range of modern style, from austere minimalism to warm contemporary.

### CODES & STANDARDS

BLS73SX, NSF/ANSI/CAN 61:Q < 1, NSF/ANSI/CAN 372,  
 ASME A112.18.1/CSA B125.1, CEC, DOE, State of MA,  
 NOM-012, WRAS

### PRODUCT FEATURES

Knob Handles

Includes Universal Push-Touch Drain (UNLD23) which fits 1-1/2" through 1-3/4" drain hole openings

Features a Sport Black Finish, smooth and velvety to the touch

Stocked in Chrome/Sport Black

Available in 1.2gpm (4.5L/min) flow rate; Requires valve, sold separately: GULV25 (USA) or GU25LV (UK/International)

### CERTIFICATIONS



### PRODUCT (NOTES)

## Bond

BLS73S

Bond Rally Series Wall Mounted Lavatory Faucet with Knob Handles

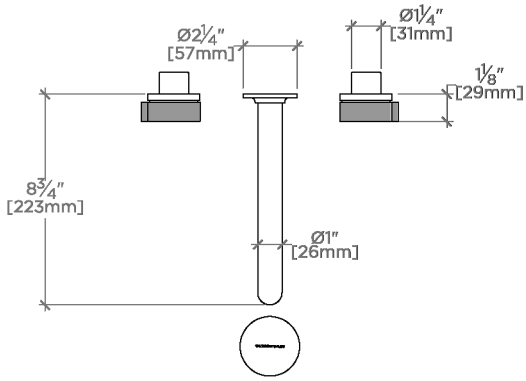

TOP VIEW

SCALE: 1/2"=1'-0"

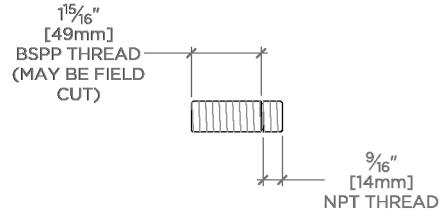

ADAPTER INCLUDED - INTERNATIONAL USE ONLY

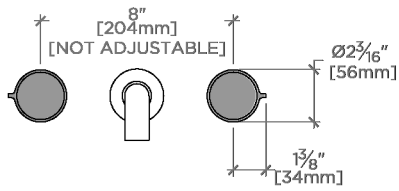

FRONT VIEW

SCALE: 1/2"=1'-0"

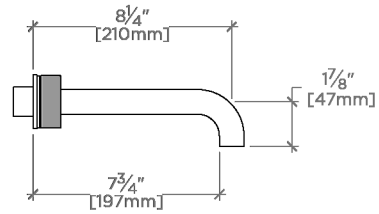

SIDE VIEW

SCALE: 1/2"=1'-0"

